

TOTTENHAM COURT ROAD

STEPHEN STREET

Do not scale. All dimensions to be confirmed on site. Information contained in this drawing is the sole copyright of Orms designers + architects ltd and is not to be reproduced without permission.

Key Plan:

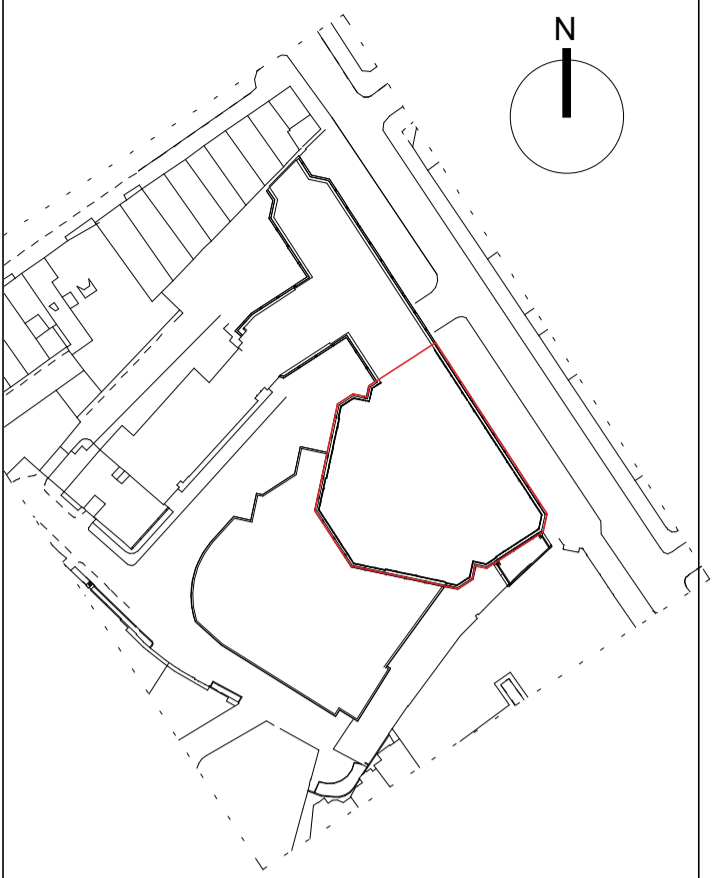

CDM risks relevant to this drawing:

Notes:



C01	23.02.28	Issued for Planning
P01	22.12.16	Issued for Planning Review
Rev.	Date	Description

Issued for:
A3 - PLANNING

Orms

1 Oliver's Yard
55-71 City Road
London
EC1Y 1HQ
0207 833 8533
orms@orms.co.uk
orms.co.uk

Project:
Stephen Street Second Floor

Drawing title:
Existing
Planning
Second Floor Plan

Scale@A1 Project No.
As indicated 2188

Drawing Number	Rev.
SS2-ORM-01-02-DR-A-12102	C01