

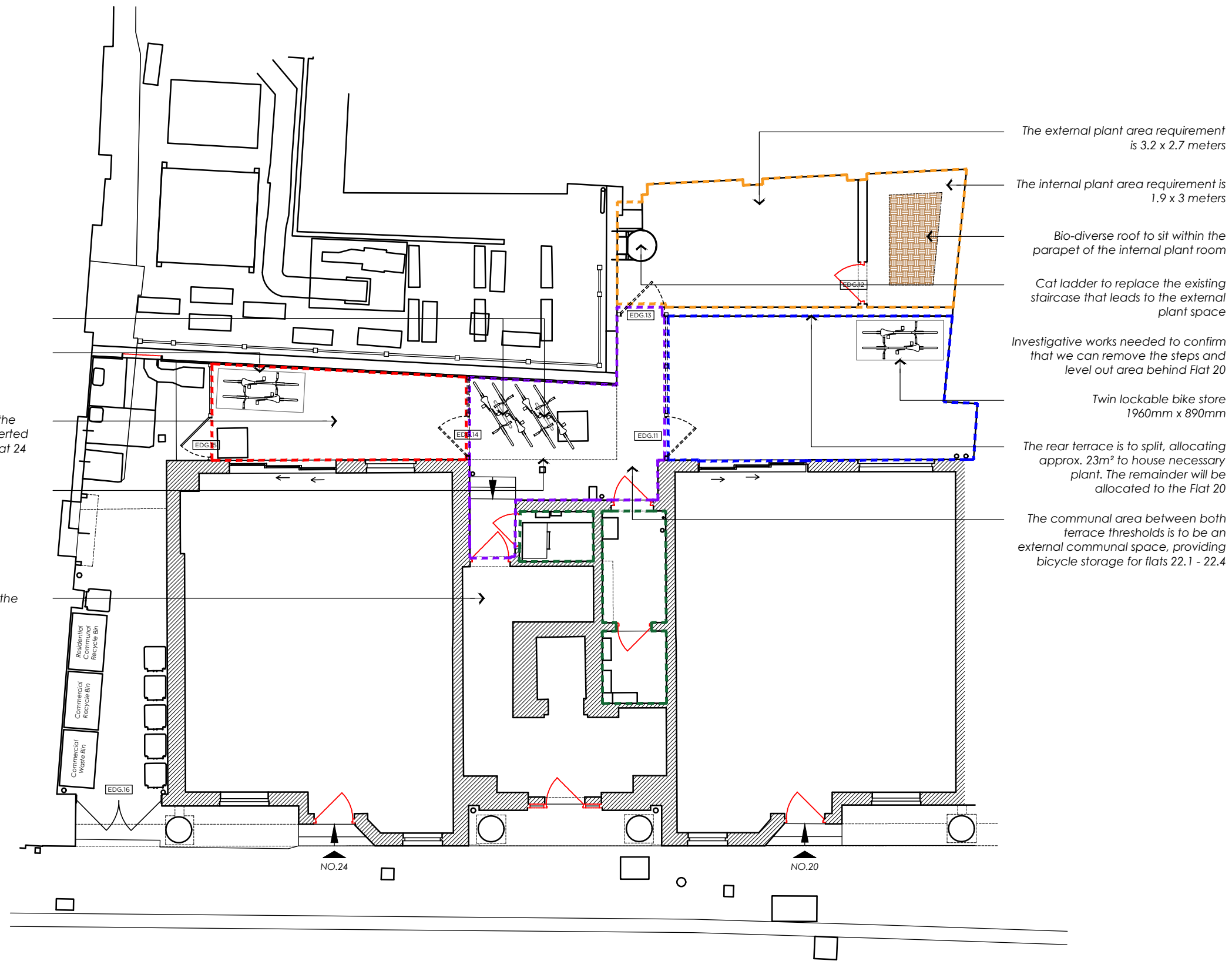

- - - FLAT 24 TERRACE
- - - FLAT 22 TERRACE
- - - COMMUNAL SPACE
- - - SERVICES AREA
- - - PLANT AREA



2no. sheffield bike stands

Twin lockable bike store  
1960mm x 890mm

The existing walkway leading to the rear terrace space is to be converted to a private garden terrace for flat 24

Overhead bike storage canopy

Plant area is to be accessed via the communal area

The external plant area requirement is 3.2 x 2.7 meters

The internal plant area requirement is 1.9 x 3 meters

Bio-diverse roof to sit within the parapet of the internal plant room

Cat ladder to replace the existing staircase that leads to the external plant space

Investigative works needed to confirm that we can remove the steps and level out area behind Flat 20

Twin lockable bike store  
1960mm x 890mm

The rear terrace is to split, allocating approx. 23m<sup>2</sup> to house necessary plant. The remainder will be allocated to the Flat 20

The communal area between both terrace thresholds is to be an external communal space, providing bicycle storage for flats 22.1 - 22.4

PL3 PLANNING ISSUE	21.02.23	TE
CN1 CONSTRUCTION ISSUE	27.01.23	TE
PL2 PLANNING ISSUE	21.10.22	TE
T2 TENDER ISSUE	11.10.22	TE
T1 TENDER ISSUE	02.09.22	TE
PL1 RE-ISSUE - PLANNING	14.07.22	TE
P3 PRELIMINARY ISSUE	05.07.22	TE
P2 PRELIMINARY ISSUE	24.06.22	TE
P1 PRELIMINARY ISSUE	08.06.22	TE

Rev	Revision	Date	By
-----	----------	------	----

NOTES

All setting out dimensions and points will be found on the construction issue drawings

All dimensions to be checked on site prior to commencement of works. Do not scale this drawing

## CONSTRUCTION

PROJECT	
RUSPINI HOUSE	
TITLE	
PROPOSED EXTERNAL SPACE GA PLAN	
SCALE	1:100 @ A3
DATE	24.06.22
DRAWING NO	601/GA/115
REVISION	PL3

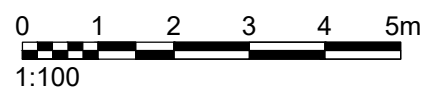

**GRAVITY DESIGN**

Old Bank Court, Morocco Street, London SE1 3HB  
+44(0)20 7089 9134 studio@gravitydesign.uk.com