

1 LEVEL 2 - CORE B
DEMOLITIONS 1:50

SCHEDULE OF DEMOLITION WORKS -

- FORM PENETRATIONS THROUGH WALLS AND SLABS TO SUIT SERVICES PROPOSAL
- MAKE GOOD PENETRATIONS THROUGH WALLS AND SLABS, REINSTATING ALL FIRE COMPARTMENTATION AND WEATHERPROOFING, AS APPROPRIATE.
- BREAK-OUT ROAD SURFACES AS APPROPRIATE FOR NEW BOLLARDS.

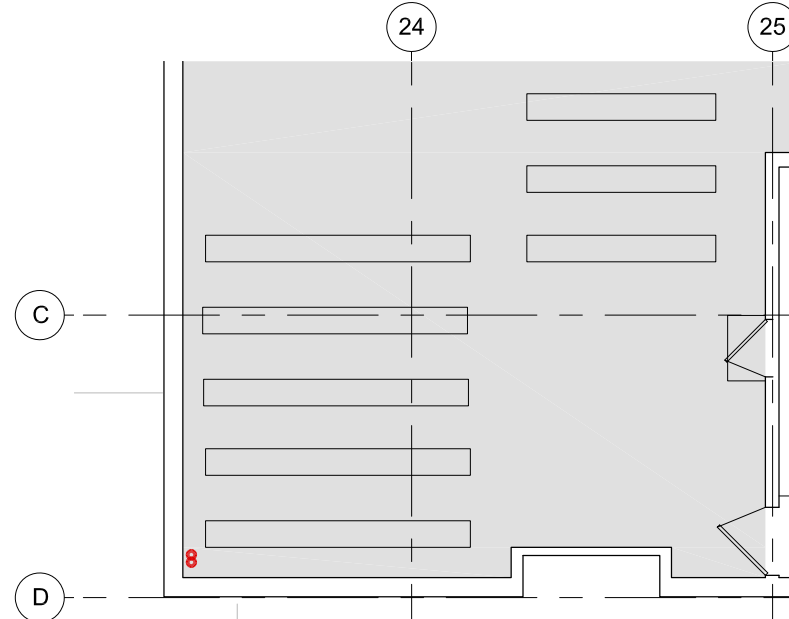

7 LEVEL 12 - CORE B
DEMOLITIONS 1:50

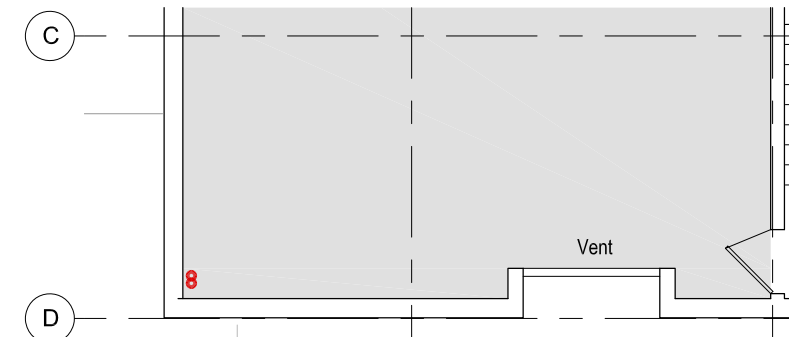

6 LEVEL 11 - CORE B
DEMOLITIONS 1:50

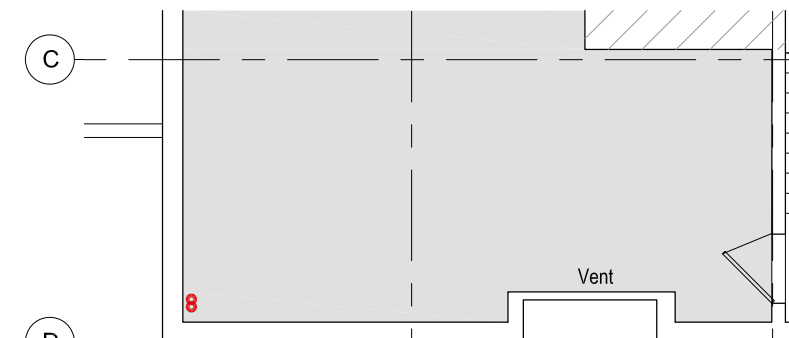

5 LEVELS 10-10.5 - CORE B
DEMOLITIONS 1:50



LEGEND

- INTERNAL AREAS OUTSIDE OF SCOPE
- WORKS IN THIS AREA SUBJECT TO SEPARATE APPLICATIONS FOR FULL PLANNING PERMISSION & LISTED BUILDING CONSENT

STRIP-OUT AND DEMOLITIONS

- 2no. 100mm DIA PENETRATIONS THROUGH WALL
- 2no. 75mm DIA PENETRATION THROUGH SLAB

GENERAL NOTES

ALL STRIP-OUT, DEMOLITION AND REMOVAL OF ASBESTOS-CONTAINING MATERIALS ARE TO BE CAREFULLY UNDERTAKEN AND CERTIFIED PRIOR TO ALL OTHER STRIP-OUT AND DEMOLITION WORKS.

DEMOLITIONS CONTRACTOR TO PROTECT ALL LISTED FEATURES DURING STRIP-OUT.

DEMOLITIONS CONTRACTOR TO CONSULT STRUCTURAL ENGINEER PRIOR TO UNDERTAKING ANY DEMOLITIONS WORKS TO (INCLUDING FORMING ANY PENETRATIONS THROUGH) EXISTING LOAD BEARING ELEMENTS.

ALL WORKS - INCLUDING DESIGN, SETTING-OUT, DETAILING, FIXTURES, FITTINGS AND FINISHES - ARE TO MATCH PHASE 1A & 1B WORKS, UNLESS AGREED OTHERWISE.

DRAWING TO BE READ IN CONJUNCTION WITH ALL CURRENT, AND RELEVANT, ARCHITON DRAWINGS, SCHEDULES AND SPECIFICATIONS.

ALL WORKS TO BE FULLY COORDINATED WITH M&E AND STRUCTURAL PROPOSALS, AS APPROPRIATE.

ALL SETTING-OUT INFORMATION TO BE CHECKED AGAINST SITE DIMENSIONS.

ALL WORKS TO BE IN ACCORDANCE WITH ALL STATUTORY REQUIREMENTS. WHERE AMENDED PROPOSALS DIFFER FROM THOSE APPROVED BY LA, NEW APPROVALS TO BE OBTAINED PRIOR TO COMMENCING WORKS.

FIRE RATED COMPONENTS TO BE IN ACCORDANCE WITH OVER-ARCHING FIRE STRATEGY FOR THE IOE.

PLANNING ISSUE

P1	Planning Issue for approval	16.01.2023
Rev	Description	Date

overbury Client

Job title
University College London
Institute of Education
Phase 2
20 Bedford Way, WC1H 0AL

Drawing title
Level 2-12 Core B
Demolition Plans
Planning Application 2E
Refueling & Dumping Station

Scale	Date	Drawn
1:50 @ A1	Nov 22	MJR

ARCHITON LLP
CHARTERED ARCHITECTS - DESIGN -
PLANNING CONSULTANTS - DEVELOPMENT -
BUILDING COST MANAGEMENT

REGENCY HOUSE
17 WEST STREET
EPSOM KT18 7RL
TEL:01372 745600
FAX:01372 745016
Email:info@architon.com

Drawing No	ARCHITON LLP certified to: BS EN ISO 9001 BS EN ISO 14001 IIP Accreditation
3147-P5-2202 P1	

