

4 LEVELS 5-9 - CORE B
PLAN - AS EXISTING 1:50

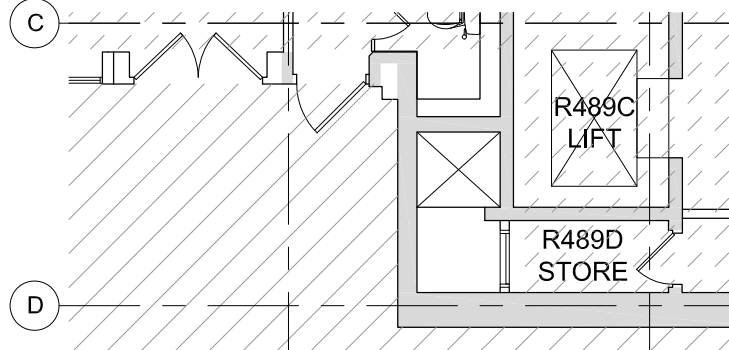

3 LEVEL 4 - CORE B
PLAN - AS EXISTING 1:50

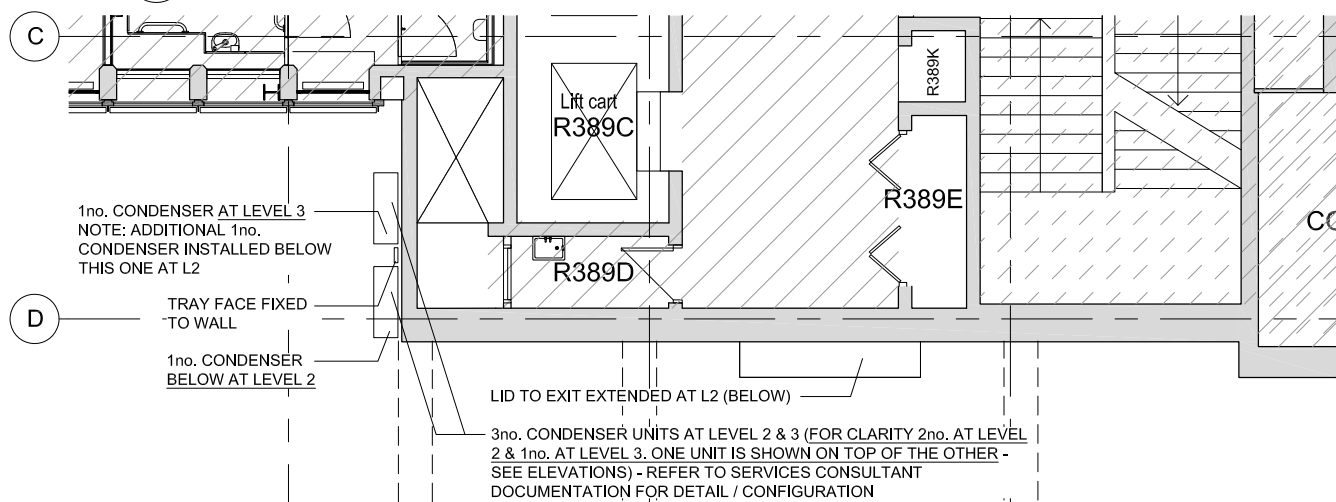

2 LEVEL 3 - CORE B
PLAN - AS EXISTING 1:50

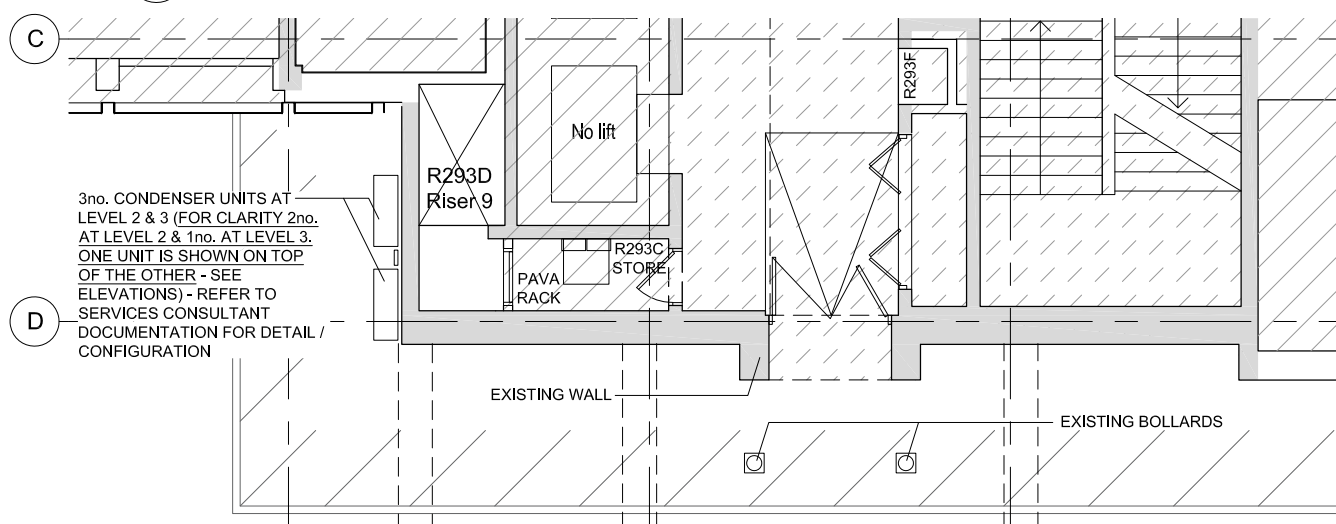

1 LEVEL 2 - CORE B
PLAN - AS EXISTING 1:50

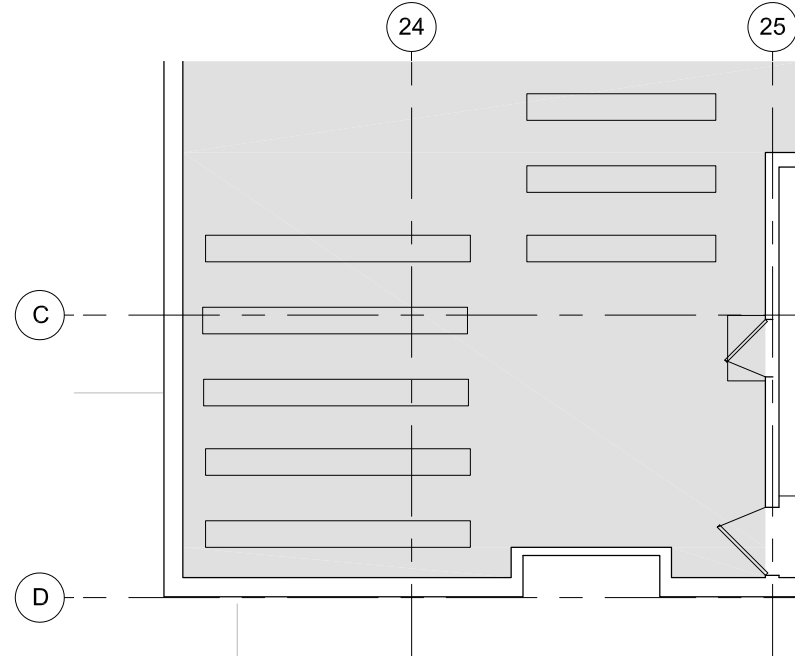

7 LEVEL 12 - CORE B
PLAN - AS EXISTING 1:50

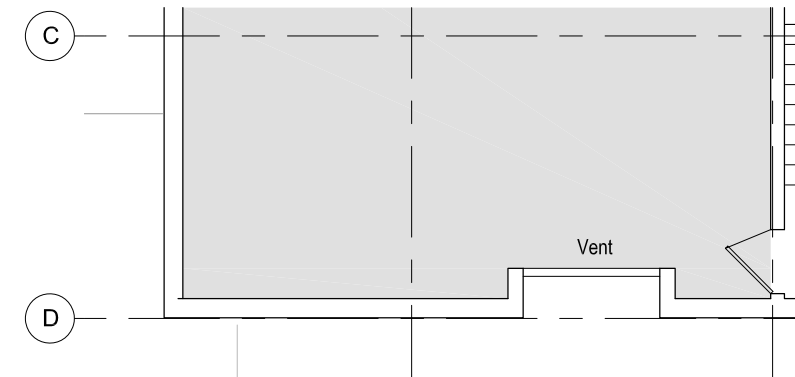

6 LEVEL 11 - CORE B
PLAN - AS EXISTING 1:50

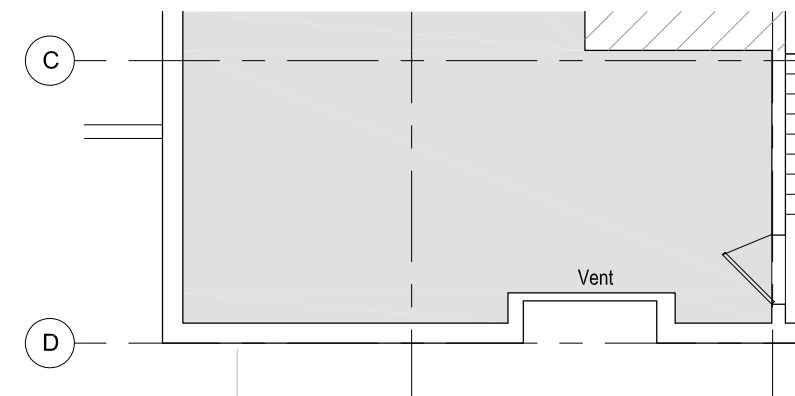

5 LEVELS 10-10.5 - CORE B
PLAN - AS EXISTING 1:50



LEGEND

INTERNAL AREAS OUTSIDE OF SCOPE

WORKS IN THIS AREA SUBJECT TO SEPARATE APPLICATIONS FOR FULL PLANNING PERMISSION & LISTED BUILDING CONSENT

© Architon LLP 2014

This drawing is the property of Architon LLP and must not be divulged to anyone, copied or reproduced, or used for marketing, advertising or promotional purposes without the express written permission of Architon LLP.

All dimensions are to be checked on site and not scaled from this drawing. Contractors must verify all dimensions on site before setting out, commencing work or preparing shop drawings. Any discrepancies on this drawing with other contract documentation to be reported immediately for clarification.

PLANNING ISSUE

P1	Planning Issue for approval	16.01.2023
Rev	Description	Date

overbury

Client

Job title

University College London
Institute of Education
Phase 2
20 Bedford Way, WC1H 0AL

Drawing title

Level 2-12 Core B
Plans - As Existing
Planning Application 2E
Refueling & Dumping Station

Scale	Date	Drawn
1:50 @ A1	Nov 22	MJR

ARCHITON LLP

CHARTERED ARCHITECTS · DESIGN ·
PLANNING CONSULTANTS · DEVELOPMENT ·
BUILDING COST MANAGEMENT

REGENCY HOUSE
17 WEST STREET
EPSOM KT18 7RL

TEL:01372 745600
FAX:01372 745016
Email:info@architon.com

Drawing No

3147-P5-2201 P1

ARCHITON LLP
certified to:
BS EN ISO 9001
BS EN ISO 14001
ITP Accreditation

