

DEMOLITION NOTES:

GENERAL

To be read in conjunction with Structural Engineer and M&E Engineers specification and drawings. Removal of any structural, mechanical or electrical items should only be carried out following investigation as outlined by SE / M&E specifications and following direct instruction by the project manager.

OFFICES

Internal Walls - All secondary tenant partitions and screens indicated in red to be stripped out.
Walls indicated with red dashed lines to be removed.
Skirting boards to all walls to be carefully removed
Windows - All existing blinds to be removed, secondary glazing to be removed

Columns - Existing boxing out and finishes to columns to be stripped back to bare structure, existing ornate capitals to metal columns to be retained and protected.

Ceilings - All MF ceiling, ceiling tiles, suspended ceiling framework, associated fixings and light fittings to be stripped out back to historic fabric.

Light Fittings and CCTV - All existing light fittings to be removed.

All existing CCTV cameras to be removed.

Furniture - All remaining tenant furniture, seating, tea points, storage and desks to be stripped out.

Floors - All existing floor finishes, raised floor tiles and pedestals to be stripped out back to slab level.

Allow for existing screed to be removed to all office floors, subject to further structural investigation

WC's

All existing sanitaryware, vanity units and associated pipework to be removed.

All existing cistern housings / IPS access panels to be removed.

All existing cubicle doors and separating walls to be stripped out.

All ceilings, lighting, wall finishes to be stripped out back to bare structure.

All existing floor finishes, raised floors and screed to be stripped out back to structural slab level.

21 SOUTHAMPTON ROW STAIRS & LOBBY

Stairs
Existing stair to be removed entirely in line with Structural Engineers information.

Lobby
All existing floor finishes, and screed to lobby area to be stripped out back to slab level.

Allow for the slab to be removed to allow for construction of new stair core

VERNON & SICILIAN HOUSE STAIRS & LOBBY

Stairs
Existing terrazzo finishes to main stair to be retained and protected throughout construction.

Existing handrails to be removed entirely throughout the staircase.

Existing cladding to be removed from the lift enclosure and existing lift cars / running gear to be removed. PLEASE NOTE THAT ASBESTOS HAS BEEN CONFIRMED WITHIN THESE LIFT ENCLOSURES.

Allow for the existing concrete stair from 4th to 5th floors to be retained and repaired as required.

Lobby
All existing floor finishes, and screed to lobby area to be stripped out back to slab level.

All existing doors and frames stripped out.

SERVICES - (Works to be undertaken in accordance with M&E requirements)

Fire Alarms
All existing fire alarms to be disconnected and removed.

Office areas
All existing radiators and wall mounted heating to be removed.

All existing heating/cooling units to be removed
All ductwork and cabling to be removed

All above ceiling services, ductwork and cabling to be removed

Risers and riser doors to be removed as indicated.

WC's and Lobby areas
All existing radiators and wall mounted heating to be removed

Indicates original fabric to be demolished. Refer to structural engineers information for extent of structural alterations to indicated areas

Indicates non original non structural partitions to be removed

Indicates non structural elements that need to be removed / demolished

Indicates areas of structural openings to be carefully created within existing slabs in line with approved risk assessment and approved method statements

Indicates areas of internal screed / finishes to be stripped back to bare structure in line with approved risk assessment and approved method statements

Indicates areas of external floor finishes to be stripped back in line with approved risk assessment and approved method statements

Indicates areas where internal screed to be retained, areas will have reduced floor void with new raised access floor

Schedule of Works Key:		13	01.102.13 - Existing non loadbearing masonry walls to be demolished in accordance with structural engineers specification
to be read in conjunction with schedule 383(SL) Listed Building Consent Schedule of Works, section 01, sheet 102		14	01.102.14 - Existing structural steel column to be retained and protected throughout works
01	01.102.01 - Existing windows to Southampton Row to be retained, existing paintwork to be stripped back ready for redecoration, plus existing secondary glazing to be removed	15	01.102.15 - Existing feature round steel columns to be retained and protected throughout works
02	01.102.02 - Existing windows to Sicilian Avenue to be retained, existing paintwork to be stripped back ready for redecoration, plus existing secondary glazing to be removed	16	01.102.16 - Existing windows to Vernon/Sicilian House Core lightwell to be removed from existing structural openings
03	01.102.03 - Existing non original fire escape door and window to be removed from existing structural openings	17	01.102.17 - Existing structural opening to Vernon House core lightwell window to be enlarged to form new service riser with double doors and new penetrations formed through wall at high level for new ductwork routes
04	01.102.04 - Existing window to existing fire escape to be removed from existing structural opening	18	01.102.18 - Existing structural opening to Vernon House core lightwell window to be enlarged to form new doorway into new WC core, lintel to structural engineer specification
05	01.102.05 - Existing windows to rear elevation of 21 Southampton Row to be retained; strip out existing painting and get ready for redecoration	19	01.102.19 - Existing terrazzo stair to be retained and protected throughout works
06	01.102.06 - Existing window to previously infilled stairwell to be retained in existing structural opening	20	01.102.20 - Lift car and associated services to be removed entirely, shaft wall linings to be removed completely back to structure which is to be retained.
07	01.102.07 - Existing windows to rear elevation of Vernon + Sicilian House to be retained; strip out existing painting and get ready for redecoration	21	01.102.21 - Non original blockwork riser enclosures to be demolished entirely
08	01.102.08 - Existing windows to rear elevation of Vernon/Sicilian House cores to be retained; strip out existing painting and get ready for redecoration	22	01.102.22 - Existing wc core to Sicilian House core to be removed entirely including all plasterboard / blockwork partitions, all sanitaryware and associated services stripped back
09	01.102.09 - Existing areas of screed to be removed back down to original structural slab level	23	01.102.23 - Non original partitions forming services risers to be demolished entirely
10	01.102.10 - New penetrations formed through existing slabs to provide new service riser, to be developed in accordance with structural engineers specification	24	01.102.24 - Existing timber stair to 21 Southampton Row core to be removed entirely
11	01.102.11 - New penetration formed through existing slabs to provide new central staircase, to be developed in accordance with structural engineers specification	25	01.102.25 - Lift car and associated services to be removed entirely, shaft wall linings and structure to be removed completely.
12	01.102.12 - Existing loadbearing masonry spine walls to be demolished in accordance with structural engineers specification	26	01.102.26 - Non original blockwork partitions to be removed

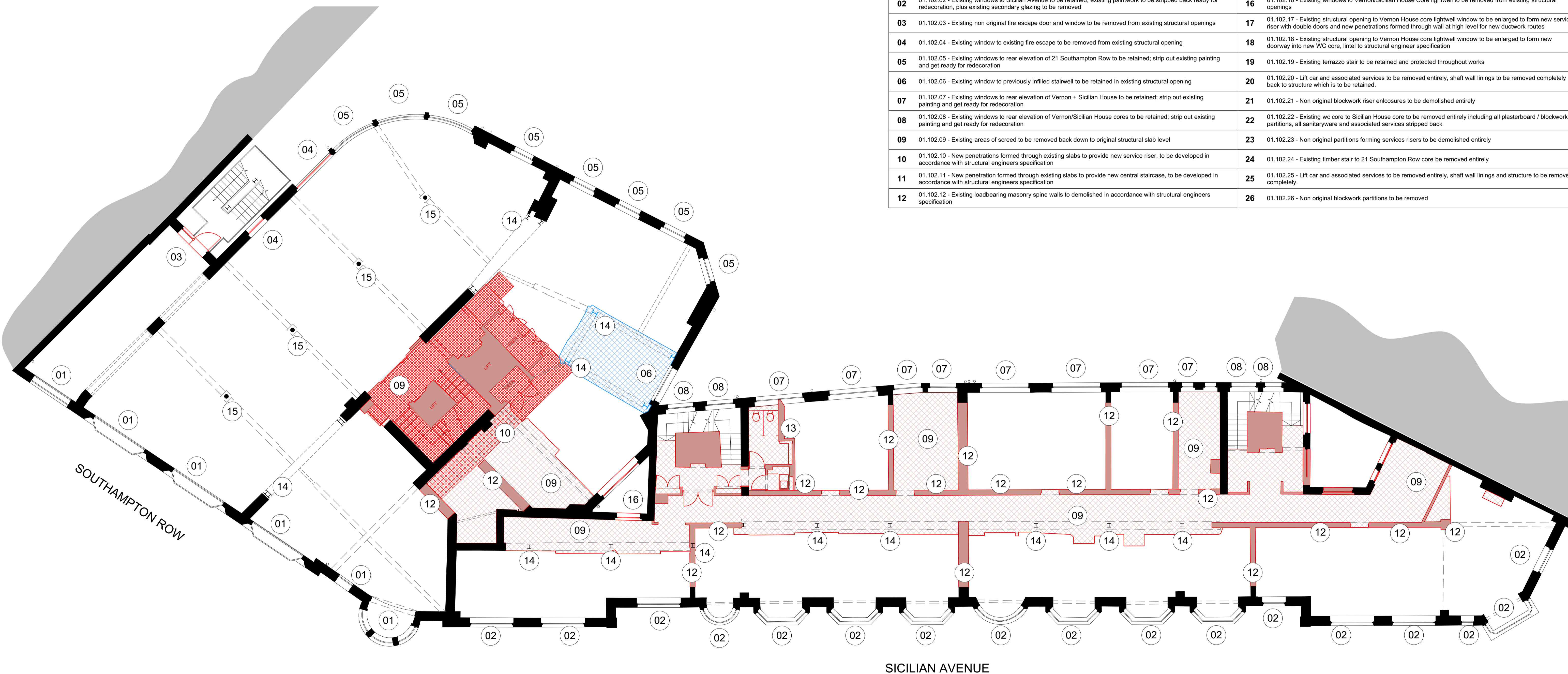

1 Second Floor Demolition Plan
Scale: 1:100

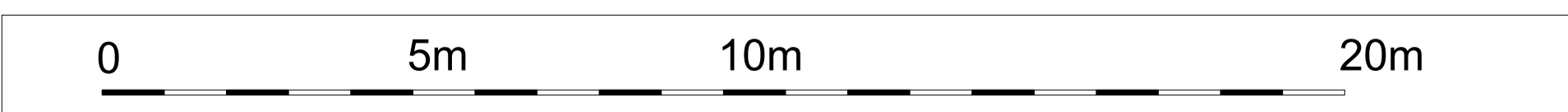

<p>All dimensions to be checked on site prior to commencement of any works, and/or preparation of any shop drawings.</p> <p>Sizes of and dimensions to any structural or services elements are indicative only. See structural and service engineers drawings for actual sizes / dimensions.</p> <p>This drawing is to be read in conjunction with all other Architect's drawings, specifications and other Consultants' information.</p> <p>All proprietary systems shown on this drawing are to be installed strictly in accordance with the Manufacturers/Suppliers recommended details.</p> <p>Any discrepancies between information shown on this drawing and any other contract information or manufacturers/suppliers recommendations is to be brought to the attention of the Architect.</p>	<p>Revision PL-1 22/07/2022 Issued for Planning</p> <p>Revision PL-2 01/03/2023 Revisions as per agreed amendments</p>	<p>Date May 2022</p> <p>Scale 1:100 @A1</p> <p>Status PLANNING</p> <p>Hale Brown Architects Ltd. Unit 1.04, Edinburgh House, 170 Kennington Lane, London, SE11 5DP T: 020 3735 7442</p>	<p>Project Vernon, Sicilian Hse/21 Southampton Row</p> <p>Title Second Floor Demolition Plan</p> <p>Client Ref EDR 383 (DE) 102</p> <p>Drwg. no. 383 (DE) 102</p> <p>Rev. PL-2</p> <p>Rev. Ref. 383</p>	<p>halebrown architects</p>
--	--	---	---	-----------------------------