

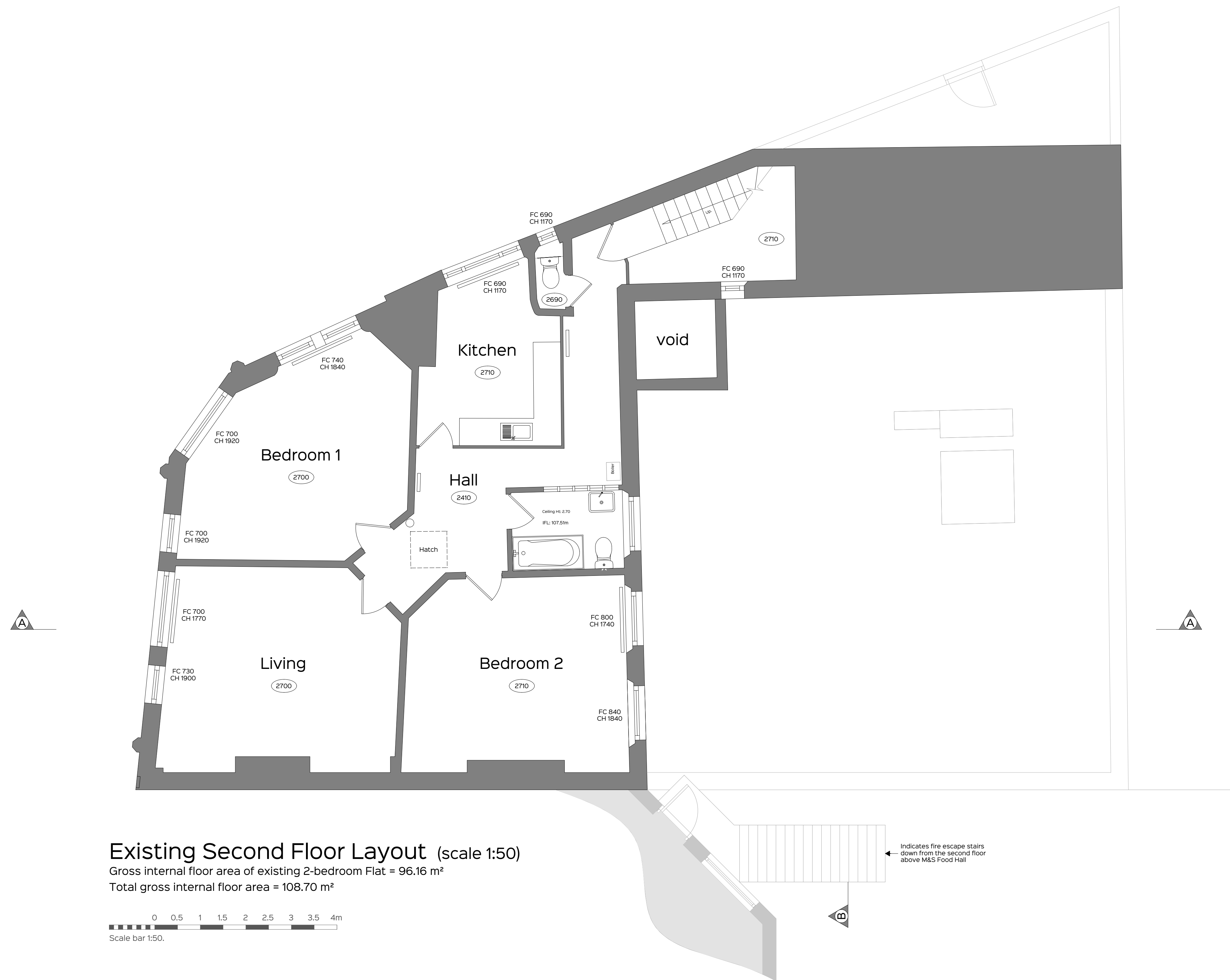

Any discrepancies or proposed alterations to be notified to the designers and further instructions obtained prior to the commencement of work. For critical dimensions, use figured dimensions only do not scale. All dimensions and levels to be verified on site prior to work commencing.

DATE:	REV:	DRAWN:	NOTE:
22.09.22	A	NMB	Courtyard and AAC plant indicated and gross internal floor areas noted



THE ADIL GROUP
ESTABLISHED 1969

CLIENT: The Adil Group			
PROJECT: Extensions to Form Additional Residential Apartments			
SITE LOCATION: 70-72 Kilburn High Road, London, NW6 4HS			
DRAWING: Existing Second Floor Plan			
DATE: June 2022	SIZE: A1	SCALE: 1:50	
DRAWING NUMBER: 22 / 017 / A / 22	REV: A	STATUS: PLANNING	
DRAWN BY: DJK	CHECKED BY: NMB	© COPYRIGHT RESERVED	



SRA ARCHITECTURE LTD.
THE QUAYS, BURTON WATERS
LINCOLN, LN1 2XG
t: 01522 59 69 39
e: design@sra-architecture.co.uk
w: www.sra-architecture.co.uk
Registered in England No. 05325004

Survey information provided by
iG Surveys Ltd.

This plan should only be used for its original purpose. iG Surveys accepts no responsibility for this plan if supplied to any party other than the original client.

All dimensions should be checked on site prior to design and construction.

Drainage information (where applicable) has been visually inspected from the surface and therefore should be treated as approximate only.