

EXISTING FOUNDATION AND SOIL DETAILS TAKEN FROM FASTRACK GROUP SITE INVESTIGATION REF SI REPORT 24157 5016334 FOR 2-3 CHARRINGTON STREET

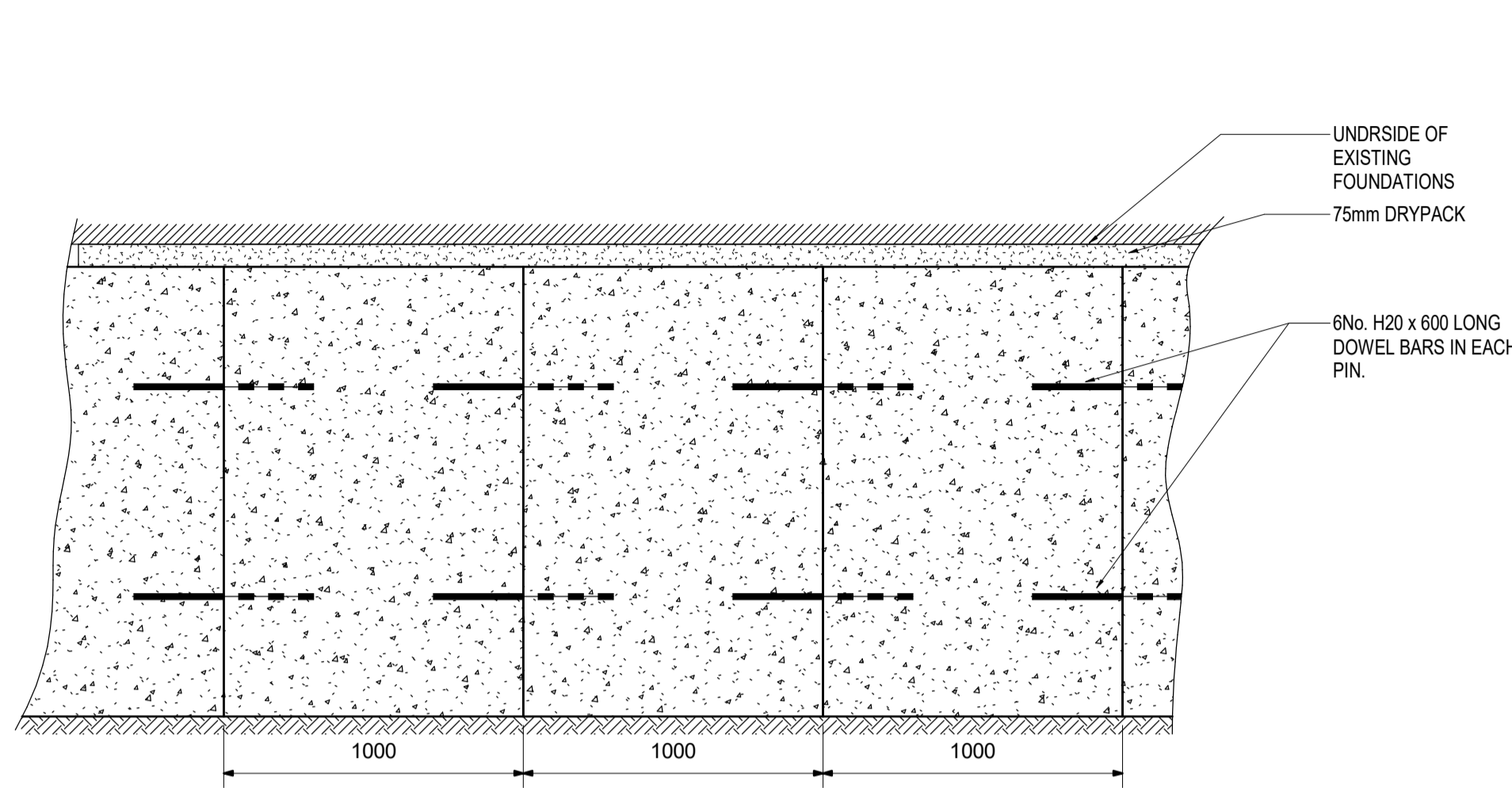

ELEVATION(TYPICAL)
1 : 20

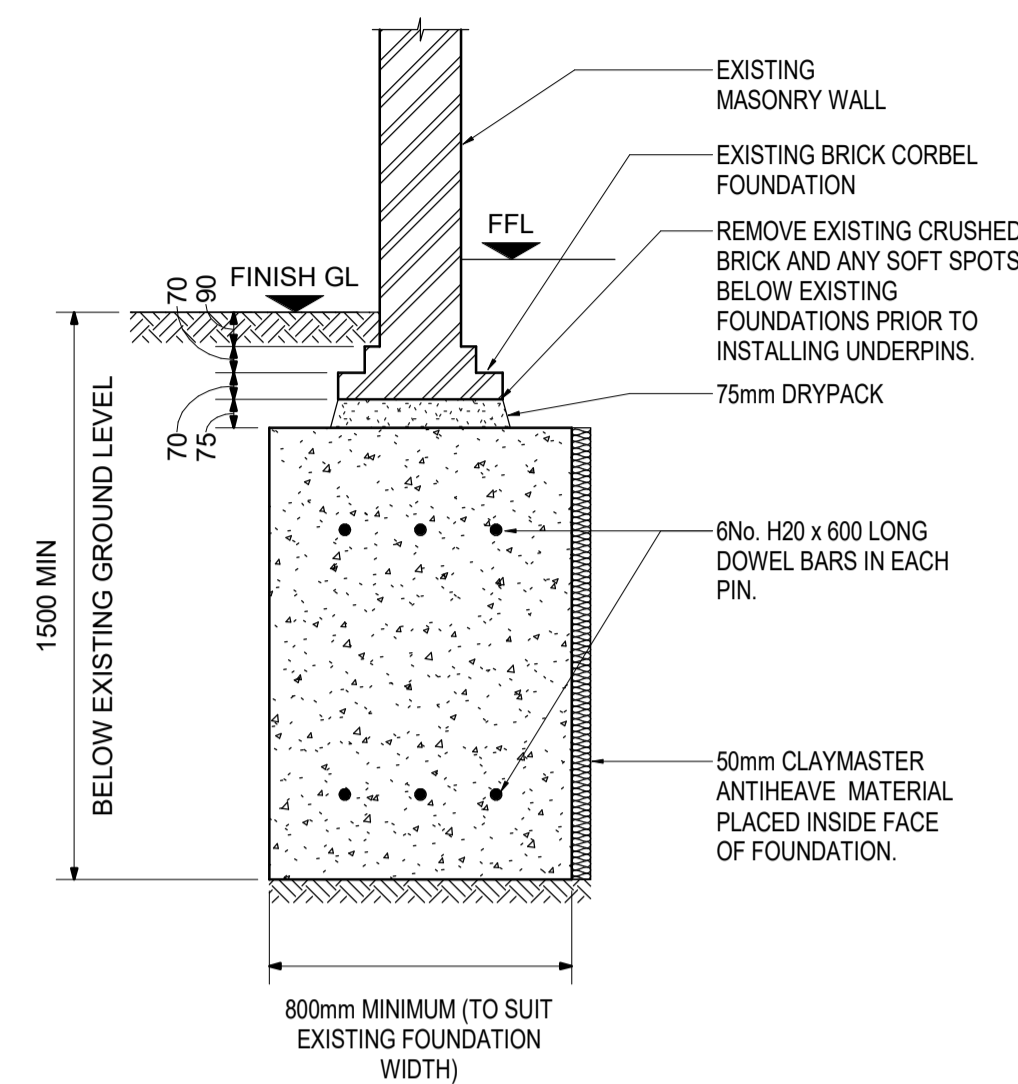

SECTION 1
1 : 20

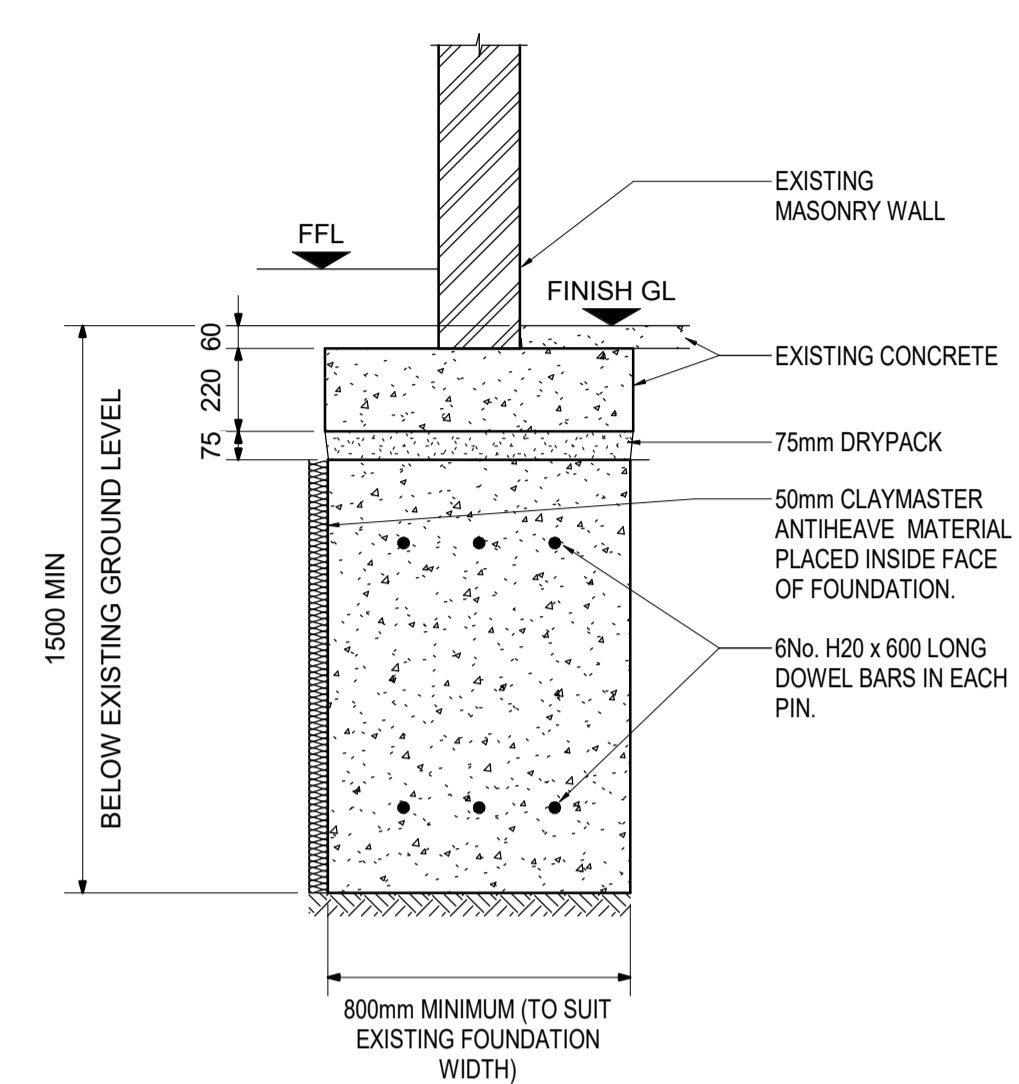

SECTION 3
1 : 20

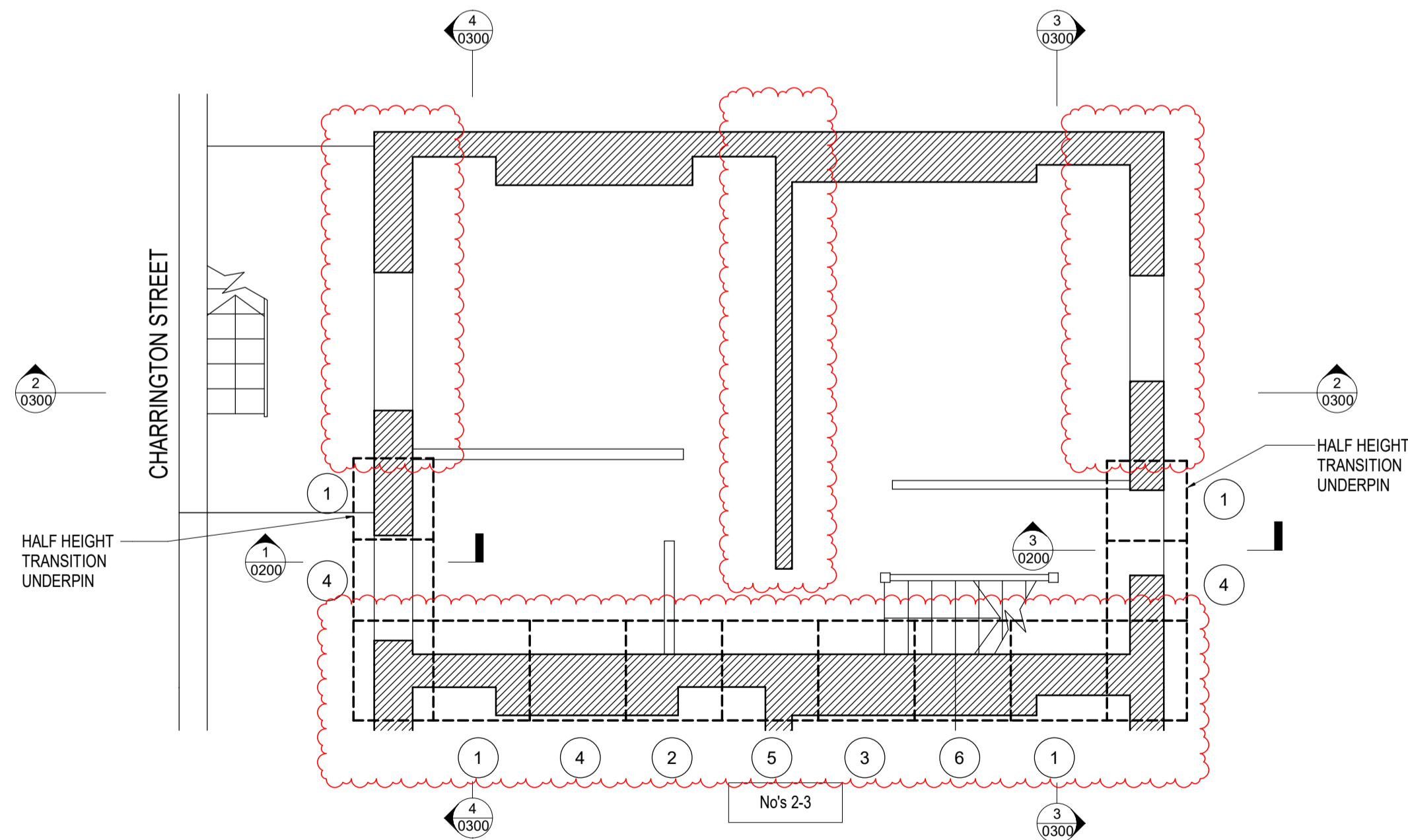
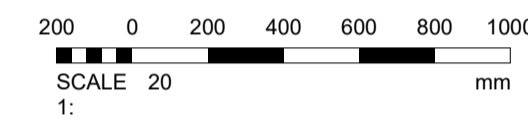

No 4 & 5 BASEMENT PLAN SHOWING SEQUENCE OF UNDERPINNING

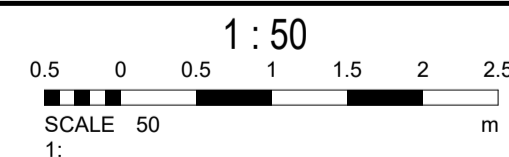

SEQUENCE OF OPERATIONS FOR INSTALLATION OF CONCRETE UNDERPINS

- SEQUENCE ASSUMES UNDERPIN No.1 IS CAST, DRY PACKED AND BACKFILLED BEFORE No.2 IS EXCAVATED AND SO ON IN ACCORDANCE WITH THE SPECIFICATION.
- CORNER UNDERPINS ARE NOT TO BE FORMED UNTIL ADJACENT UNDERPINS ARE FORMED
- UNDERPINNING TO BE SEQUENCED TO ALLOW NEWLY FORMED UNDERPINS TO HAVE REACHED THEIR REQUIRED STRENGTH BEFORE ADJACENT UNDERPINS ARE FORMED IN ACCORDANCE WITH THE SPECIFICATION.
- CONCRETE UNDERPINNING TO BE CARRIED OUT IN MAXIMUM BAY LENGTHS OF 1000mm, AS SHOWN ON NUMBERED SEQUENCE. (TO BE CONFIRMED SUBJECT TO SITE CONDITIONS)
- THE ENGINEER AND BUILDING INSPECTOR ARE TO BE NOTIFIED WHEN EXCAVATIONS ARE READY TO RECEIVE CONCRETE AND THE APPROVAL OBTAINED BEFORE CONCRETE IS PLACED.
- THE EXCAVATIONS ARE TO BE KEPT DRY AT ALL TIMES AND THE BOTTOM IS TO BE BOTTOMED OUT IMMEDIATELY BEFORE CONCRETE IS PLACED.
- THE CONCRETE IS TO BE GRADE 25 REF BS8110 AND HAVE CLASS TO SULPHATE RESISTANCE AS DEFINED IN BRE DIGEST No.363.
- THE CONCRETE IS TO BE PLACED TO WITHIN 75mm OF THE UNDERSIDE OF THE EXISTING FOUNDATION. AFTER 24 HOURS THE GAP IS TO BE PACKED AND WELL RAMMED WITH 1:3 SULPHATE RESISTING CEMENT TO SHARP SAND MIXED WITH MINIMAL WATER AND LEFT FOR 24 HOURS BEFORE COMMENCING EXCAVATION ON THE NEXT BAY IN THE SEQUENCE.
- WORKS TO BE COMPLETED BY AN EXPERIENCED, COMPETENT CONTRACTOR.

DISCLAIMER NOTES:

- THIS DOCUMENT IS COPYRIGHT OF THE ORIGINATOR AND MUST BE TREATED AS CONFIDENTIAL.
- THIS DOCUMENT MUST NOT BE ALTERED, REPRODUCED OR DISTRIBUTED WITHOUT PRIOR WRITTEN CONSENT OF THE ORIGINATOR
- THIS DOCUMENT MUST NOT BE ALTERED - THE ORIGINATOR ACCEPTS NO RESPONSIBILITY FOR ANY DISCREPANCIES ARISING AS A RESULT OF THE ORIGINATORS INFORMATION BEING ALTERED BY OTHERS
- ANY DISCREPANCY MUST BE REPORTED TO THE ORIGINATOR
- DO NOT SCALE THIS DOCUMENT - USE FIGURED DIMENSIONS ONLY
- ALL DIMENSIONS MUST BE CHECKED ON SITE PRIOR TO COMMENCEMENT OF ANY RELATED WORKS
- THIS DOCUMENT MUST BE READ IN CONJUNCTION WITH ALL SUPPORTING DOCUMENTS PRODUCED BY THE ORIGINATOR AND OTHER PROJECT DISCIPLINES
- THE ORIGINATOR ACCEPTS NO RESPONSIBILITY FOR THE ACCURACY OF BACKGROUND INFORMATION PRODUCED BY THIRD PARTIES - THIS MUST BE TREATED AS INDICATIVE ONLY
- USERS OF THIS DOCUMENT ARE RESPONSIBLE FOR CHECKING WHICH REVISION IS CURRENT
- THE DOCUMENT STATUS "INFORMATION" OR "PRELIMINARY", INDICATES THAT THIS DRAWING IS FOR REFERENCE PURPOSES ONLY - THE ORIGINATOR WILL ACCEPT NO RESPONSIBILITY FOR THE COMPLETENESS OF INFORMATION UNDER THIS STATUS
- THE DOCUMENT STATUS "RECORD" OR "AS BUILT" HAS BEEN PREPARED, IN PART, BASED UPON INFORMATION FURNISHED BY OTHERS. WHILE THIS INFORMATION IS BELIEVED TO BE RELIABLE, THE ORIGINATOR ASSUMES NO RESPONSIBILITY FOR THE ACCURACY OF THIS "RECORD" OR "AS BUILT" DOCUMENT OR FOR ANY ERRORS OR OMISSIONS THAT MAY HAVE BEEN INCORPORATED INTO IT AS A RESULT OF INCORRECT INFORMATION PROVIDED TO THE ORIGINATOR. THOSE RELYING ON THE "RECORD" OR "AS BUILT" DOCUMENT ARE ADVISED TO OBTAIN INDEPENDENT VERIFICATION OF ITS ACCURACY

DRAWING NOTES:

- CDM REGULATIONS 2015 SIGNIFICANT OR NON-OBVIOUS RISKS AND RISKS WHICH ARE DIFFICULT TO MANAGE ARE IDENTIFIED ON THIS DRAWING USING THE FOLLOWING SYMBOL IDENTIFIED TO THE RIGHT WITH BRIEF ACCOMPANYING TEXT. FOR FURTHER DETAILS OF THE RISKS IDENTIFIED BY DESIGNERS, REFERENCE SHOULD BE MADE TO CDM HAZARD REGISTER.

T4 PART UNDERPINNING REMOVED, SECTION 2 OMITTED	02/03/23	HB	DP
T3 UNDERPINNING SECTIONS REVISED/ADDED FOLLOWING SI REPORT	27/04/22	HB	ME
T2 FOR TENDER, SECTION REF. ADDED	31/01/22	HB	ME
T1 FOR TENDER	20/12/21	HB	ME
REV/ DESCRIPTION	DATE	BY	CHKD

ORIGINATOR:

RIDGE
PROPERTY & CONSTRUCTION CONSULTANTS

3 VALENTINE PLACE LONDON SE1 8QH TEL: 020 7593 3400 WWW.RIDGE.CO.UK

CLIENT:
LONDON BOROUGH OF CAMDEN

IN ASSOCIATION WITH:
JGPS

PROJECT:
4 & 5 CHARRINGTON STREET LONDON NW1 1RS

TITLE:
UNDERPINNING DETAILS

DRAWN BY: HB SCALE: As indicated @ A1
CHECKED BY: ME DATE: 16/12/21

STATUS:
PROPOSED DWG FOR TENDER

DRAWING No:
PROJECT: 5016334 ORG: RDG ZONE: XX LEVEL: XX TYPE: DT ROLE: S NUMBER: 0200 REV: T4