

**Stems:** 1

**Location:** London Zoo

**Site:** LZ 29 - Car Park (Prince Albert Road)

**Position:** LZ02021

**Species:** Acer platanoides ( Norway Maple)

**Owner:** The Royal Parks

**Grid Ref:** 528525.88, 183586.84



Hazard beam

**Inspection Only: 28/02/2023**

**Height:** 7-14 metres

**Age:** Mature

**Trunk:** 660 mm

**Spread:** Over 12 meters

**Features:**

**Conditions:** Deadwood - 4m north and scattered throughout. potential to affect parking bays. present in tree for a while now so assumed at increased risk of failure  
Hazard beam - large limb over car park from 2.5 metres south displays symptoms of high stress loading potentially exacerbated by kinked form and proximal branch removal wound, which is likely to harbour some decay. wider crown displays symptoms of functional unit decline seen as dead whole limbs

**Priority:** 1 - Very high

**Visited By: AC**

**Failure:** Probable/Soon

**Target:** Very High

**Impact:** Medium 35-10

**Authority:** Camden

**Recommendations:** Reduce branch as specified - reduce large kinked limb over car park from 2.5 metres south by 2 metres height and spread. reduce other limbs south side of crown that project above car park by 1.5 to 2 metres.  
Remove deadwood

**Works:**

**Comments:** Complete work by 28/03/2023.

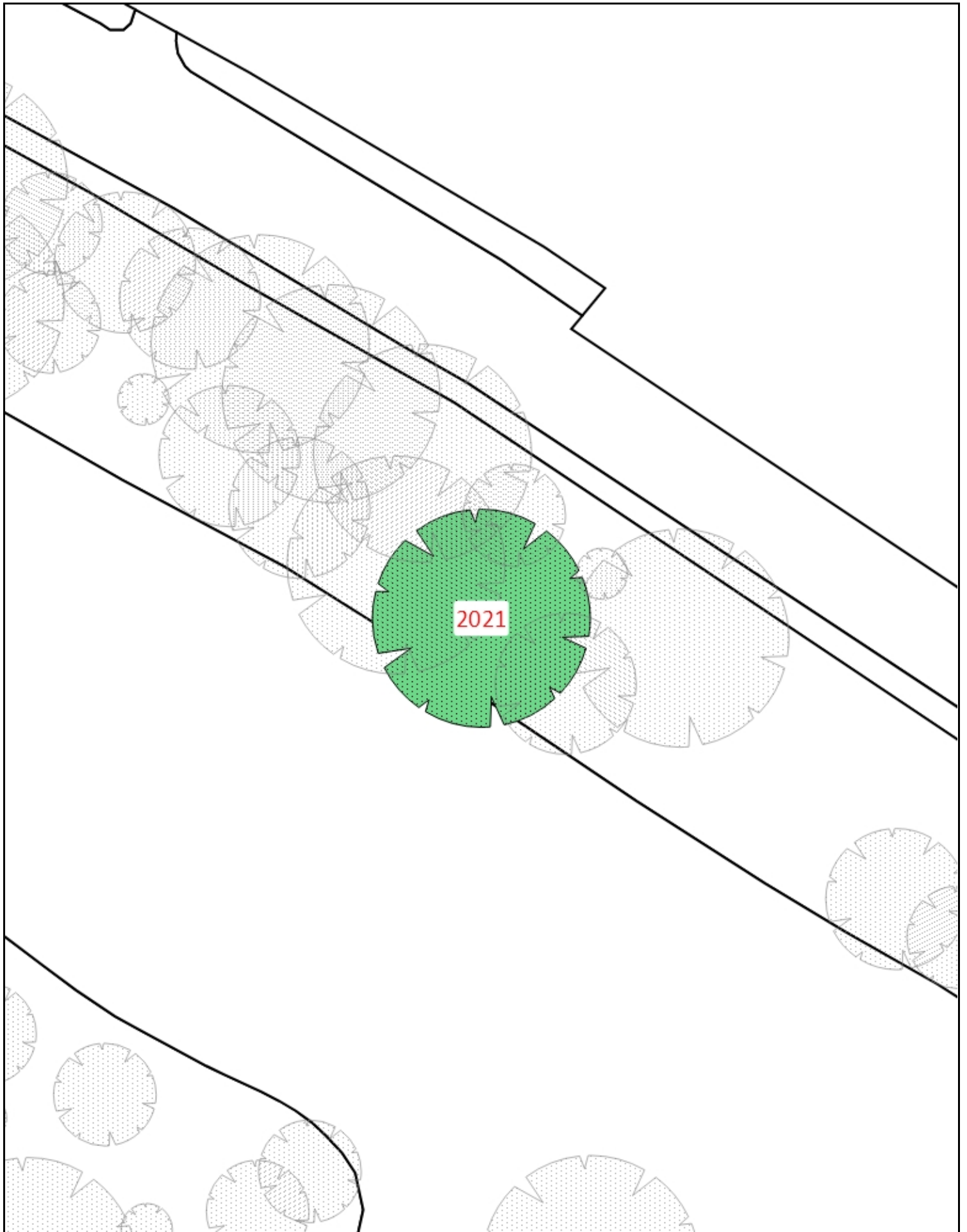

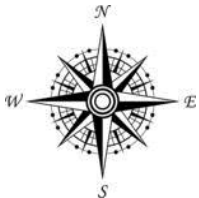
	<b>LZ 29 - Car Park (Prince Albert Road)</b>	<b>Scale</b>	<b>1: 377</b>	
		<b>Date</b>	<b>01/03/2023</b>	