

Summary of Structural Repair Types to Stairs

- Stair 1 - 1 no. repair type 4
- Stair 2 - 2 no. repair type 1
- Stair 3 - Not part of this application
- Stair 4 - 2 no. repair type 1
- Stair 5 - 1 no. repair type 3 and 1 no. repair type 4
- Stair 6 - 2 no. repair type 1 and 1 no. repair type 2
- Stair 7 - 1 no repair type 4
- Stair 8 - 2 no. repair type 1 and 1 no. repair type 2
- Stair 9 - no structural repairs required

Typical Structural Repairs





Repair type 1 - Cast iron beam repair
See detail below

Repair type 2 - Stone soffit crack repair
See drawings 1910/20/08 & 09

Repair type 3 - New steel beam supports and fabric consolidation
See drawings 1910/20/04 & 07

Repair type 4 - Concrete fabric repair
To all exposed concrete surfaces (top,sides,soffit):
Apply proprietary corrosion inhibitor as per the specification

KEY

-  Existing Reinforced Concrete Staircase
-  Existing Stone staircase
-  Existing Cast iron beams
-  Denotes crack in soffit of stone stair

notes

1. This drawing is to be read in conjunction with all relevant Architect's and Engineer's drawings and the specification.
2. In preparing their tender the contractor is to visit site in order to view the existing arrangement and materials and take all necessary measurements to provide a tender return to the client
3. All new Steelwork to be Grade S355 J0 galvanised as per corrosion specification.

NOT FOR CONSTRUCTION

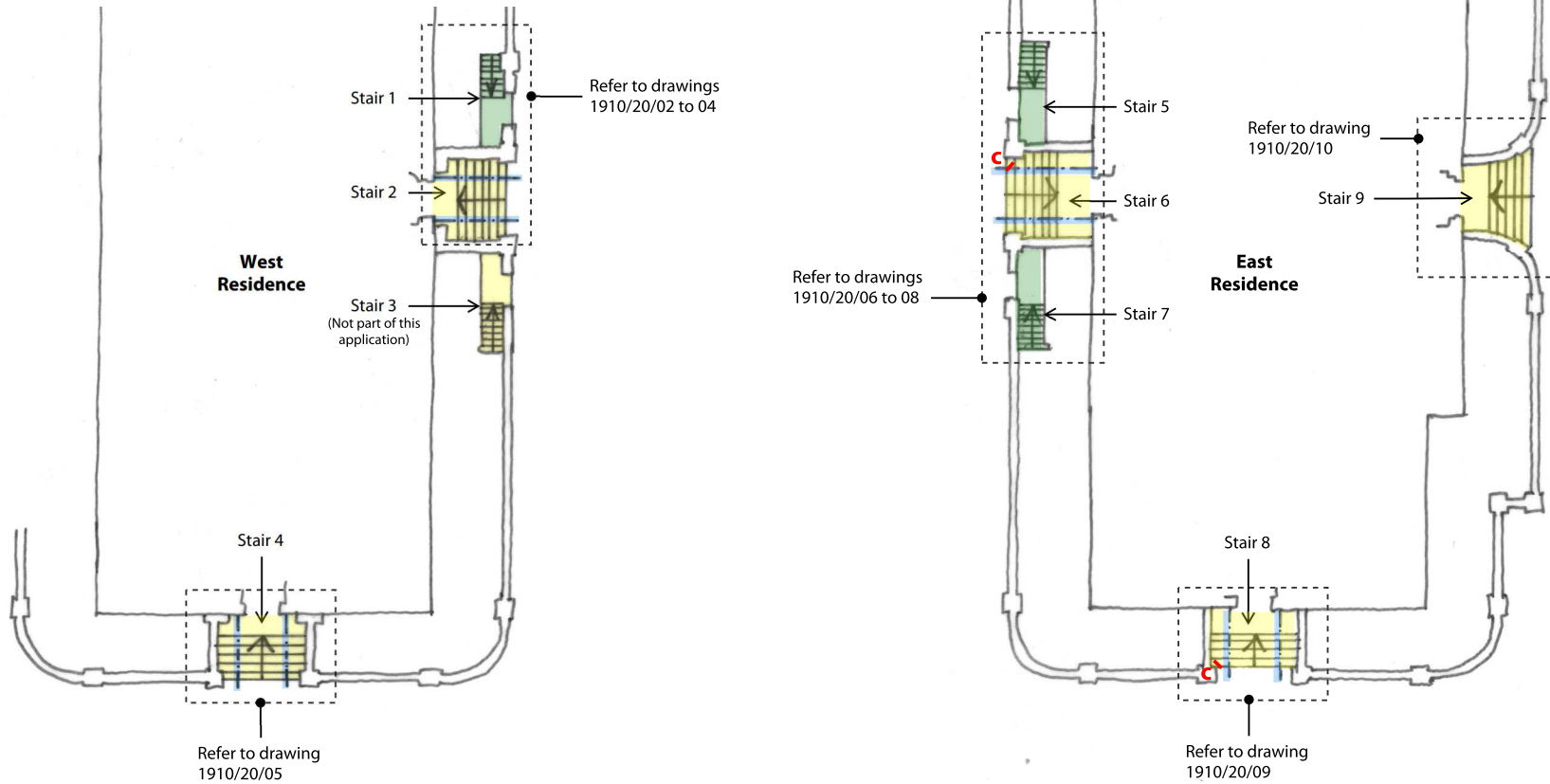

To all exposed areas of beam :
- thoroughly clean metal surface to remove all paint and surface corrosion back to sound metal with wire brush.
- to full beam area provide 2 no. coats of epoxy zinc phosphate primer corrosion protection

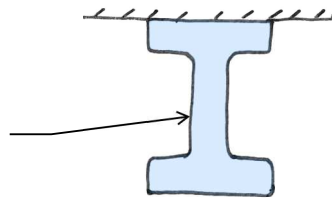

Repair Type 1 - Cast Iron of Beams (8 No.)
(1:5)

Note existing services may need to be temporarily diverted in order to access all beams

At ends:

- Expose sides of beams in order to carry out corrosion repair to sides, as noted on adjacent detail.
- Make good masonry to match existing, tight to sides of beam.

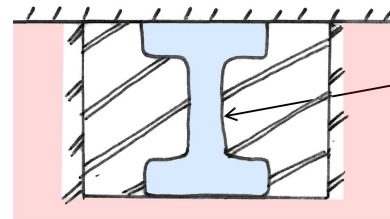

Repair Type 1 - Cast Iron Beam Ends (16 No.)
(1:5)

A	10.02.23	ISSUED FOR LISTED BUILDING CONSENT. STAIR 3 OMITTED.	MSp
-	22.02.22	ISSUED FOR TENDER	LK

job
**British Museum
Phase 6 Fabric Repairs
Staircases**

title
Overall Summary Drawing

drawn	checked
AEs	LK
date	scale (original - A3)
January 2022	~1:200

Alan Baxter

75 Cowcross Street London EC1M 6EL
tel 020 7250 1555
email aba@alanbaxter.co.uk
www.alanbaxter.co.uk

drg. no.	rev.
1910/20/01	A