

- MATERIALS
- 1. GLAZED TERRACOTTA CLADDING
  - 2. PPC METAL PROFILED ROOF PLANT ENCLOSURE
  - 3. GREY BASALT STONE CLADDING
  - 4. GREY PPC ALUMINIUM WINDOWS
  - 5. BLACK PPC ALUMINIUM SHOPFRONT WINDOWS
  - 6. PPC STEEL BALUSTRADE
  - 7. GREY / BUFF NARROW GAUGE BRICKWORK
  - 8. DARK GREY PPC METAL LOUVRED SCREEN
  - 9. DARK GREY PPC METAL CANOPY
  - 10. GREY PPC METAL BALUSTRADE
  - 11. PPC METAL COPING

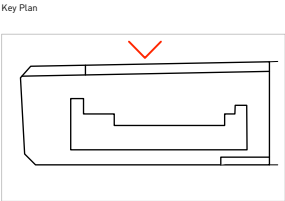

3 MOREWELL ST - EAST ELEVATION  
ST-PL-03-102 SCALE 1:200 @ A3

GENERAL NOTES:		
Do not scale from this drawing.		
Check drawing on receipt and immediately report any discrepancies to the Architect.		
Verify all dimensions and levels on site prior to construction.		
The contents of this drawing are Stiff + Trevillion Architects Ltd copyright and shall not be re-used without their written permission.		
Revisions		
Rev.	Date	Note
A	04/11/20	Terracotta to 5th Floor Terrace set back in lieu of brickwork. Brick piers added to 6m grid up to 3rd floor. String courses + parapet brick details added. Basalt plinth extended along morwell street. First floor windows amended.
B	20/01/23	Facade/parapet/escape-cycle-office entrance doors/ u/gpn louvres updates
Approved		



Stiff + Trevillion

Stiff + Trevillion Architects Ltd  
16 Woodfield Road  
London W9 2BE

T +44(0)20 8960 5550  
mail@stiffandtrevillion.com  
www.stiffandtrevillion.com

Client	
M&G Fitzrovia nominee 1 Ltd & M&G Fitzrovia nominee 2 Ltd	
Project No.	Project
4486	247 Tottenham Court Road, W1T 7QZ
Drawing Title	
Morwell Street East Elevation	

Drawing Status		
PLANNING		
Date	Scale @ A1	Scale @ A3
MAR 2022	1:100	1:200
Drawing No.		Revision
ST-PL-03-102		B