

KEY

PROGRAMME

Store, Sushi Bar, Till Counter, Seating Space, Prep Kitchen
Changing Room, Office, Toilet, Walk-in Freezer, Storage.

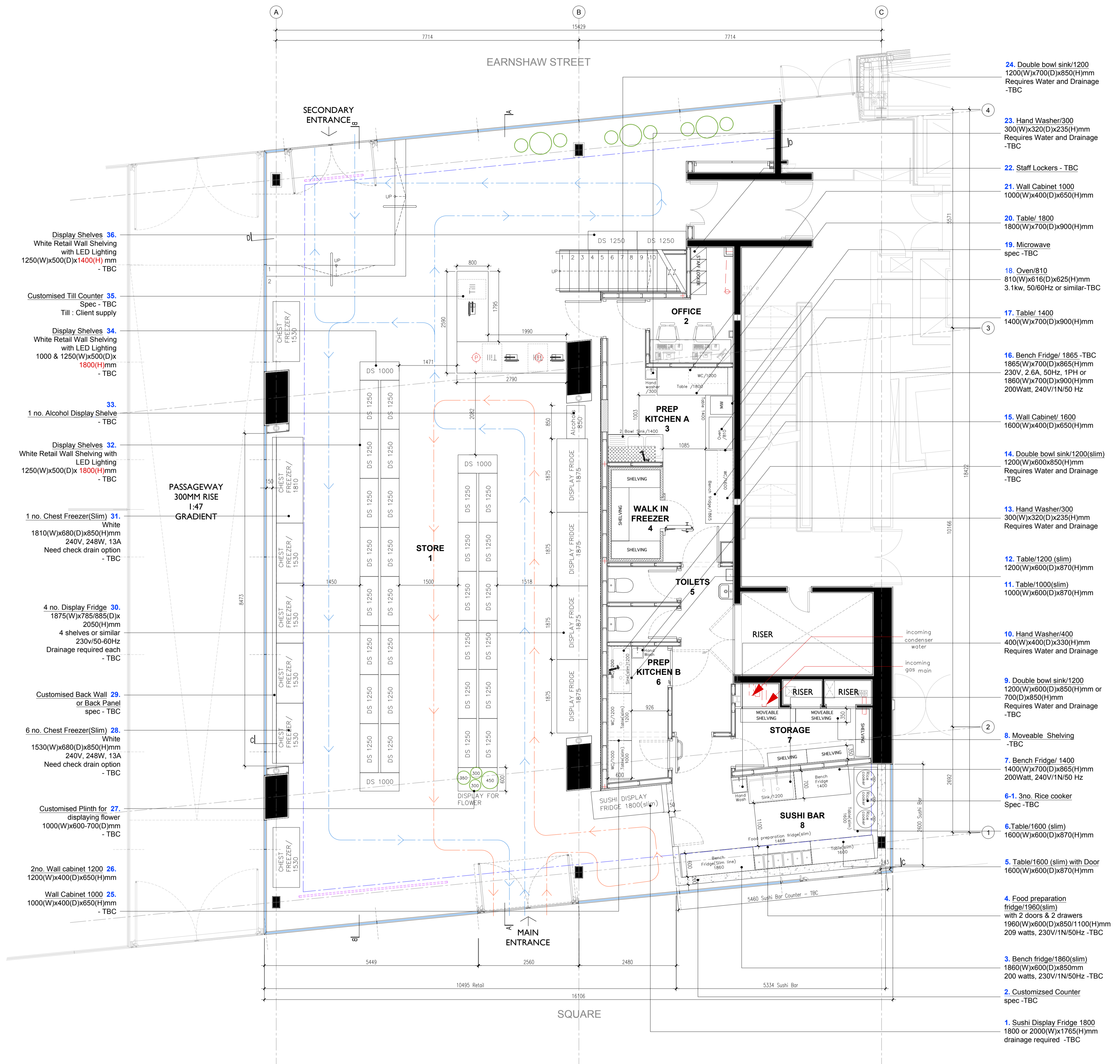

PROPOSED GENERAL ARRANGEMENT GROUND FLOOR PLAN
SCALE 1:50

- 24. Double bowl sink/1200
1200(W)x700(D)x850(H)mm
Requires Water and Drainage
-TBC
- 23. Hand Washer/300
300(W)x320(D)x235(H)mm
Requires Water and Drainage
-TBC
- 22. Staff Lockers - TBC
- 21. Wall Cabinet 1000
1000(W)x400(D)x650(H)mm
- 20. Table/ 1800
1800(W)x700(D)x900(H)mm
- 19. Microwave
spec -TBC
- 18. Oven/810
810(W)x616(D)x625(H)mm
3.1kw, 50/60Hz or similar-TBC
- 17. Table/ 1400
1400(W)x700(D)x900(H)mm
- 16. Bench Fridge/ 1865 -TBC
1865(W)x700(D)x865(H)mm
230V, 2.6A, 50Hz, 1PH or
1860(W)x700(D)x900(H)mm
200Watt, 240V/1N/50 Hz
- 15. Wall Cabinet/ 1600
1600(W)x400(D)x650(H)mm
- 14. Double bowl sink/1200(slim)
1200(W)x600x850(H)mm
Requires Water and Drainage
-TBC
- 13. Hand Washer/300
300(W)x320(D)x235(H)mm
Requires Water and Drainage
- 12. Table/1200 (slim)
1200(W)x600(D)x870(H)mm
- 11. Table/1000(slim)
1000(W)x600(D)x870(H)mm
- 10. Hand Washer/400
400(W)x400(D)x330(H)mm
Requires Water and Drainage
- 9. Double bowl sink/1200
1200(W)x600(D)x850(H)mm or
700(D)x850(H)mm
Requires Water and Drainage
-TBC
- 8. Moveable Shelving
-TBC
- 7. Bench Fridge/ 1400
1400(W)x700(D)x865(H)mm
200Watt, 240V/1N/50 Hz
- 6-1. 3no. Rice cooker
Spec -TBC
- 6. Table/1600 (slim)
1600(W)x600(D)x870(H)mm
- 5. Table/1600 (slim) with Door
1600(W)x600(D)x870(H)mm
- 4. Food preparation
fridge/1960(slim)
with 2 doors & 2 drawers
1960(W)x600(D)x850/1100(H)mm
209 watts, 230V/1N/50Hz -TBC
- 3. Bench fridge/1860(slim)
1860(W)x600(D)x850mm
200 watts, 230V/1N/50Hz -TBC
- 2. Customized Counter
spec -TBC
- 1. Sushi Display Fridge 1800
1800 or 2000(W)x1765(H)mm
drainage required -TBC

Customer Flows

- For Store
- For Sushi Bar

PROPOSED GROUND FLOOR PLAN

- FOH - Area: 200.6 sqm (CH:5650, 3897mm)
- BOH - Area: 49.8 sqm (CH:2200)
- 1. Store - Area: 183.3mm (CH:5650, 3897mm)
- 2. Office - Area: 4.8 sqm (CH:2200mm)
- 3. Prep Kitchen A - Area: 13.8 sqm (CH:2200mm)
- 4. Walk in Freezer - Area 2.8 sqm
- 5. Toilets - Area 6 sqm (CH:2200mm)
- 6. Prep Kitchen B - Area 5.1 sqm (CH:2200mm)
- 7. Storage - Area 5.3 sqm (CH:2200mm)
- 8. Sushi Bar - Area 14.2 sqm (CH:5650mm)

Ground floor Area : 250.4 sqm
Total Unit Area : 294.9 sqm

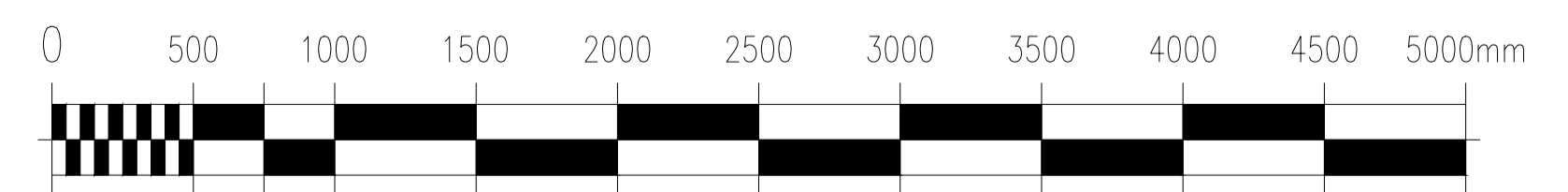

- A. 20/12/2022 - FOH: Amended display flower position.
BOH: Amended staff lockers to inside office
- B. 04/01/2023 - Amended sushi bar equipment (Double bowl
sink and Food preparation bench fridge)
- C. 10/01/2023 - Amended BOH space (sushi bar, staff room and
disable toilet)
- D. 02/02/2023 - Amended sushi bar counter size and sushi display
fridge.

NOTE

All dimensions to be checked on site prior to commencement of any works.
This drawing represents a performance guide upon which the contractor/subcontractor must base his/her working drawings & details. Include all necessary tolerances prior to manufacture and installation.
Contractor must undertake a full survey of the area to establish all dimensions & ensure accurate setting out.
Advise on suitability of all details shown to ensure structural stability, ease and economy of construction.

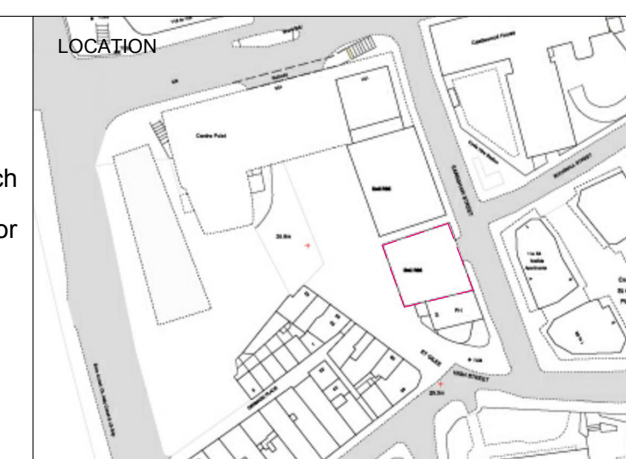

studio penn london
Architecture & Interior Design

| | | | |
|------------------------------|----------------|---|----------|
| job title | | SEOUL PLAZA - UNIT R06 & R08 CENTRE POINT | |
| drawing title / location | | PROPOSED GENERAL ARRANGEMENT PLAN GROUND FLOOR | |
| drawn by | checked by | scale | status |
| JL | YH | 1 : 50 @A1 / 100 @A3 | PLANNING |
| classification / drawing no. | revision | | |
| 2205 | 2205.CP.DE.200 | | |
| | | | D |