

**NOTES**  
 These plans and specifications prepared by FIMA Architecture and Planning Ltd as instruments of professional service shall remain the property of FIMA Architecture and Planning Ltd.  
 These plans may not be copied or re-used without the express written consent of FIMA Architecture and Planning Ltd. The use of these plans for construction is permitted only when specifically released for construction reference by a dated authorial signature.  
 These plans are project and site specific and shall only be used for their intended purpose unless otherwise permitted by written consent of FIMA Architecture and Planning Ltd.  
 All dimensions shown are indicative and must be double checked on site by the contractor. All work must comply with relevant British Standards and Building Regulations requirements. Any inconsistencies found must be reported to FIMA Architecture and Planning Ltd.  
 DO NOT SCALE FROM THE DRAWING

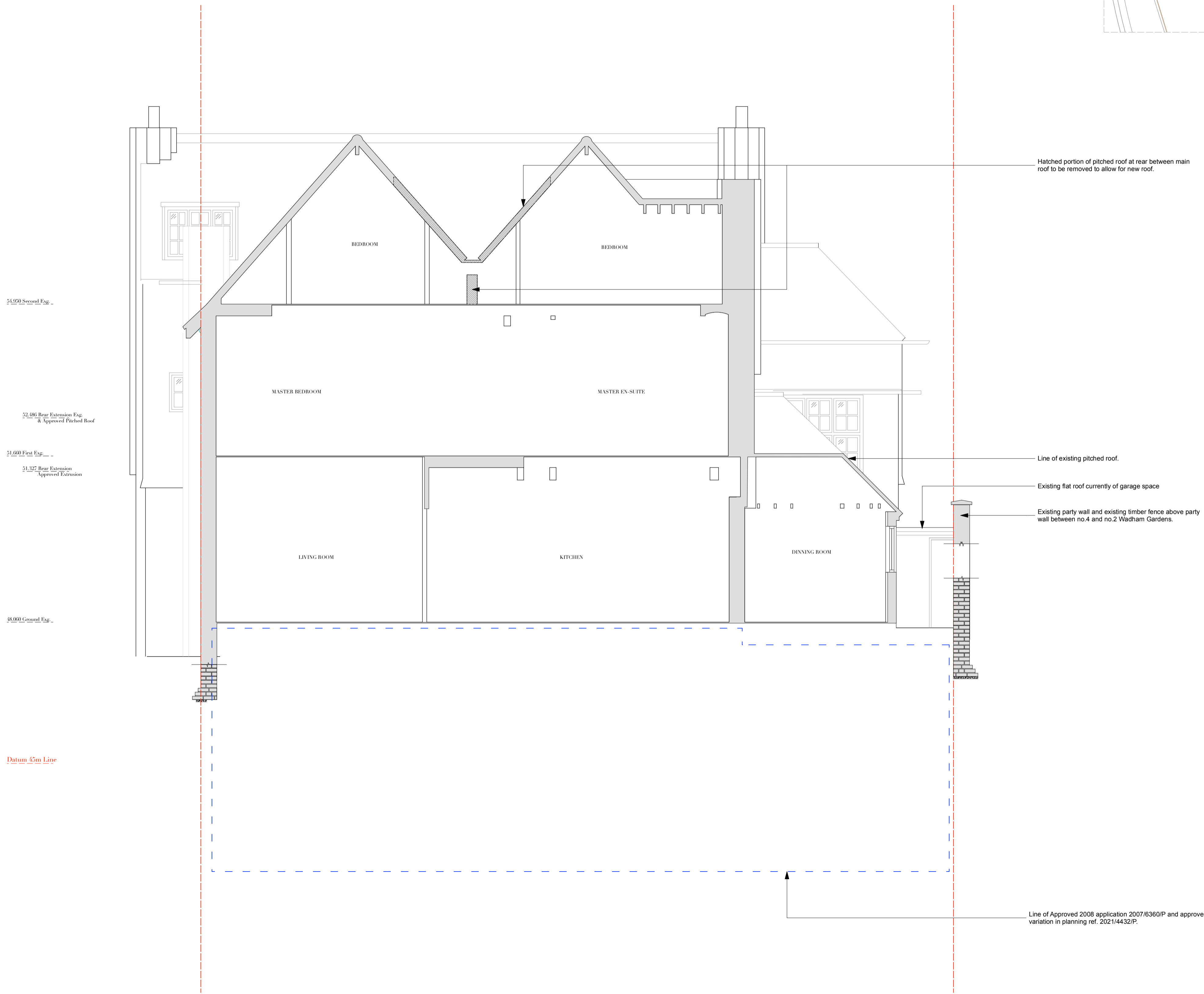
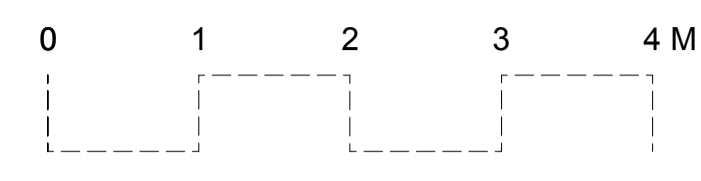

**Key:**

- - - - -	Site Boundary	Existing Structure
- - - - -	Approved Planning outline 2008	New structure
- - - - -	Existing Outline	Demolition

**F I M A**  
 FIMA Architecture and Planning Ltd | Flat 4, 30 Sutherland Avenue, W9 2HQ, London  
 +44 (0) 20 3172 5331 | +44 (0) 777 529 5818 | www.fimaarchitects.com | info@fimaarchitects.com

project:	2 Wadham Gardens, NW3 3DP, London	project no:	2105
drawing:	Existing Section D-D	scale:	1:50 @ A1
drawn by:	Giuseppa M.	date:	January 23

drawing no:	2105(00)204	rev:	1	date:	January 23
		dwg status:	Planning		

Rev	Date	Notes
-	31.01.23	Issue to Camden Council for approval