

46.55

ROOF  
39.23

Mezz  
36.20

GF  
33.50



Match the window frames.  
Texture of these panels? Due  
n the main elevation and  
t approach here. Have you  
differentiate from the rest

- KEY**
- 1 Roman brick
  - 2 Metal window frame
  - 3 Contrasting stack bonded brickwork
  - 4 Timber door in HW frame
  - 5 Translucent glass sliding screens (internal)
  - 6 Perforated metal screens

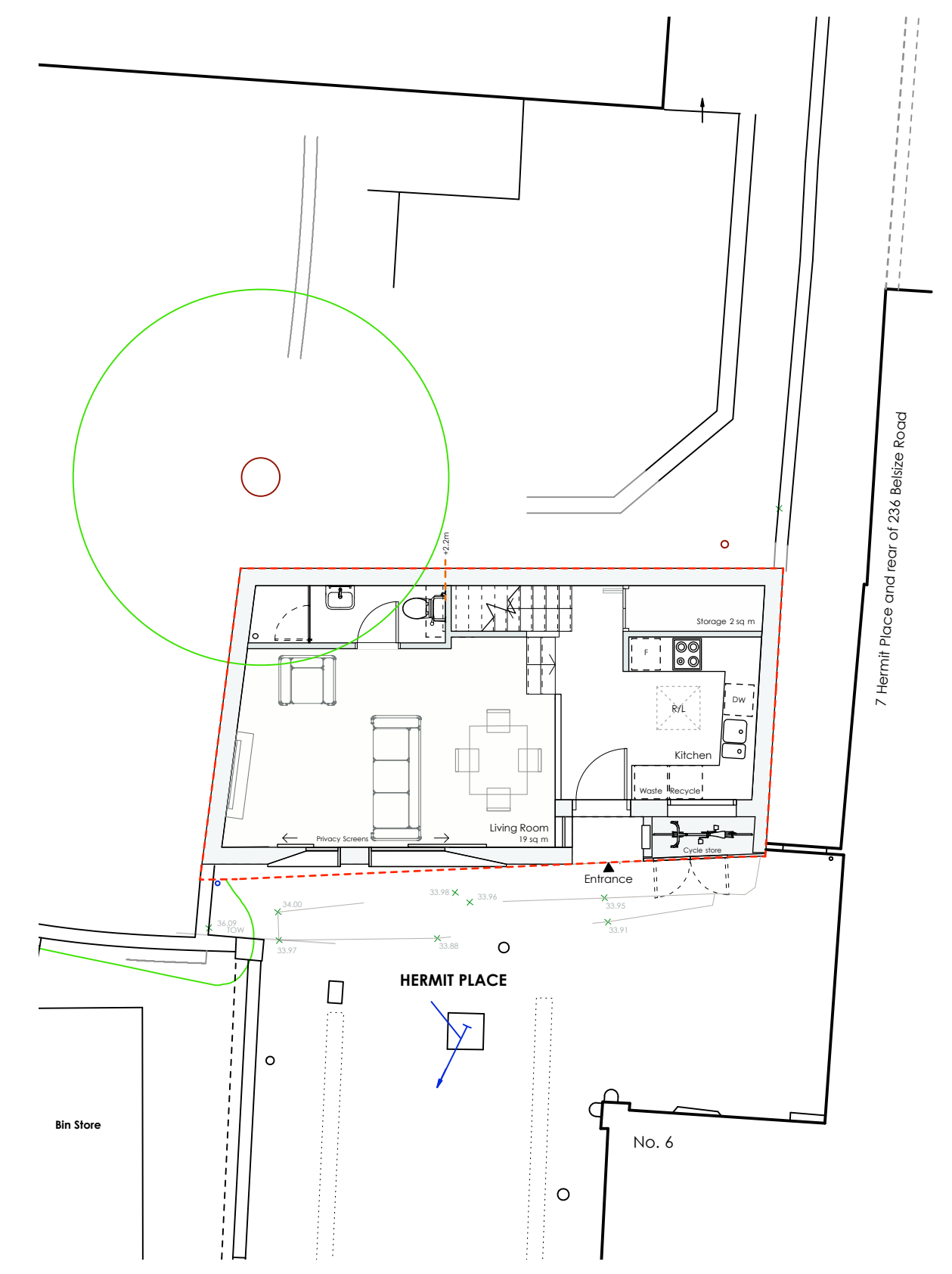
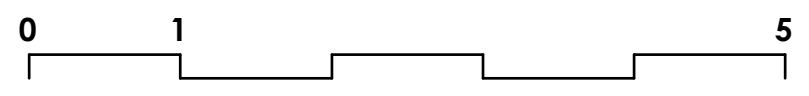

Rev A - 29-9-2022 : - Metal panels deleted and replaced with stack bonded brickwork  
- Internal sliding panels amended to translucent glass

**PLANNING ISSUE 2022**

<p><b>AP (a.)</b> alan power   (ARCHITECTS.)</p> <p><small>Alan Power Architects Ltd 13 Needham Road London, W11 2RP Tel. 020 7229 9375 Fax. 020 7221 4172</small></p>	<p><b>DRAWING</b> PROPOSED FRONT (SOUTH-WEST) ELEVATION</p>	<p><b>DRWG. N°.</b> 527/305</p>
	<p><b>PROJECT</b> 5 HERMIT PLACE LONDON NW6 4BZ</p>	<p><b>Rev.</b> A</p>
	<p><b>CLIENT</b> EMPIRE COMMUNICATIONS LTD</p>	<p><b>Scale</b> 1:50 @ A2 1:100 @ A4</p>
		<p><b>Date</b> March 2022 <b>Drawn</b></p>

DO NOT SCALE FROM THIS DRAWING. ALL DIMENSIONS TO BE CHECKED ON SITE AND DISCREPANCIES REPORTED TO ARCHITECT