

KILBURN HIGH ROAD

QUEX ROAD

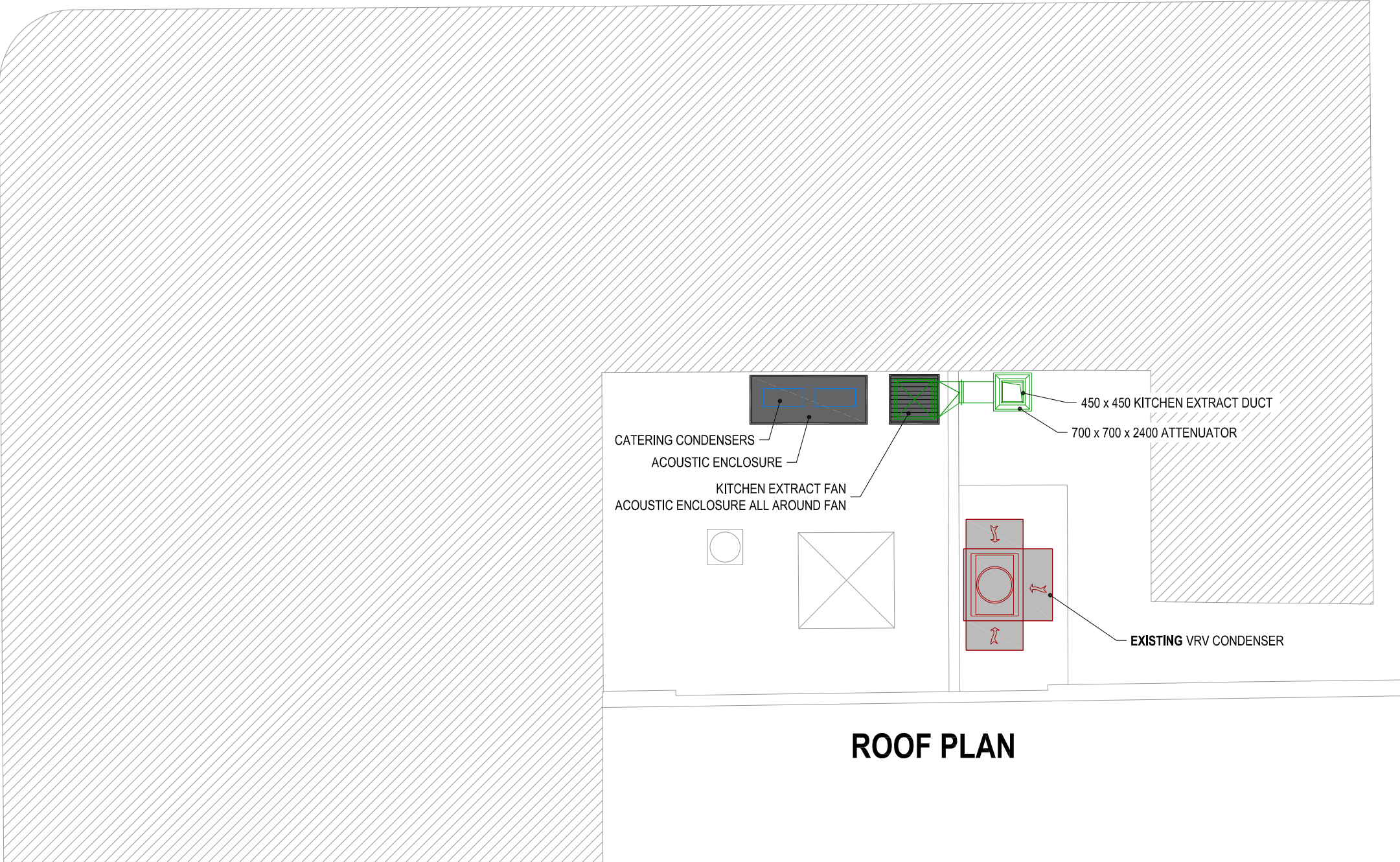

ROOF PLAN

- General notes:
1. Positions of all equipment, ductwork and fittings are indicative only.
  2. Contractors shall confirm the sequence of installation works to ensure safe access is maintained.
  3. Attention is drawn to health & Safety Issues. Liaise with the main contractor to ensure that installation works are programmed to maintain HSE rules and common coordination.
  4. All dimensions / duct sizes are in millimetres unless otherwise stated.
  5. This drawing was produced using CAD and should not be amended by hand.
  6. All dimensions shown are for reference and should be checked on site prior to commencement of work.
- Specific notes:
1. This drawing should be read in conjunction with all architectural, structural and drawings from other services (i.e. mechanical, catering, electrical, sprinklers) along with contract documentation and specification for the works.
  2. Ensure all method statements, sign offs and approvals are in place before proceeding with any works.
  3. All works to be carried out in accordance with the current British Standards, B.S. codes of practice and building regulations.
  4. The HVAC services works shall be carried out in full accordance with the client specification and title, together with any relevant technical guide and specification.
  5. Ductwork shall be installed in accordance with all current industry standard published / regulations.
  6. Galvanneal ductwork to be manufactured to DW144.
  7. Ductwork sized in accordance with all current industry standard guidelines / regulations. Duct dimensions shown on drawing are clear internal dimensions (not including flanges and fittings).
  8. Access doors required on kitchen extract duct every 1500mm for cleaning and before / after every change of direction & should be accessible at all locations via ceiling access panels or ground-level etc. Access panels to be provided by main contractor in any wall cuttings where final requirements indicated by HVAC installation contractor.
  9. Duct connections with fans and other equipment to be a manufactured canvas connector to prevent duct breaching noise and transmission of vibrations.
  10. Volume control dampers shall be installed on all branch legs and diffuser / grille terminals to facilitate commissioning.
  11. Supply and secondary fan cut out ductwork to be fully insulated.
  12. Fresh air intakes and exhausts locations are shown indicatively on these drawings. The exact positions shall be agreed with the client, architect and the main contractor and shall be shown accurately on the working / coordinated drawings.
  13. Position of all grille / air valves shown are in optimum positions for air flow. The grille to be positioned as close as practicable to location shown and coordinate with other services and fixed constraints.
  14. The dampers are to be shown on ductwork (excluding kitchen extract ducts) penetrating the compartment risks and shall incorporate certified fire dampers to match the leaflet rating, together with access panels. Reference to be made to architect / fire strategy drawing to establish locations. The dampers are shown indicatively on these drawings.
  15. All transfer grille and ductwork where the rated, shall match the fire rating of the wall in which it is installed.
  16. Attenuation and anti-vibration measures shall be incorporated on all plant and ductwork supports in full accordance with acoustic consultancy specifications.
  17. Access required to all plant equipment for maintenance and cleaning.
  18. Refer to catering specialist layout to determine confirmed canopy sizes and location.
  19. Condensate drain from AC condensers to be run to the nearest waste connection or to rooftop drain. Condensate drains from the FCUs to be run to the nearest drain (drains subject to manufacturer and their requirements. Both shall be the equivalent diam or copper sizes.
  20. Install all mechanical equipment in accordance with manufacturers guidelines.
  21. Catering condensers are not CVL equipment. However, they are indicatively shown on CVL drawings to allow for pre-planned access and access within the HVAC plant area.
  22. Locations of all required floor, wall and roof openings shall be co-ordinated with all other trades involved.
  23. No other loads (other services or man loading) shall be hung from ductwork supports.

Project :  
**POPEYES**  
122-126 KILBURN HIGH ROAD  
LONDON NW6 4HY

Drawing Title :  
**PROPOSED EXTRACT  
ROOF PLAN**

Drawing No:	Rev:
001-1010-02	A
Scale: 1:50 @ A1, 1:100 @ A3	
Drawn By: PR	Date: 14/12/22

