

Proposed gate - 100mm narrower than standard 'Flexi 1 lift' as advised by INVA LIFTS (or similar/approved). Flush mounted pressure control call button to sit within gate frame

Ensure lift setting out is clear of window cill projection

Lift to have Powder coated finish RAL9005 (Black)

Pressure controls to sit within handrail

300mm approx. structural opening width of existing basement window. Ensure new structural opening is clear of window and lintel

Ensure safety glazing is present to window

Further coordination to reinforce ground floor slab required at the next stage

1100mm high, pressure control bar

Chamfered ramp

Proposed 'Flexi 1 lift' by INVA LIFTS (or similar/approved)

1 Proposed Elevation AA  
Scale: 1:10

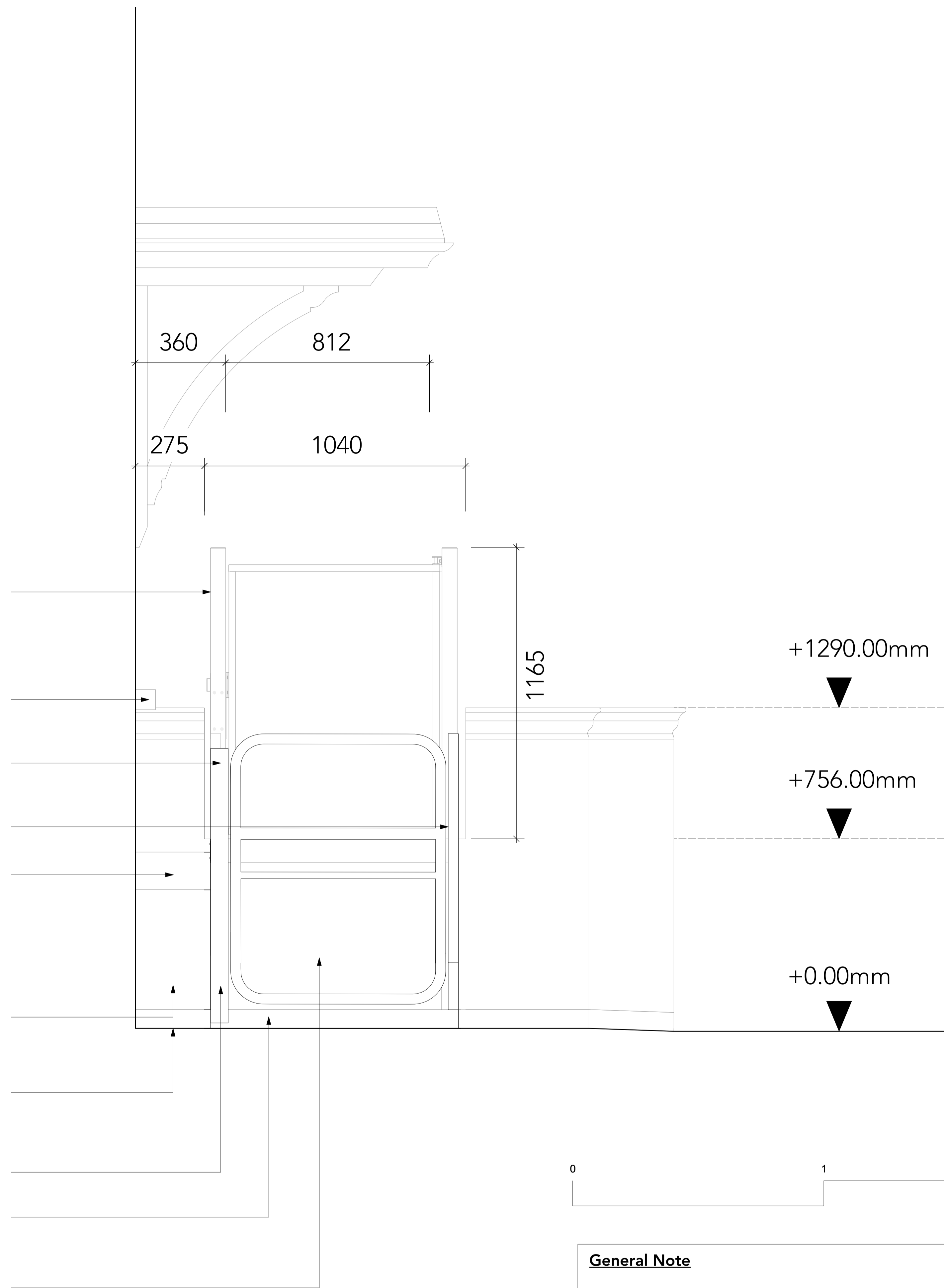

**General Note**

- Levels are indicative and will require accurate re-measuring
- Contractor to take site measurements prior to installation
- Contractor to consult with heritage consultant
- Contractor to confirm with architect/planning/heritage consultants
- Further coordination with structural engineer required

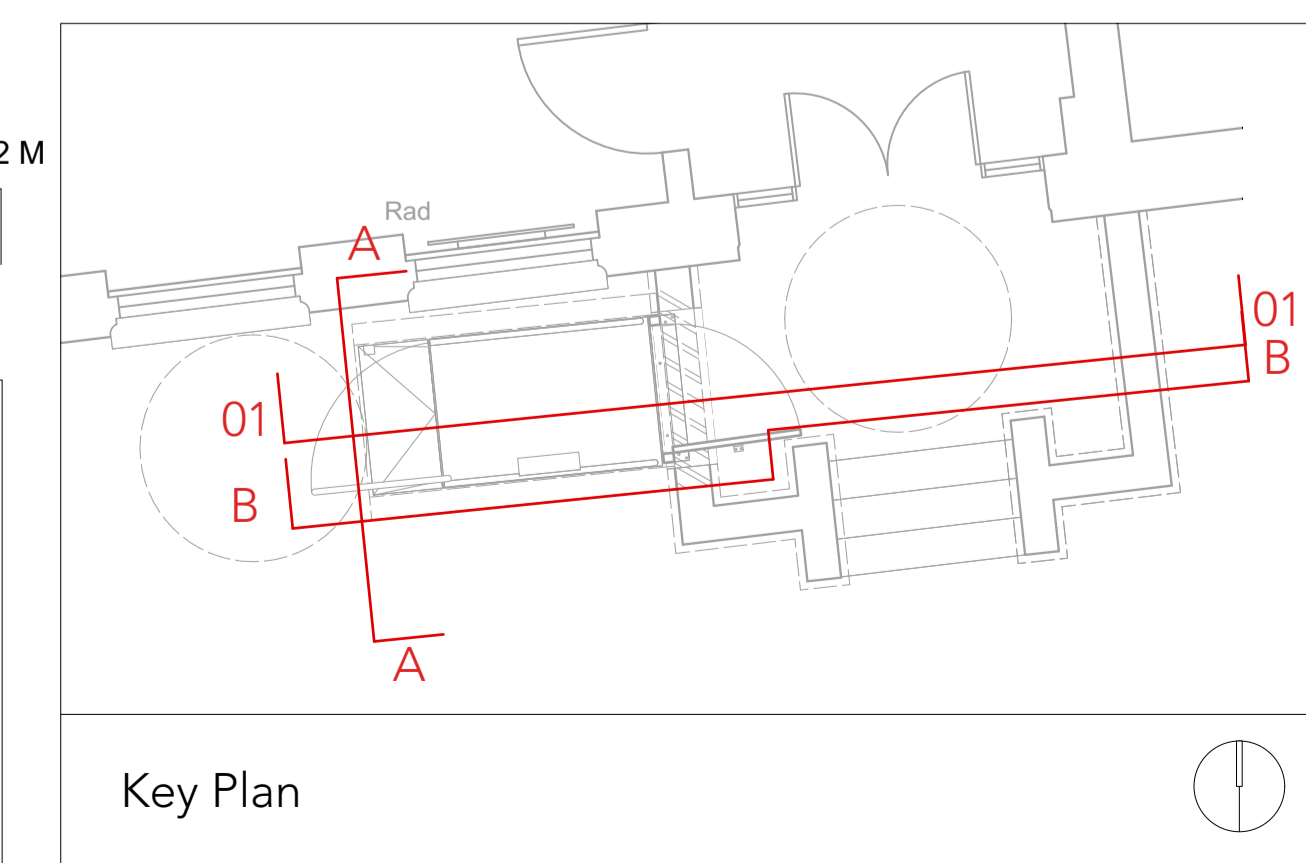

date	revision	revision
Scale for planning purposes only - Do not scale for construction Confirm all dimensions on site prior to manufacture Confirm discrepancies with Architect prior to proceeding Refer to all Engineers' documentation		
job no.	Oakwood House Platform Lift	job title
639		
date	Proposed Elevation AA	diag. title
30/01/2023		
Client:	South Hampstead High School	
TK	Scale: 1:20 @ A3 / 1:10 @ A1	
drawn	639_P200	rev. no.
PLANNING		
Sarah Wigglesworth Architects ©		
T +44 (0)20 7607 9200 E mail@ssearch.co.uk W www.ssearch.co.uk		