

DESIGN & WEIGHT LOADINGS

Substrate green roof systems

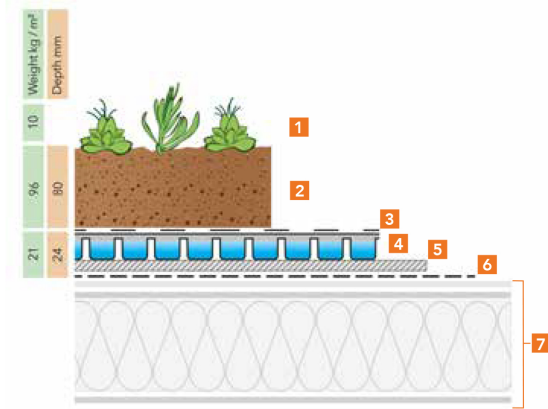

Sedum plug plants on extensive substrate with DSE20

A broad range of individual sedum plug plants can be used to produce a particular design or planting layout suited to the roof conditions. Plugs are typically planted 15-25 per m² and normally in groups of 5-7s of similar species. Sedum plants are very drought tolerant and DSE20 with 80mm of FLL compliant Bauder Extensive Substrate gives adequate water storage to support the vegetation.

LEGEND

- 1. Vegetation** to suit the project and site locality.
- 2. Bauder Extensive or Biodiverse Substrate** Light weight growing medium. Manufactured and used in accordance with FLL / GRO guidelines.
- 3. Bauder Filter Fleece** filtration layer prevents substrate fines from washing into the drainage layer.
- 4. Bauder water storage and drainage DSE20 or DSE40**, capacity to suit the vegetation and project.
- 5. Bauder FSM600** 4mm thick protection layer.
- 6. Bauder PE Foil** A polyethylene foil separation and slip layer manufactured from recycled granules required on some project specifications.
- 7. Bauder Waterproofing System** High performance waterproofing membranes suitable for green roof systems.

bauder.ie

200

1 Green Roof Manufacturers Specification

GSS - GREENROOF SHADE MIX -	size	%	no.	Evergreen?
TOTAL AREA OF PLANTING 35m ²				
SPACING OF PLUGS 36/m ² , following particular species setting out instructions				
TOTAL NUMBER OF PLANTS - 1260(ex. Bulbs)				
BULBS overplanted at rate/location specified				
PERENNIALS				
Ajuga reptans 'Cattlins Giant'	plug	5	63	EverG
Alchemilla mollis	plug	5	63	Semi
Aquilegia chrysantha 'Texas Yellow' (May-June)	plug	2	25	
Aquilegia vulgaris 'Lime Sorbet' (Apr-June)	plug	3	38	
Brunnera macrophylla 'Jack Frost' (Apr-May)	plug	5	63	EverG
Epimedium x perralchicum 'Fröhnleiten' (Apr-May)	plug	5	63	Semi
Fragaria vesca	plug	3	38	Semi
Gypsophila repens Album (May -July)	2ltr	5	63	EverG
Hyssopus officinalis (July-Sep)	plug	5	63	Semi
Omphalodes cappadocica 'Cherry Ingram' (March)	plug	5	63	EverG
Primula veris (May-June)	plug	7	88	
Prunella vulgaris (June-Sep)	plug	3	38	
Saxifraga granulata (April-June)	plug	4	50	EverG
Saxifraga urbium (May-July)	plug	4	50	EverG
Tellima grandiflora (May-July)	plug	4	50	
Trifolium dubium (May-Sep)	plug	3	38	
Vicia cracca	plug	3	38	
Daucus carota	plug	3	38	
GRASSES				
Koeleria macrantha	plug	4	50	Semi
Luzula nivea	plug	10	126	EverG
FERNS				
Asplenium trichomanes	plug	6	76	
Blechnum penna-marina subsp. alpinum (evergree)	plug	6	76	EverG
TOTAL %				
		100	1260	
BULBS				
Anemone blanda White Splendor (March-April)	BULB		150	set out naturally across roof
Cyclamen hederifolium Album (Oct-Nov)	BULB		150	in swathe, kept separate from C. coum
Cyclamen coum subsp. coum f. pallidum 'Album' (J)	BULB		150	in swathes, kept separate from C. hed
Muscari armeniacum (March-April)	BULB		230	7/m ² set out naturally
Hycinthoides non scripta	BULB		252	7/m ² set out naturally

3 Green Roof Planting Schedule

2 Green Roof Maintenance Scheme

Irrigation

- The plants have been selected for drought tolerance and should not require irrigation which is not specified as part of the project. However watering may occasionally be required as set out below.

Watering During first season of growth

- Inspect the planting weekly for signs of die back and or withering. If signs of drought are present water to the full depth of the substrate using a sprinkler system.
- In times of drought or extreme heat inspect the roof every twice weekly and act as set out above when required.

Watering generally

- Inspect the planting fortnightly for signs of die back and or withering. If signs if drought are present water to the full depth of the substrate using a sprinkler system.
- In times of drought or extreme heat inspect the roof weekly and act as set out above when required.

Weeding

- Inspect the roof bi-annually in spring and autumn for the presence of tree seedlings, or shrub seedlings such as Buddleja which may be damaging to the underlying structure if left to grow. Root out if found and dispose to compost.
- Inspect the roof annually for the presence of weeds categorised as invasive by the environment agency. If found recruit a licensed specialist to remove and dispose of these as set out in the Environmental Protection Act 1990.

Clearance of detritus

- Annually after all leaves have fallen and all growth has died back rake off any leaf litter or detritus from the roof.

Replacement of failed planting

- Annually in the next growing season after plants have died using plugs from the species list set out on the planting schedule always bearing in mind that if a particular plant is consistently failing and another successful a substitution will be advisable.

4 Section of Build-up

Scale:1:10

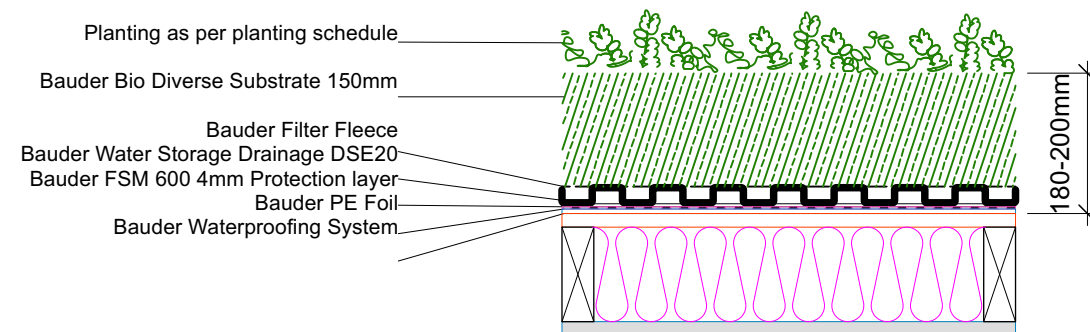

© 51 architecture. Reproduction in whole or in part is forbidden without written permission of 51 architecture.

All dimensions are to be checked on site before any work proceeds. Do not scale this drawing but use only figured dimensions. Any errors or omissions are to be reported to 51 architecture.

The Contractor shall submit full size drawings and specifications to 51 architecture for approval, without which, manufacture shall not commence.

This drawing is to be read in conjunction with all the relevant consultants' and/or specialists' drawings/documents, and any discrepancies or variations are to be notified to 51 architecture before work commences.

For further information please see other drawings and documents enclosed with this drawing. For information on Structure use Engineer's drawings. For further information on Services use Engineer's and/or Contractor's drawings.

Where works are part of a listed building fabric the contractor is to confirm that the works have relevant permissions prior to the commencement of any works.

NB: All drawings subject to relevant Listed Building Consent and Planning Approval (including conditions) No alterations to be made to the building fabric without Planning and Listed Building Consents.

Note: In accordance with Planning Permission ref:2022/1607/P Condition 7

This drawing is to be read with drawings 2000, 2005, 2009, 2010, 2011, 2013, 2017, 2018, 2019, 2023 and 2025 and the Design and Access Statement.

51

12b Keats Grove,
Hampstead
London, NW3 2RN

Project No. 1170_12BKG

51 architecture
1A Cobham Mews, Agar Grove, London NW1 9SB
+ 44 [0] 203 355 1205

Planning

Green Roof Details (Condition 7)

Scale 1:20 +NT® A3

Drawn by PT 01/23

Issue Notes:

2008