

4.2.7
WEST YARD & THE TEMPORARY
OBSERVATION WHEEL
SOFT LANDSCAPING

Soft Landscaping
A landscaping proposal has been developed by Greenways, which includes planting around the two trees to the north of the wheel.

The proposed works include the removal of the current benches around the trees, replacement of the deceased tree, and installation of planting, and railings to protect the trees.

The following pages present extracts from Greenways design report.

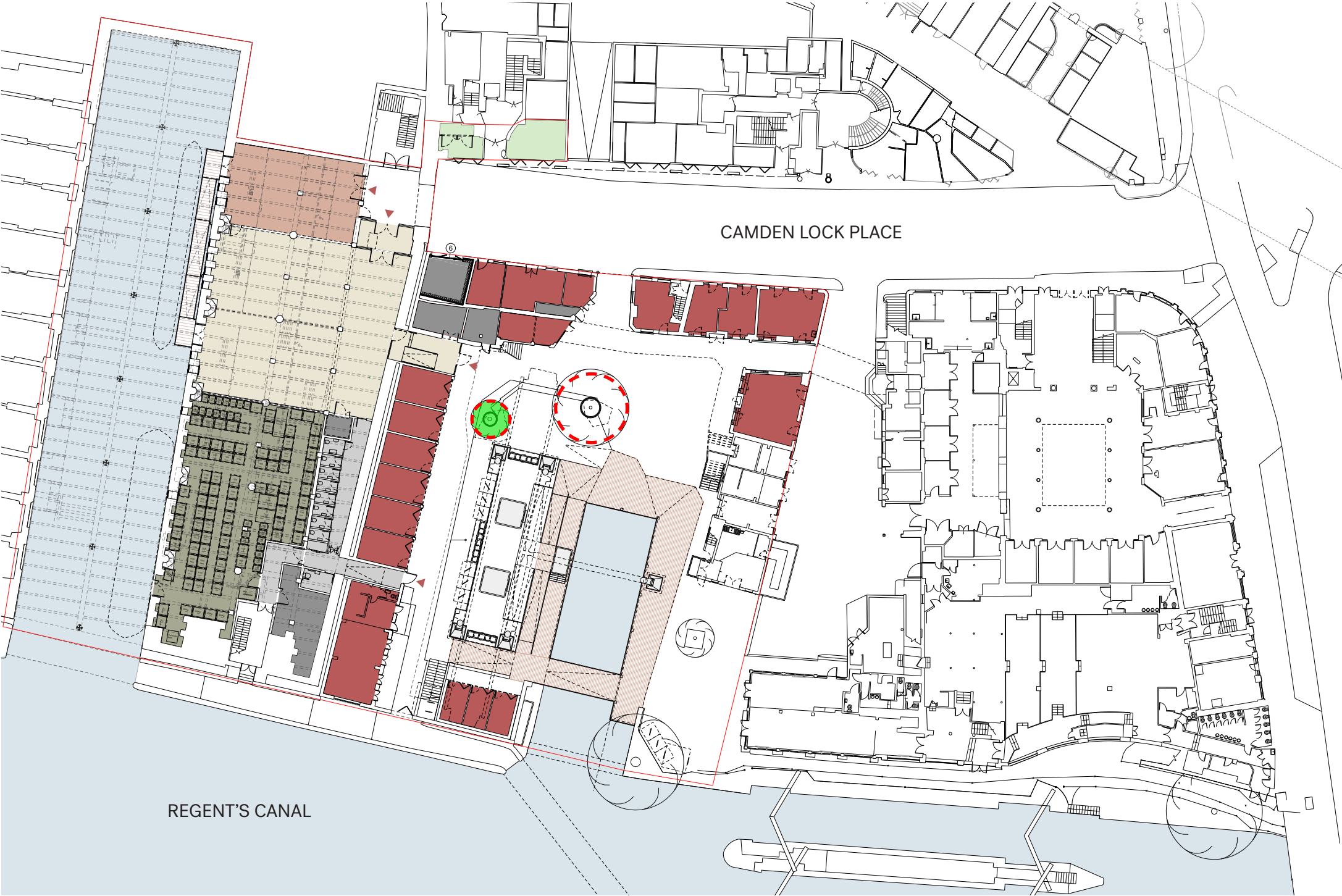

Landscaping

- Trees with proposed landscaped bases
- Deceased tree to be replanted

- Key:
- Market stalls (Class E)
 - Flexible Space (Class F1/E)
 - Educational Exhibition Space
 - Plant & B.O.H. (Sui Generis)
 - Refuse & Recycling (Sui Generis)
 - Ticket Stall (Class E)
 - Site boundary

West Yard | Tree timeline

4.2.7
WEST YARD & THE TEMPORARY
OBSERVATION WHEEL
SOFT LANDSCAPING



March 2013

CAMDEN LOCK MARKET



December 2020

LANDSCAPE PROPOSAL



March 2022

Greenways
LANDSCAPE ARCHITECTURE CHANIKIAN LTD

West Yard | Tree replacement



Seeds



Flowers



Trunk texture



Tree specifications

Tree species: *Robinia pseudacacia*
Trunk perimeter: 40-50 cm
Height: 5m

West Yard | Architectural plan

4.2.7
WEST YARD & THE TEMPORARY
OBSERVATION WHEEL
SOFT LANDSCAPING

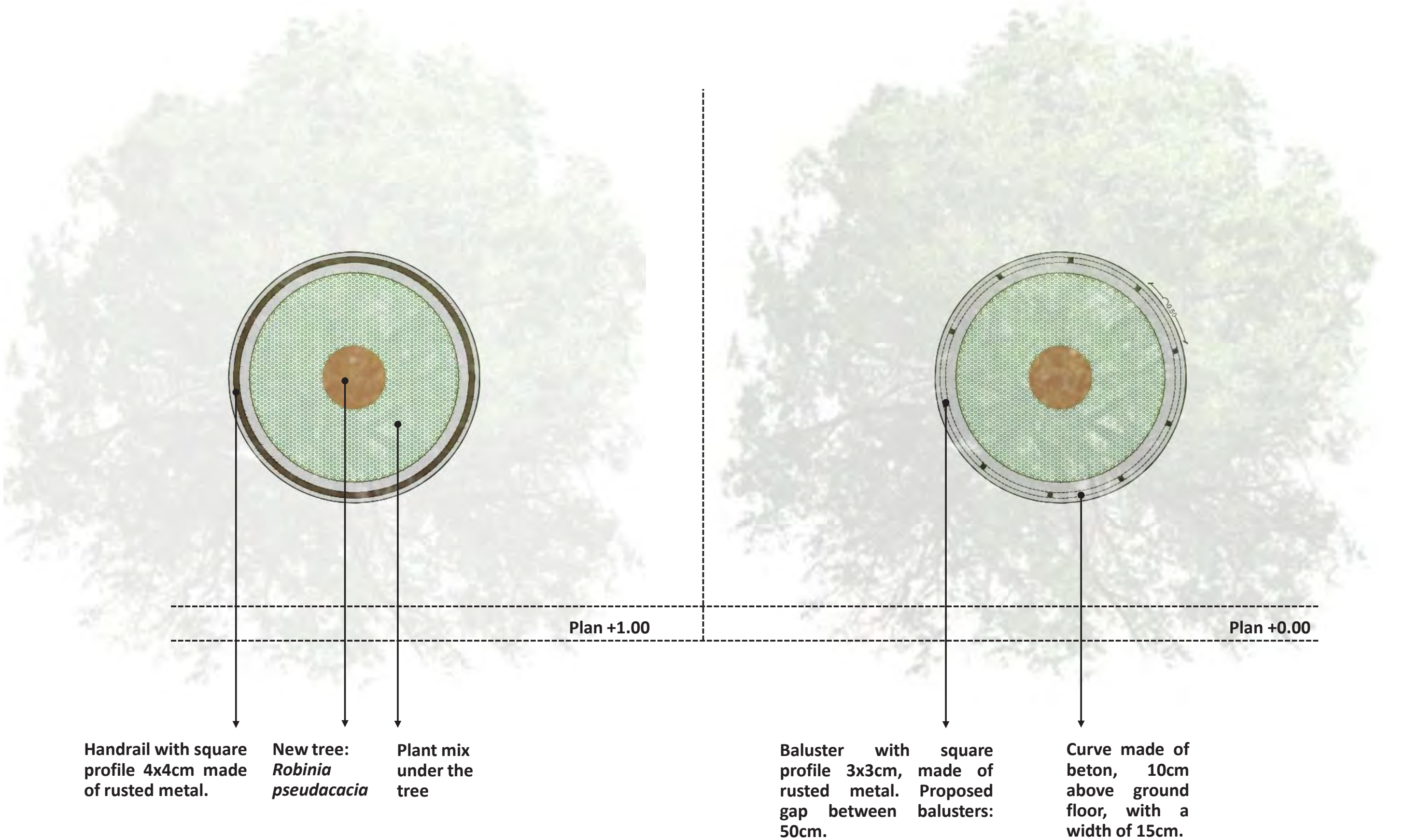

West Yard | Planting palette under the tree

4.2.7
WEST YARD & THE TEMPORARY
OBSERVATION WHEEL
SOFT LANDSCAPING



Pitosporum tobira nana



Gaura lindheimeri



Verbena bonariensis



Salvia 'Hot Lips'

The proposed plant list includes plants species that thrive in the UK weather. The mix of salvias and gauras create a transparent filter, with movement and intense alternation of flowering colors during the seasons. As a stable plant volume we propose pitosporum, a small evergreen shrub.



Salvia farinacea

West Yard | Railing

4.2.7
WEST YARD & THE TEMPORARY
OBSERVATION WHEEL
SOFT LANDSCAPING



4.2.8
WEST YARD & THE TEMPORARY
OBSERVATION WHEEL
EXTERNAL LIGHTING PRINCIPLES

Studio Fractal has been commissioned to propose a lighting concept for updating the external lighting for West Yard. This includes refurbishing the lighting under the bridges and first floor deck around the yard, as well as lighting attached to the buildings.

The existing light fittings will be replaced, and the existing lighting totems on West Yard would be replaced with new lighting attached to the wheel.

Whilst surveys have shown no current bat activity within the site, the lighting strategy ensures that bats flying along the canal will not be disrupted.

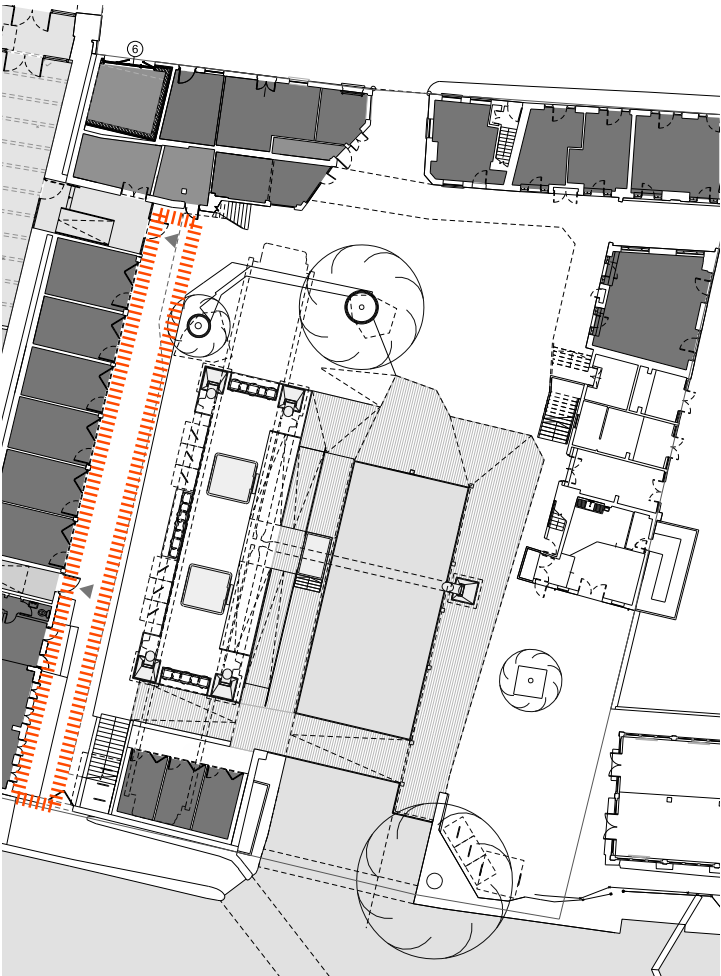

Lighting reference plan



Lighting proposals under covered walkways and building facades

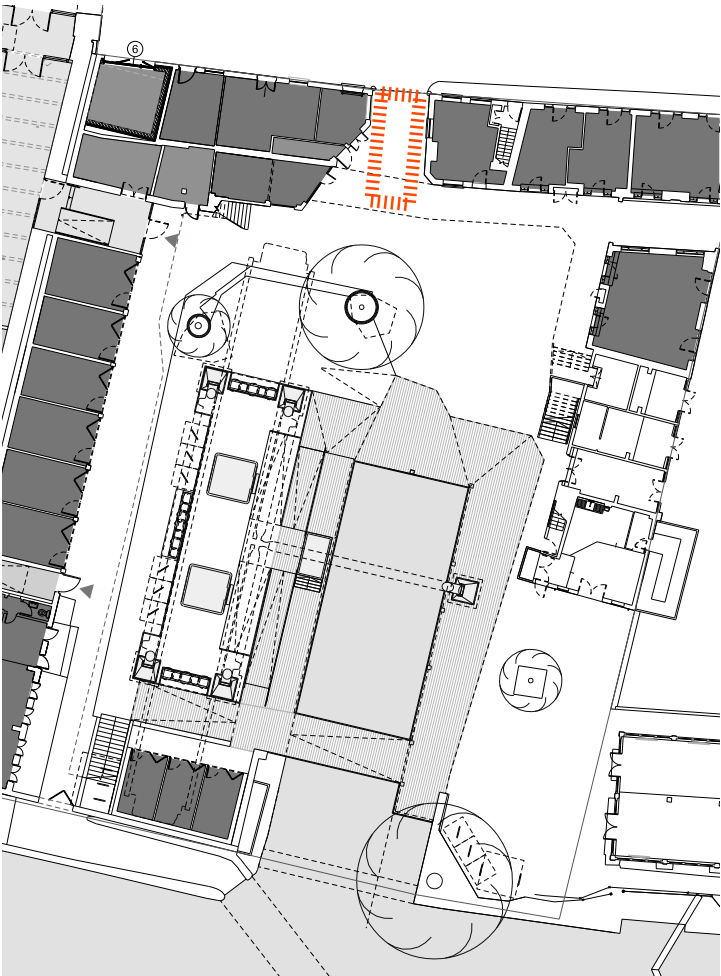
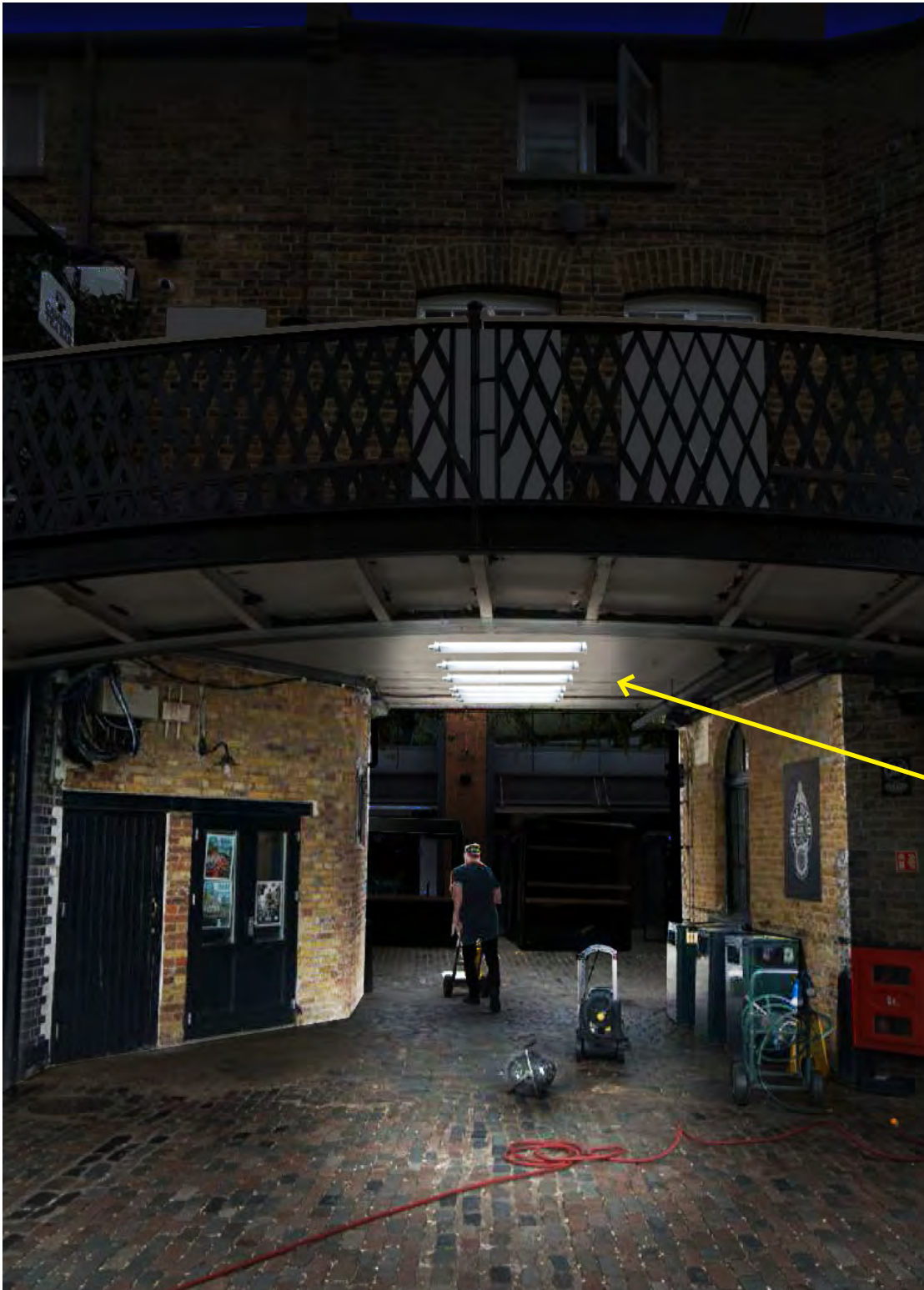

Lighting reference plan



Lighting proposals under bridges and covered walkways



EARLS COURT GIANT WHEEL



BLACKPOOL GIGANTIC WHEEL

LONDON'S FIRST GIANT WHEEL AT EARL'S COURT, COMMEMORATING THE EMPIRE OF INDIA EXHIBITION, WAS MODELLED ON GEORGE OBSERVATION' ORIGINAL WHICH FEATURED AT THE 1893 WORLD COLUMBIAN EXPOSITION IN CHICAGO.

FINISHED IN 1895, THE EARLS COURT WHEEL CARRIED 2.5 MILLION PASSENGERS OVER THE COURSE OF ITS TEMPORARY 11 YEAR LIFESPAN. THE ONCE WORLD-FAMOUS LANDMARK IS NOW ALL BUT FORGOTTEN.

THE BLACKPOOL AND EARLS COURT WHEELS PRECEDED OTHER EUROPEAN GIANT WHEELS BUILT IN PARIS AND VIENNA OVER THE NEXT DECADES. ALL WERE REALISED BY THE SAME BRITISH ENGINEER - WALTER BASSETT.