

NOTES

- This drawing is for engineering services only and is to be read in conjunction with all relevant architectural, structural, mtt drawings and the Contract specification.
- THIS IS NOT AN INSTALLATION DRAWING.**
- All services routes and equipment locations are indicative, actual location and configuration to be determined by contractor following completion of contractor design and coordination.
- This drawing will only be issued in PDF format.
- All penetrations of the fire compartment are to be suitably treated and sealed. All non-metallic pipework is to be provided with fire collars.
- All pipework to be supported in accordance with the manufacturer's requirements.
- All low points within the system are to be provided with drain off cocks.
- Movement / expansion joints to be provided inline with the pipe manufacturer's requirements.
- All pipework subject to freezing shall be complete with frost protection.
- All fittings to be WRAS or KMI UK approved or have bespoke approval from the local water Authority.
- All terminal fittings shall be fitted with accessible combined constant flow regulators and servicing valves as Vega CP961 screwed wonder valve to be accessible.
- All cold water storage plantrooms to be provided with leak detection and bunding.
- All hot water pipework to be trace heated using Raychem HWAT-M rated at 55°C.
- To meet Building Regulations Part G the T&R relief line from the water heaters will need to be installed using copper pipework.
- WH-B to fitted with thermostatic mixing valves (TMV2) set at 41°C located behind access panel.
- DDA wash basins to be fitted with DOC M taps incorporating TMV3 thermostatic mixing valves.
- All pressure reducing valves to be fully adjustable on site and set to a pressure of 3.5 Bar complete with integral pressure gauge.
- All shower fittings to be provided with integral thermostatic valves and complete with an anti-scald device. Refer to Architects sanitaryware schedule.
- Refer to drawing CGY08-MTT-ZZZ-DR-P-0001 Public Health Services Legend of Symbols

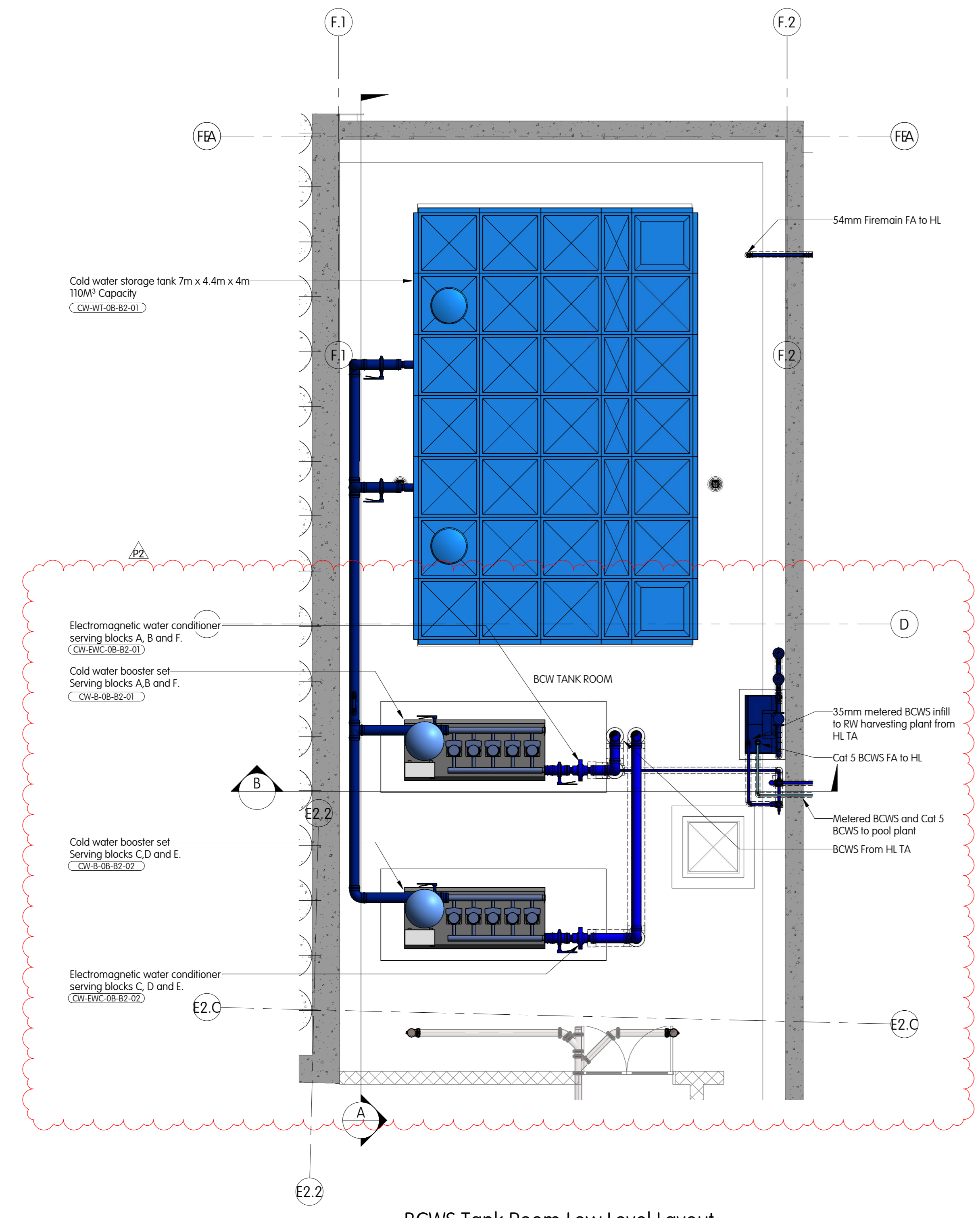

BCWS Tank Room Low Level Layout
1:50

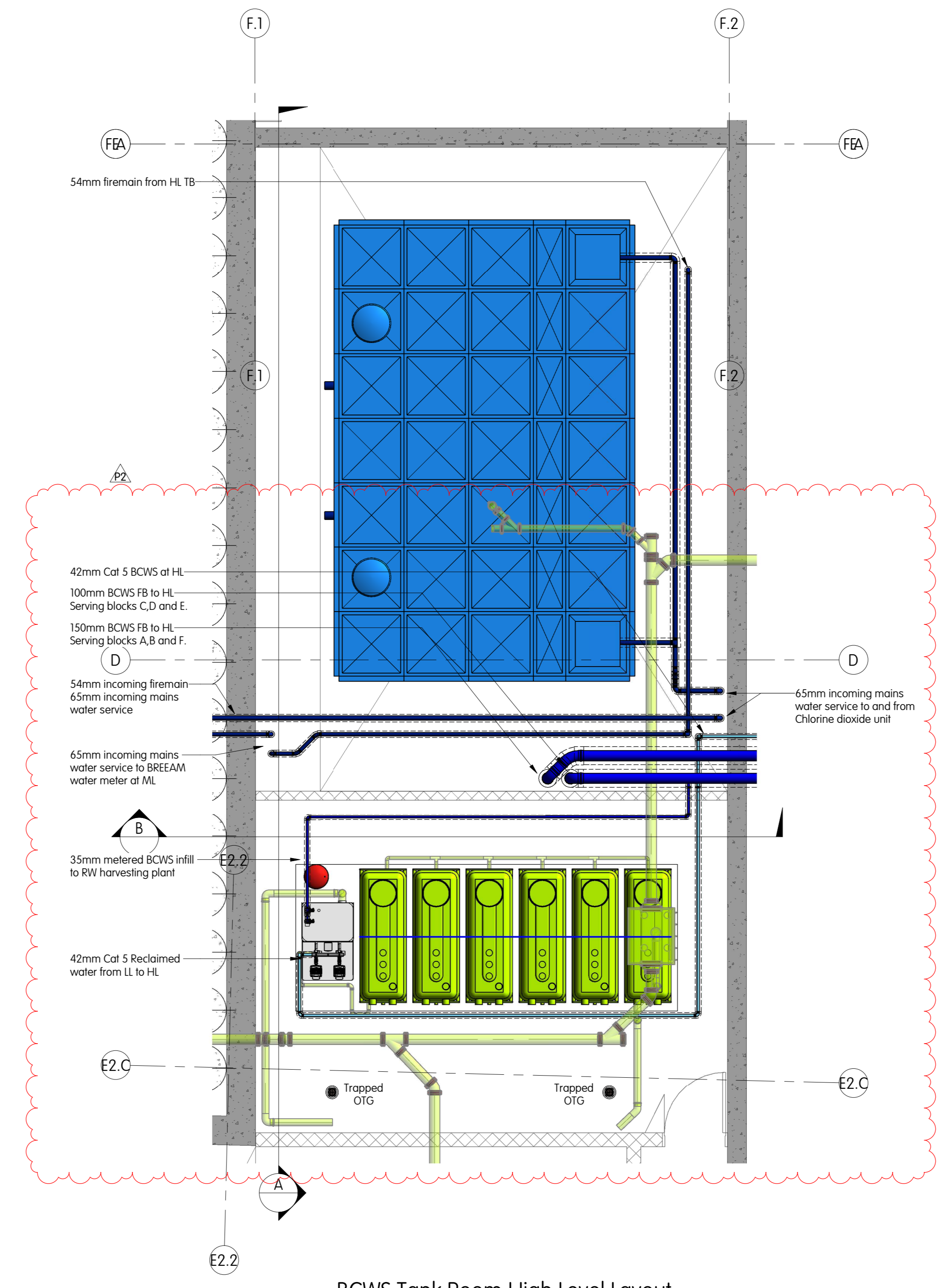

BCWS Tank Room High Level Layout
1:50

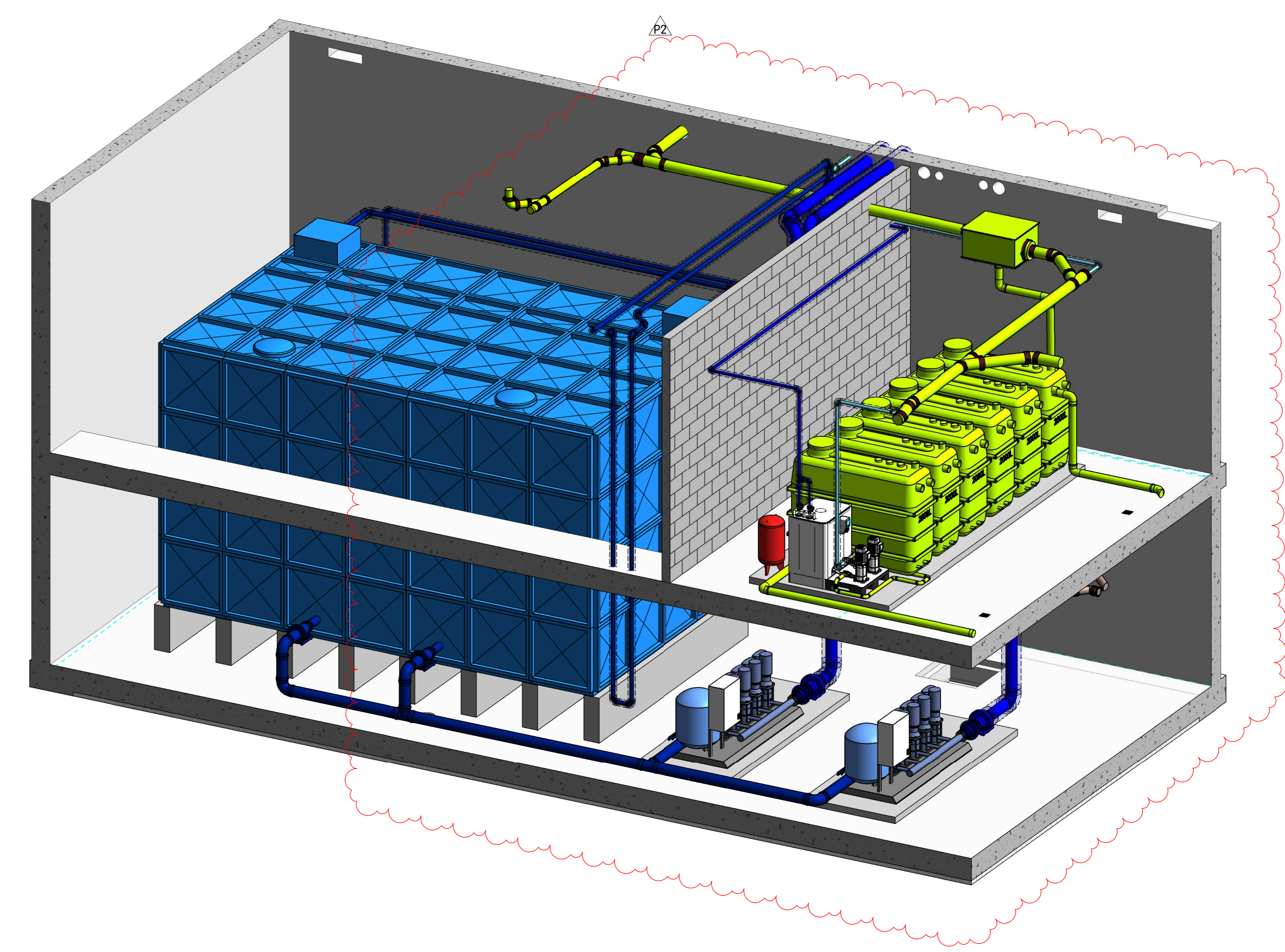

BCWS Tank Room Isometric

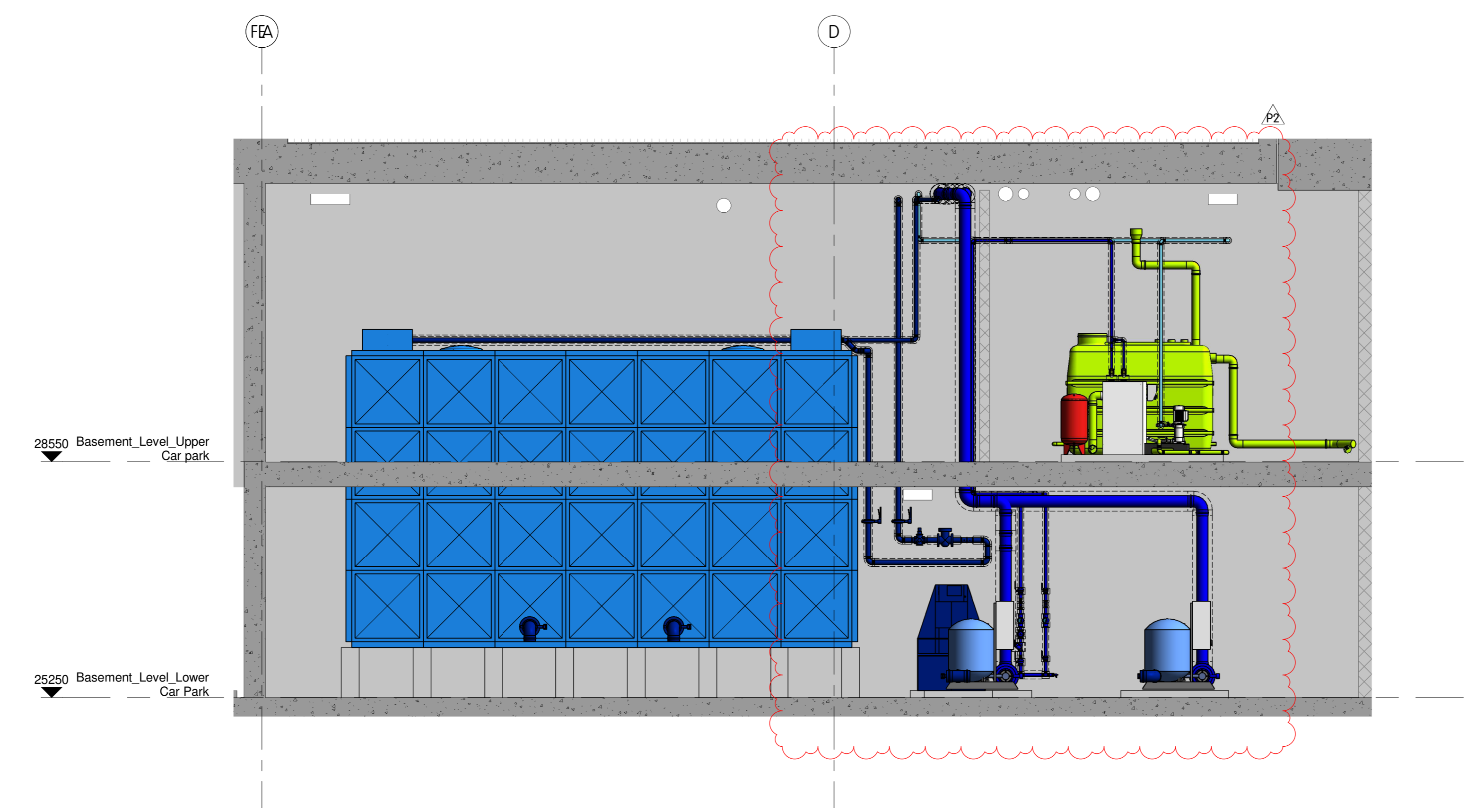

BCWS Tank Room Section A
1:50

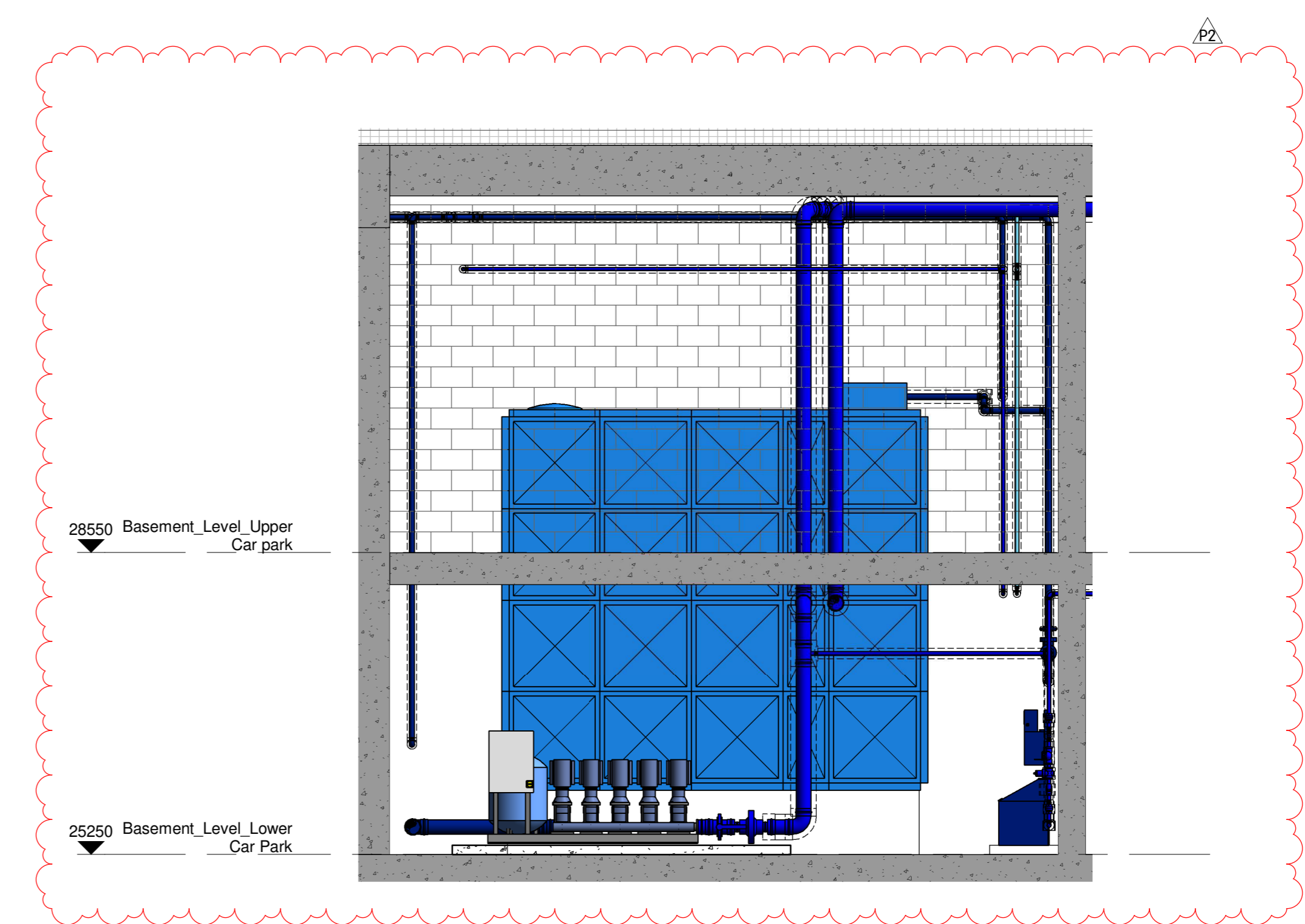

BCWS Tank Room Section B
1:50

Copyright © MTT No copies of this drawing, however produced and/or transmitted may be made or undertaken, without the express permission of MTT. This drawing should not be used. All dimensions to be checked on site. Any discrepancies to be notified to MTT.					
Issue/revision notes	Rev	Date	Description	Drawn	Checked
P2 12.08.2022 Stage 4 Issue	NK	JM			
P1 04.03.2022 Stage 4 Issue	NK	JM			

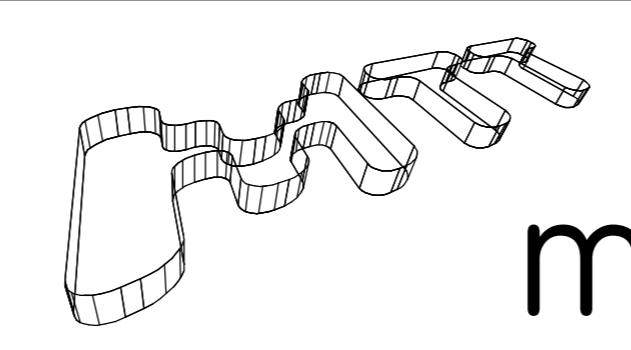

MTT/DRAWING

A 9 KINGSWAY LONDON WC2B 6AF T +44 (0)20 7836 1133 F +44 (0)20 7836 1153 E info@mtt-limited.com W mtt-limited.com	PM T Ward Cad N Keyser Date February 2022 Scale 1:50 @ A0 Status STAGE 4	Camden Goods Yard Public Health Services BCWS Tank Room Layout Dig No: CGY08-MTT-ZZZ-00-DR-P-5000 Revision P2
---	---	---

