

1 CELLULAR OFFICES - LEVEL 5
PLAN - AS PROPOSED 1:20 @ A1

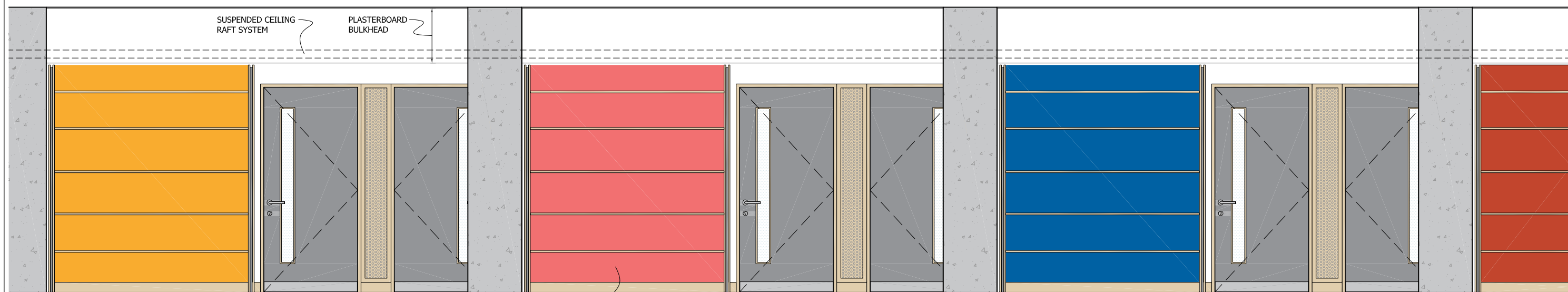

2 CELLULAR OFFICES - LEVEL 5
ELEVATION A - AS PROPOSED 1:20 @ A1

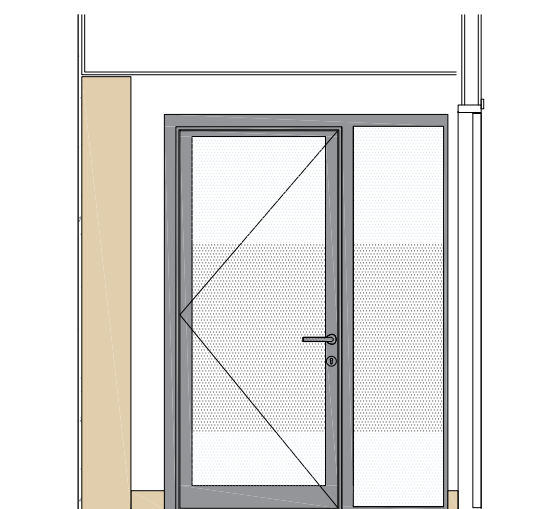

3 CELLULAR OFFICES - LEVEL 5
ELEVATION B - AS PROPOSED 1:20 @ A1

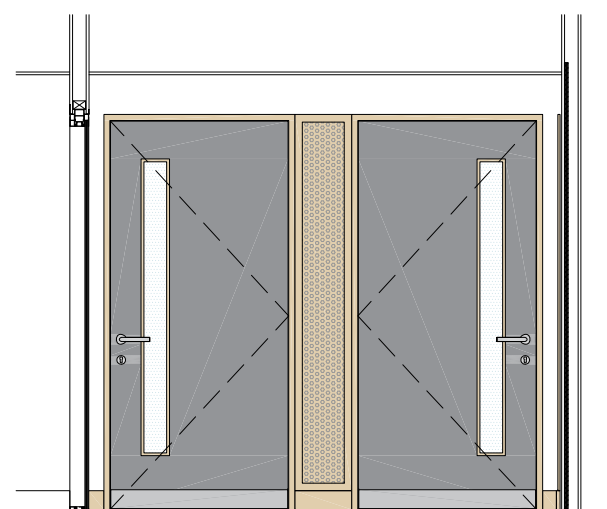

4 CELLULAR OFFICES - LEVEL 5
ELEVATION C - AS PROPOSED 1:20 @ A1

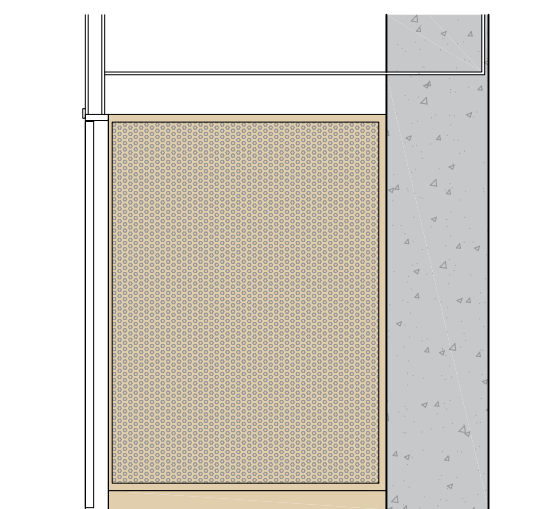

5 CELLULAR OFFICES - LEVEL 5
ELEVATION D - AS PROPOSED 1:20 @ A1

P2	FOR APPROVAL	13.01.2023
Rev	Description	Date



Job title
University College London
Institute of Education
Woburn Square Package
20 Bedford Way, WC1H 0AL

Drawing title
Level 5 - Zone C
Cellular Offices & Consulting Rooms
Proposed Internal Elevations
Planning Application W55

Scale	Date	Drawn
1:20 @ A1	DEC 22	MJR

ARCHITON LLP
 CHARTERED ARCHITECTS - DESIGN
 PLANNING CONSULTANTS - DEVELOPMENT
 BUILDING COST MANAGEMENT
 UPPER DECK TEL: 01372 745600
 17A WEST STREET FAX: 01372 745016
 EPSOM KT18 7RL Email: info@architon.com

Drawing No
3147-W55-0530 - P2
 ARCHITON LLP
 certified to:
 BS EN ISO 9001
 BS EN ISO 14001
 IP Accreditation

PLANNING ISSUE

