

© Architon LLP 2014

This drawing is the property of Architon LLP and must not be divulged to anyone, copied or reproduced, or used for marketing, advertising or promotional purposes without the express written permission of Architon LLP.

All dimensions are to be checked on site and not scaled from this drawing. Contractors must verify all dimensions on site before setting out, commencing work or preparing shop drawings. Any discrepancies on this drawing with other contract documentation to be reported immediately for clarification.



Notes

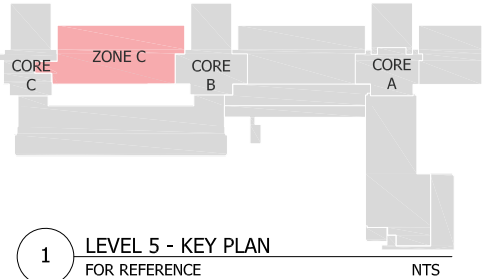

1 LEVEL 5 - KEY PLAN
FOR REFERENCE

NTS

ENSURE NO STRIP OUT, DEMOLITION OR BUILDING WORKS ARE UNDERTAKEN WITHOUT THE REQUIRED LISTED BUILDING AND PLANNING CONSENTS FROM THE LOCAL AUTHORITY AND ENGLISH HERITAGE.

DRAWINGS ARE BASED ON INFORMATION PROVIDED BY UCL.

- DRAWINGS TO BE READ IN CONJUNCTION WITH:-
- ARCHITECTURAL DRAWINGS, SCHEDULES AND SPECIFICATIONS.
 - STRUCTURAL DRAWINGS AND SPECIFICATIONS.
 - M&E DRAWINGS AND SPECIFICATIONS.
 - ACOUSTIC REPORTS.
 - FIRE STRATEGY.

ALL WORKS TO BE FULLY CO-ORDINATED WITH MEP / STRUCTURAL PROPOSALS, AS APPROPRIATE.

ALL SETTING-OUT INFORMATION TO BE CHECKED AGAINST SITE DIMENSIONS

ALL WORKS TO BE IN ACCORDANCE WITH ALL STATUTORY REQUIREMENTS, WHERE AMENDED PROPOSALS DIFFER FROM THOSE APPROVED BY LA, NEW APPROVALS TO BE OBTAINED PRIOR TO COMMENCING WORKS.

FIRE RATED COMPONENTS TO BE IN ACCORDANCE WITH OVER-ARCHING FIRE STRATEGY FOR THE IOE.

ACOUSTIC RATED COMPONENTS TO BE IN ACCORDANCE WITH ACOUSTIC STRATEGY - PREPARED BY B.H.

PLANNING ISSUE

P3 For approval 05.01.2023

Rev Description Date

Client



Job title

University College London
Institute of Education
Woburn Square Package
20 Bedford Way, WC1H 0AL

Drawing title

Level 5 - Zone C
Building Control Plan
Planning Application WSS

Scale

1:100 @A1

Date

NOV 22

Drawn

MJR

ARCHITON LLP

CHARTERED ARCHITECTS - DESIGN
PLANNING CONSULTANTS - DEVELOPMENT
BUILDING COST MANAGEMENT

UPPER DECK
17A WEST STREET
EPSOM KT18 7RL
Email: info@architon.com

TEL: 01372 745600

Drawing No

3147-WSS-0515 P3

ARCHITON LLP
certified to:
BS EN ISO 9001
BS EN ISO 14001
ITP Accreditation

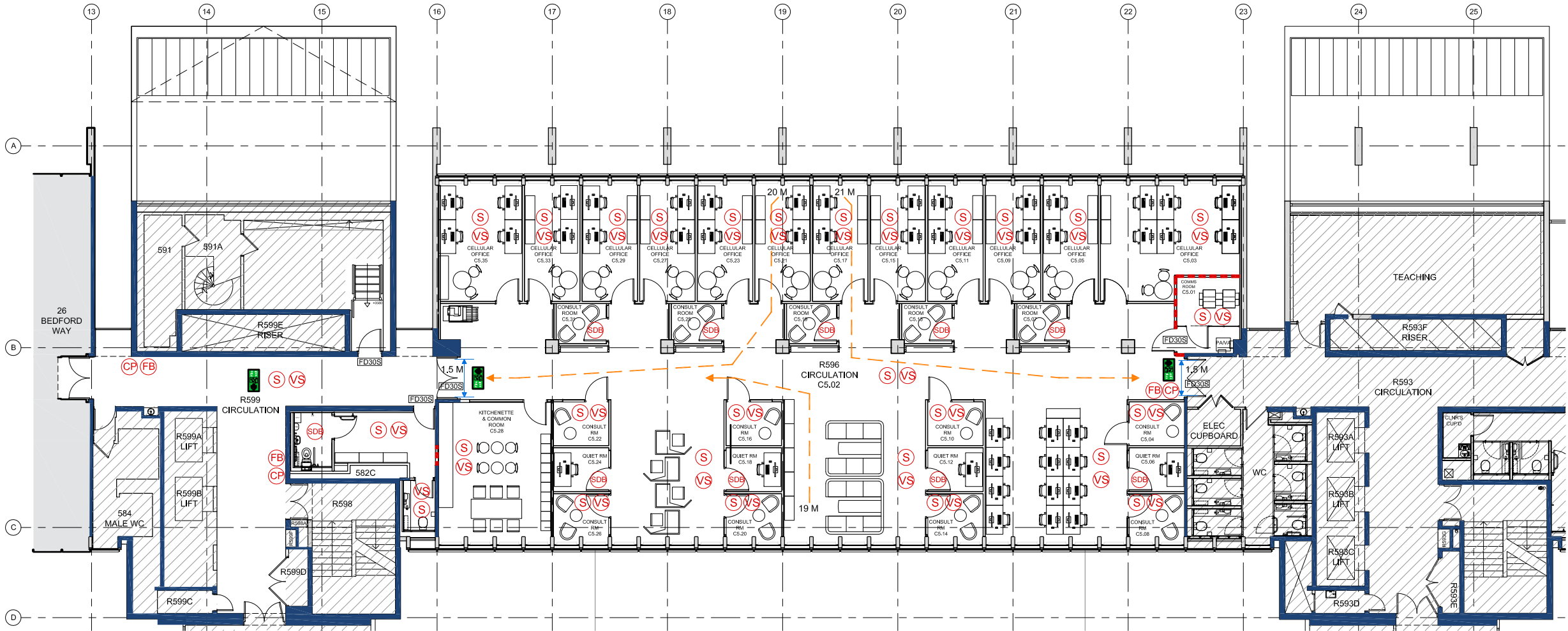

2 LEVEL 5 PLAN - AS PROPOSED

1:100

LEGEND

- AREA OUTSIDE SCOPE OF WORKS, EXCEPT FOR MAKING GOOD WHERE DISTURBED
- MINIMUM 1 HOUR FIRE RATED WALL
- MINIMUM 30 MIN FIRE RATED WALL
- LOCALISED AREAS OF MAKING GOOD AND PATCH REPAIRS TO EXISTING WALLS TO MATCH FIRE STRATEGY
- CEILING HUNG DIRECTIONAL FIRE ESCAPE SIGNAGE
- AREA COVERED BY EMERGENCY LIGHT FITTINGS
- AREAS COVERED BY SMOKE DETECTION
- AREAS COVERED BY HEAT DETECTION
- SMOKE DETECTOR WITH BEACON BASE
- VOICE SOUNDER / SPEAKERS
- FLASHING BEACON
- FLASHING BEACON WITH SOUNDER
- MANUAL FIRE ALARM CALL POINT WITH ISOLATOR
- MULTISENSOR

- DR DRY RISER POSITION
- FD30S FIRE RATED DOORS
NUMBER DENOTES MINIMUM FIRE RATING IN MINUTES
AND S DENOTES INCLUSION OF INTUMESCENT SMOKE SEALS
- DISABLED REFUGE WITH SIGNAGE AND INTERCOM
- 15 M ESCAPE TRAVEL DISTANCE
- 1.5 M ESCAPE WIDTH
- STEP FREE DISABLED ESCAPE
- FAP FIRE ALARM PANEL

NOTE:

FIRE RATING OF NEW ACCESS PANELS TO BE FIRE RATED TO MATCH WALL.

CLEAR WIDTHS DETAILED TBC ON SITE

FIRE RATING TO WALL AND DOORS TO BE IN LINE WITH LATEST FIRE STRATEGY REPORT

1:100 0 1 2 3 4 5m