

This drawing is the property of Architon LLP and must not be divulged to anyone, copied or reproduced, or used for marketing, advertising or promotional purposes without the express written permission of Architon LLP.

All dimensions are to be checked on site and not scaled from this drawing. Contractors must verify all dimensions on site before setting out, commencing work or preparing shop drawings. Any discrepancies on this drawing with other contract documentation to be reported immediately for clarification.

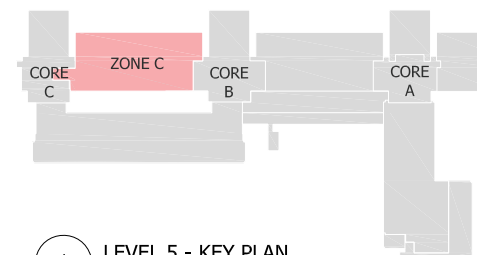

Notes



**1 LEVEL 5 - KEY PLAN**  
FOR REFERENCE

NTS

**ENSURE NO STRIP OUT, DEMOLITION OR BUILDING WORKS ARE UNDERTAKEN WITHOUT THE REQUIRED LISTED BUILDING AND PLANNING CONSENTS FROM THE LOCAL AUTHORITY AND ENGLISH HERITAGE.**

DRAWINGS ARE BASED ON INFORMATION PROVIDED BY UCL.

DRAWINGS TO BE READ IN CONJUNCTION WITH:-

- ARCHITECTURAL DRAWINGS, SCHEDULES AND SPECIFICATIONS.
- STRUCTURAL DRAWINGS AND SPECIFICATIONS.
- M&E DRAWINGS AND SPECIFICATIONS.
- ACOUSTIC REPORTS.
- FIRE STRATEGY.

ALL WORKS TO BE FULLY CO-ORDINATED WITH MEP / STRUCTURAL PROPOSALS, AS APPROPRIATE.

ALL SETTING-OUT INFORMATION TO BE CHECKED AGAINST SITE DIMENSIONS

ALL WORKS TO BE IN ACCORDANCE WITH ALL STATUTORY REQUIREMENTS, WHERE AMENDED PROPOSALS DIFFER FROM THOSE APPROVED BY LA, NEW APPROVALS TO BE OBTAINED PRIOR TO COMMENCING WORKS.

FIRE RATED COMPONENTS TO BE IN ACCORDANCE WITH OVER-ARCHING FIRE STRATEGY FOR THE IOE.

ACOUSTIC RATED COMPONENTS TO BE IN ACCORDANCE WITH ACOUSTIC STRATEGY - PREPARED BY B.H.

**PLANNING ISSUE**

P3	For approval	05.01.2023
Rev	Description	Date

Client  
**overbury**

Job title  
University College London  
Institute of Education  
Woburn Square Package  
20 Bedford Way, WC1H 0AL

Drawing title  
Level 5 - Zone C  
Proposed Partition Types  
Planning Application WSS

Scale	Date	Drawn
1:100 @A1	NOV 22	MJR

**ARCHITON LLP**  
CHARTERED ARCHITECTS · DESIGN · PLANNING CONSULTANTS · DEVELOPMENT · BUILDING COST MANAGEMENT  
UPPER DECK 17A WEST STREET EPSOM KT18 7RL Email: info@architon.com TEL: 01372 745600

Drawing No  
3147-WSS-0507 P3  
ARCHITON LLP certified to:  
BS EN ISO 9001  
BS EN ISO 14001  
IIP Accreditation

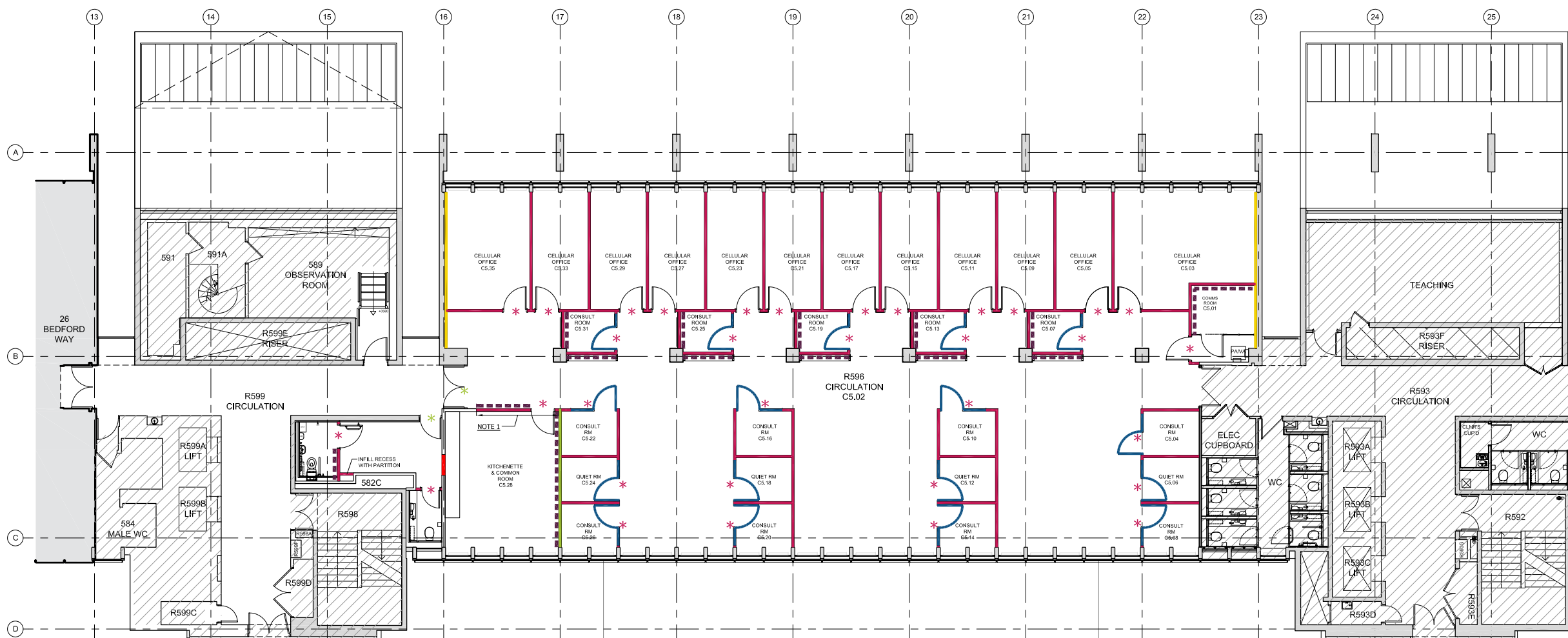

SEE PHASE 2 PROPOSALS FOR FULL DETAILS OF WORKS IN THIS AREA

**2 LEVEL 5 PLAN - PARTITION TYPES**

1:100

**LEGEND**

- AREA OUTSIDE SCOPE OF WORKS FOR WOBURN SQUARE PACKAGE, EXCEPT FOR MAKING GOOD WHERE DISTURBED
- SOLID PARTITION TYPE P2  
GYFWALL SINGLE FRAME  
SYSTEM REF: A206187  
FIRE RATING (INTEGRITY/INSULATION): 90/90  
ACOUSTIC RATING: 53 R<sub>w</sub>DB
- SOLID PARTITION TYPE P3:  
GYFWALL SINGLE FRAME ENHANCED  
SYSTEM REF: Q606064  
FIRE RATING (INTEGRITY/INSULATION): 60/60  
ACOUSTIC RATING: 48 R<sub>w</sub>DB
- GLAZED PARTITION G1:  
OPTIMA REVOLUTION 100 SG  
SYSTEM REF: - OPTIMA REVOLUTION 100 SG  
ACOUSTIC RATING: 40R<sub>w</sub>dB
- WALL LINING TYPE L1:  
SYSTEM REF: - TL-UNIVERSAL B  
GYPROC THERMALINE PIR 53mm ON GYPFRAME  
FIRE RATING (INTEGRITY/INSULATION): N/A  
ACOUSTIC RATING: N/A  
U-VALUE REQUIREMENT: COMPLETE WALL BUILD UP TO ACHIEVE MINIMUM 0.7 W/m<sup>2</sup>K
- PLYWOOD PATRESS WITHIN STUDWORK
- PARTITION WALL INFILL OF DOOR OPENING - TYPE TO SUIT WIDTH OF WALL - TO BE DETERMINED AT SITE SURVEY.

NOTE:  
\* \* CONTRACTOR TO INSTALL PARTITION WALLS ABOVE NEW DOORSETS / GLAZED PARTITIONS, AS APPROPRIATE. TYPE TO SUIT REQUIRED ACOUSTIC AND FIRE PERFORMANCES.  
FIRE PERFORMANCE OF PARTITION WALLS TO STRATEGY BY SPECIALIST FIRE CONSULTANT.  
ACOUSTIC PERFORMANCE OF PARTITION WALLS TO BH ACOUSTIC STRATEGY  
NOTE 1 ALLOW FOR ADDITIONAL PLASTERBOARD / WALL LINING TO NEW PARTITION WALL CONSTRUCTION TO MATCH / LINE WITH DEPTH OF ADJACENT / EXISTING BLOCKWORK WALL.

