

© Architon LLP 2014

This drawing is the property of Architon LLP and must not be divulged to anyone, copied or reproduced, or used for marketing, advertising or promotional purposes without the express written permission of Architon LLP.

All dimensions are to be checked on site and not scaled from this drawing. Contractors must verify all dimensions on site before setting out, commencing work or preparing shop drawings. Any discrepancies on this drawing with other contract documentation to be reported immediately for clarification.



Notes

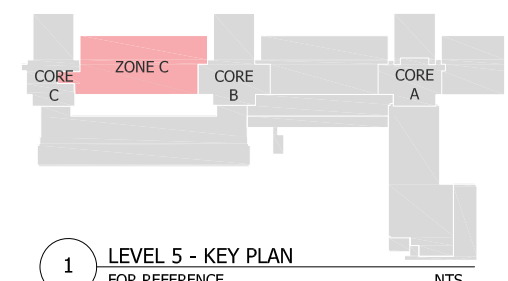

1 LEVEL 5 - KEY PLAN FOR REFERENCE NTS

ENSURE NO STRIP OUT, DEMOLITION OR BUILDING WORKS ARE UNDERTAKEN WITHOUT THE REQUIRED LISTED BUILDING AND PLANNING CONSENTS FROM THE LOCAL AUTHORITY AND ENGLISH HERITAGE.

DRAWINGS ARE BASED ON INFORMATION PROVIDED BY UCL.

- DRAWINGS TO BE READ IN CONJUNCTION WITH:-
- ARCHITECTURAL DRAWINGS, SCHEDULES AND SPECIFICATIONS.
 - STRUCTURAL DRAWINGS AND SPECIFICATIONS.
 - M&E DRAWINGS AND SPECIFICATIONS.
 - ACOUSTIC REPORTS.
 - FIRE STRATEGY.

ALL WORKS TO BE FULLY CO-ORDINATED WITH MEP / STRUCTURAL PROPOSALS, AS APPROPRIATE.

ALL SETTING-OUT INFORMATION TO BE CHECKED AGAINST SITE DIMENSIONS

ALL WORKS TO BE IN ACCORDANCE WITH ALL STATUTORY REQUIREMENTS. WHERE AMENDED PROPOSALS DIFFER FROM THOSE APPROVED BY LA, NEW APPROVALS TO BE OBTAINED PRIOR TO COMMENCING WORKS.

FIRE RATED COMPONENTS TO BE IN ACCORDANCE WITH OVER-ARCHING FIRE STRATEGY FOR THE IOE.

ACOUSTIC RATED COMPONENTS TO BE IN ACCORDANCE WITH ACOUSTIC STRATEGY - PREPARED BY B.H.

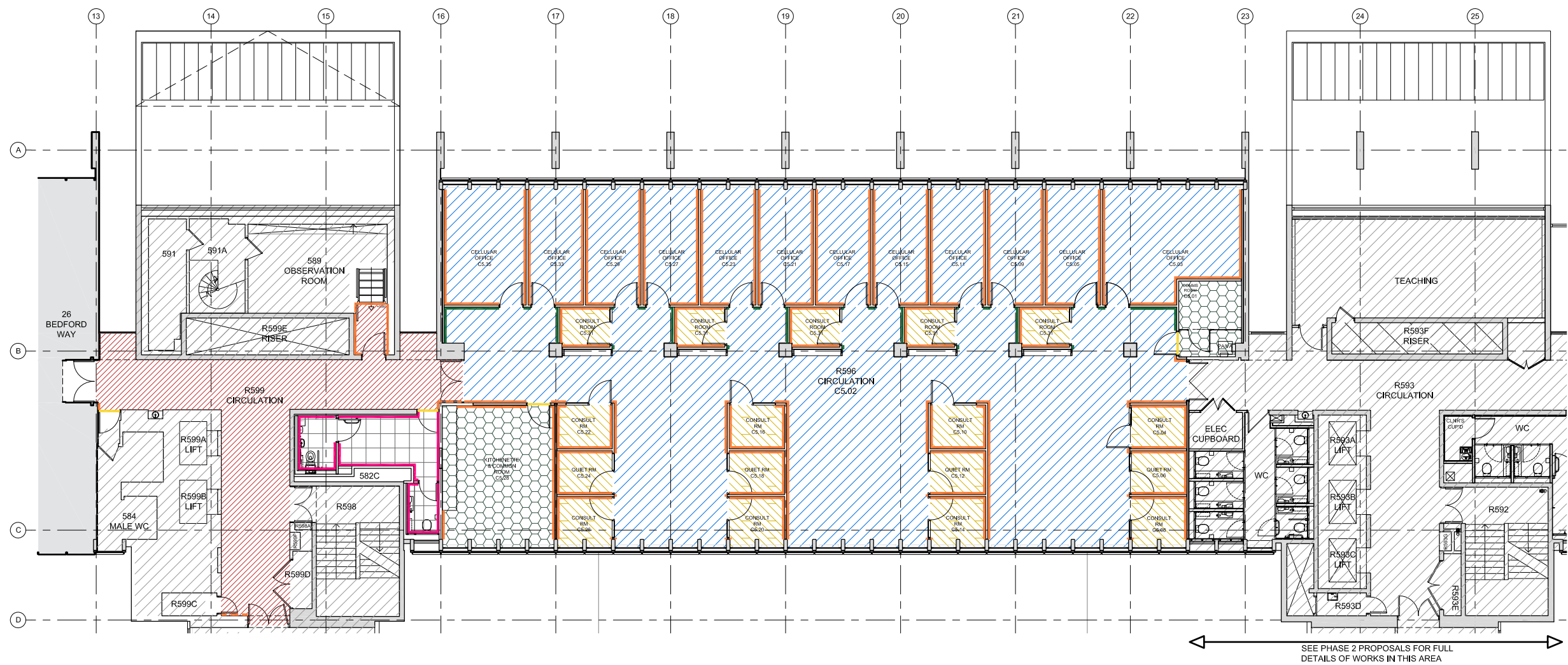

SEE PHASE 2 PROPOSALS FOR FULL DETAILS OF WORKS IN THIS AREA

2 LEVEL 5 PLAN - FLOOR FINISHES 1:100

- LEGEND**
- AREA OUTSIDE SCOPE OF WORKS, EXCEPT FOR MAKING GOOD WHERE DISTURBED
 - SF-02 - CARPET - CORES EGE EPOCA CLASSIC ECT350 COKE - 078278548
 - SF-06 - ANTI-STATIC FLOORING - COMMS ROOM / TEA-POINT / RAMP/ CUPBOARD/ NORAPLAN. SENTICA ED - 6520 - LRV - 36.74
 - SF-08 - CARPET - TEACHING, OFFICES MILLIKEN. CULTURE CANVAS STREET ART - SAT152-79 FLICKS. LRV 11
 - SF-08A - CARPET - MEETING, QUIET & FOCUS ROOMS. MILLIKEN. CULTURE CANVAS STREET ART - SAT124-120 WRITER. LRV 11.6
 - SF-13 - 600x600mm CERAMIC FLOOR TILE DOMUS - MATCH-UP - DCMUX 05 PTV
 - SKIRTING SK-01 - MDF - WHITE PAINTED - PT-04
 - SKIRTING SK-04 - OAK
 - SKIRTING SK-03 - 100x600mm CERAMIC SKIRTING TILE TO MATCH FLOOR
 - FLOOR TRIM / THRESHOLD STRIP
 - REPAINT EXISTING RETAINED TIMBER SKIRTING - WHITE PAINT - PT-04
- GENERAL REQUIREMENTS:**
- ALLOW FOR LEVELING SCREED TO TAKE UP DIFFERENCES / LEVEL SUBSTRATE AS APPROPRIATE INCLUDING WHERE EXISTING WALLS REMOVED AS PART OF DEMOLITION & STRIP-OUT.
 - ALLOW FOR LAYING NEW LATEX SCREED OVER EXISTING CONCRETE SCREED AS SPEC, AS REQUIRED
 - ALLOW FOR LOCAL REPAIR / REPLACEMENT OF EXISTING FLOOR FINISHES, AS APPROPRIATE

PLANNING ISSUE

P3	For approval	05.01.2023
Rev	Description	Date

Client

Job title
University College London
Institute of Education
Woburn Square Package
20 Bedford Way, WC1H 0AL

Drawing title
Level 5 - Zone C
Proposed Floor Finishes
Planning Application W55

Scale 1:100 @A1	Date NOV 22	Drawn MJR
--------------------	----------------	--------------

ARCHITON LLP

CHARTERED ARCHITECTS . DESIGN . PLANNING CONSULTANTS . DEVELOPMENT . BUILDING COST MANAGEMENT

UPPER DECK 17A WEST STREET EPSOM KT18 7RL TEL:01372 745600 Email:info@architon.com

Drawing No
3147-W55-0506 P3

ARCHITON LLP certified to:
BS EN ISO 9001
BS EN ISO 14001
IIP Accreditation

