

Client
Michel Reybier

Structural Engineer

Services Engineer

Consultant

Key plan

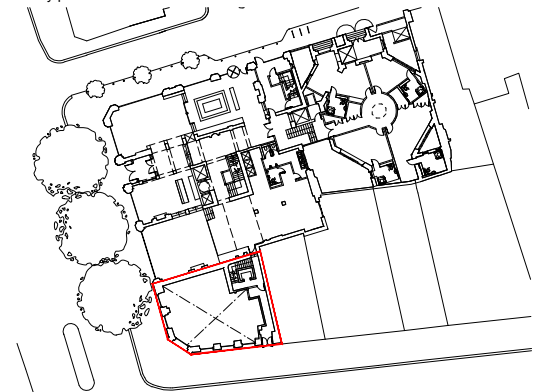

NOTES:

DO NOT SCALE. FIGURED DIMENSIONS ONLY TO BE TAKEN FROM THIS DRAWING. CHECK DIMENSIONS ON SITE AND REPORT DISCREPANCIES TO THE ARCHITECT.

THIS DRAWING IS PROTECTED BY COPYRIGHT.

ALL AREAS HAVE BEEN MEASURED FROM CURRENT DRAWINGS. THEY MAY VARY BECAUSE OF (EG) SURVEY, DESIGN DEVELOPMENT, CONSTRUCTION TOLERANCES, STATUTORY REQUIREMENTS OR RE-DEFINITION OF THE AREAS TO BE MEASURED.

BOUNDARY LINES WHERE SHOWN ARE INDICATIVE ONLY AND TO BE VERIFIED BY THE CLIENT.

P4	23.01.23	Revised stairs layout	CH	BS
P3	04.10.22	Revised existing wall	CH	BS
P2	06.09.22	Revised layout	CH	BS
P1	23.3.22	First Issue	CH	BS
Rev.	Date	Comment	Drawn	Checked

Issue Purpose

PRELIMINARY

tp bennett

One America Street London SE1 0NE | +44 (0)20 2408 2000 | www.tpbenntt.com

Project
118 - 120 High Holborn

Drawing Title
Proposed Basement

Drawn	Date	Scale @ A3	Alt. Ref.
CH	22.3.22	1:100	File

tp bennett Project No.	Drawing Number	Rev
A11566	D 0099	P4