

This drawing is the property of Architon LLP and must not be divulged to anyone, copied or reproduced, or used for marketing, advertising or promotional purposes without the express written permission of Architon LLP.

All dimensions are to be checked on site and not scaled from this drawing. Contractors must verify all dimensions on site before setting out, commencing work or preparing shop drawings. Any discrepancies on this drawing with other contract documentation to be reported immediately for clarification.

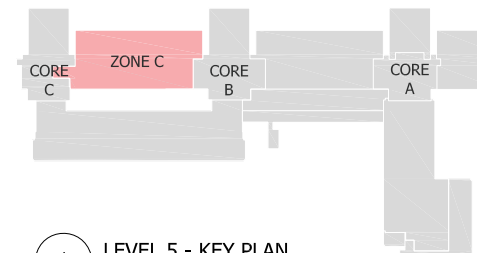

Notes



1 LEVEL 5 - KEY PLAN FOR REFERENCE NTS

ENSURE NO STRIP OUT, DEMOLITION OR BUILDING WORKS ARE UNDERTAKEN WITHOUT THE REQUIRED LISTED BUILDING AND PLANNING CONSENTS FROM THE LOCAL AUTHORITY AND ENGLISH HERITAGE.

DRAWINGS ARE BASED ON INFORMATION PROVIDED BY UCL.

- DRAWINGS TO BE READ IN CONJUNCTION WITH:-
- ARCHITECTURAL DRAWINGS, SCHEDULES AND SPECIFICATIONS.
 - STRUCTURAL DRAWINGS AND SPECIFICATIONS.
 - M&E DRAWINGS AND SPECIFICATIONS.
 - ACOUSTIC REPORTS.
 - FIRE STRATEGY.

ALL WORKS TO BE FULLY CO-ORDINATED WITH MEP / STRUCTURAL PROPOSALS, AS APPROPRIATE.

ALL SETTING-OUT INFORMATION TO BE CHECKED AGAINST SITE DIMENSIONS

ALL WORKS TO BE IN ACCORDANCE WITH ALL STATUTORY REQUIREMENTS, WHERE AMENDED PROPOSALS DIFFER FROM THOSE APPROVED BY LA, NEW APPROVALS TO BE OBTAINED PRIOR TO COMMENCING WORKS.

FIRE RATED COMPONENTS TO BE IN ACCORDANCE WITH OVER-ARCHING FIRE STRATEGY FOR THE IOE.

ACOUSTIC RATED COMPONENTS TO BE IN ACCORDANCE WITH ACOUSTIC STRATEGY - PREPARED BY B.H.

PLANNING ISSUE

P3	For approval	03.01.2023
----	--------------	------------

Rev	Description	Date
-----	-------------	------

Client
overbury

Job title
University College London
Institute of Education
Woburn Square Package
20 Bedford Way, WC1H 0AL

Drawing title
Level 5 - Zone C
Plan - As Proposed
Planning Application W55

Scale	Date	Drawn
1:100 @A1	NOV 22	MJR

ARCHITON LLP
 CHARTERED ARCHITECTS - DESIGN
 PLANNING CONSULTANTS - DEVELOPMENT
 BUILDING COST MANAGEMENT
 UPPER DECK TEL: 01372 745600
 17A WEST STREET
 EPSOM KT18 7RL Email: info@architon.com

Drawing No	ARCHITON LLP certified to: BS EN ISO 9001 BS EN ISO 14001 IIP Accreditation
3147-W55-0505 P3	

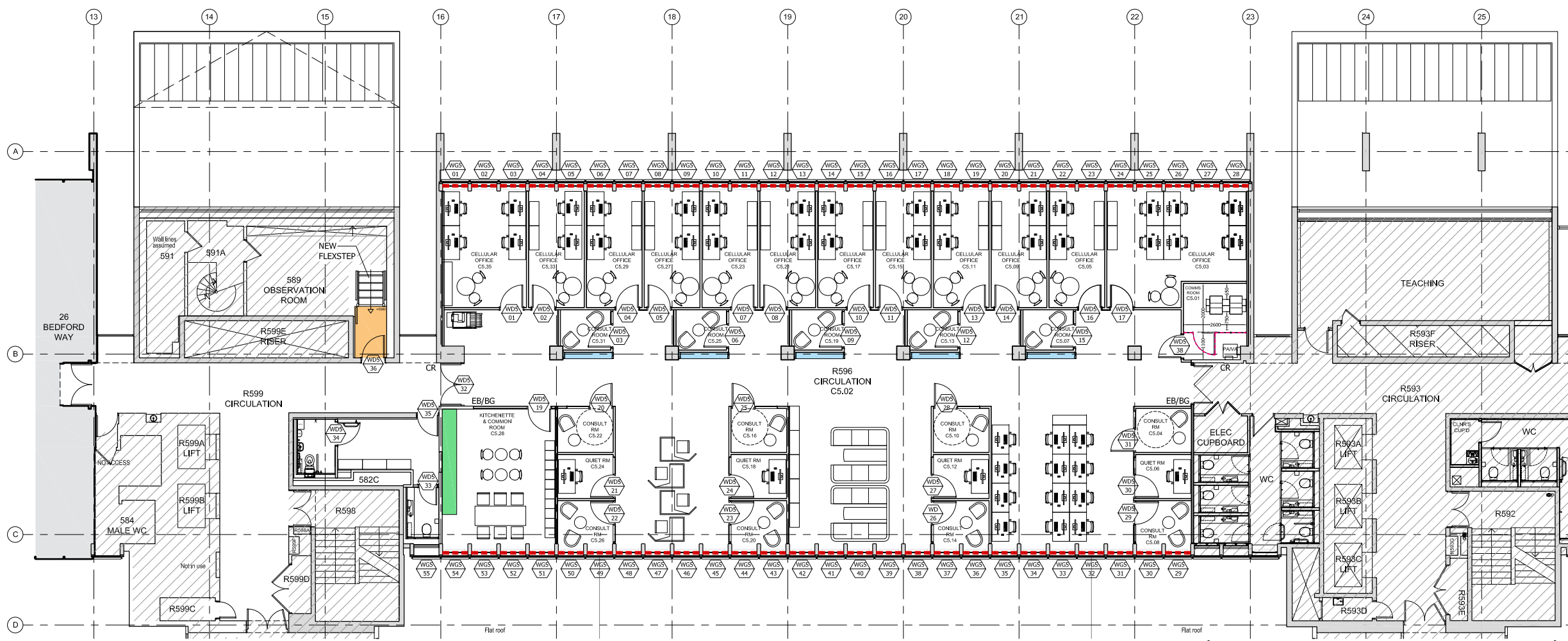
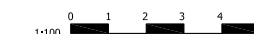

SEE PHASE 2 PROPOSALS FOR FULL DETAILS OF WORKS IN THIS AREA

2 LEVEL 5 PLAN - AS PROPOSED 1:100

- LEGEND**
- AREA OUTSIDE SCOPE OF WORKS FOR WOBURN SQUARE PACKAGE, EXCEPT FOR MAKING GOOD WHERE DISTURBED
 - AREA OF EXISTING CONCRETE FOLLOWING ON SITE VISUAL SURVEY & EXISTING DRAWINGS PROVIDED BY CLIENT. EXTENT TO BE CONFIRMED ON SITE.
 - NEW DOOR REFERENCE NUMBER
 - NEW SECONDARY GLAZING & REFERENCE NUMBER
 - NEW TEAPOINT. SEE DRG 3147-W55-0520
 - CR CARD READER
 - EB/BG EXIT BUTTON / BREAK GLASS
 - NEW LANDING - TO INCLUDE BALUSTRADE TO OPEN SIDE. ALL WORKS ASSOCIATED WITH INSTALLATION INCLUDING ANY REQUIRED TO INTEGRATE NEW FLEXSTEP TO BE REVIEWED AND CONFIRMED.
 - NEW FIXED SHELVING / JOINERY, SEE DRG 3147-W55-0530
 - NEW LOCKABLE MESH SCREEN WITH & GATE