

100mm 3.5N  
'TRIDURALITE SIBERD'  
INNER-SKIN, PLN  
4" STOCK BRICK  
OUTER SKIN.  
FULLY-TIED  
USG VERTICALLY  
900 HORIZONTALLY  
USING BRICK HEADERS  
STOCK BRICK SKIN  
TO BE TRADITIONALLY  
BONDED TO MATCH  
EXISTING.  
OUTSIDE OF  
MANDARIN ENVELOPE,  
WALL TO BE SOLID  
BRICKWORK 9".  
PLN & SCREW STANCHIONS  
STEEL TIES WHERE  
FIXING TO EXISTING  
MASONRY. DO NOT  
POOR-BOND.

SCHEDULE OF ELEMENTS

COLUMNS	
CI	60x60x3.6 SHS
PADSTONES	
PS.1	450 L x 100W x 215 H
PS.2	SINGLE CLASS B ENG. BRICK
(*)	30x5 GMS STRAPS x 1200mm LONG BETWEEN WALLS & FLOOR JOISTS (REF. STRUCTURAL SPECIFICATION G20)

THIRD FLOOR PLAN

FOR TENDER

This drawing is to be read in conjunction with all other Longdin Engineering drawings and specifications, and all other relevant designers' and specialists' information. Do not scale this drawing. Setting-out to architect's drawings only. All temporary support works by contractor.

Project No	Drawing	Rev	Date
21152	001	[D]	01.2022
Project	14 NEW END SQUARE		

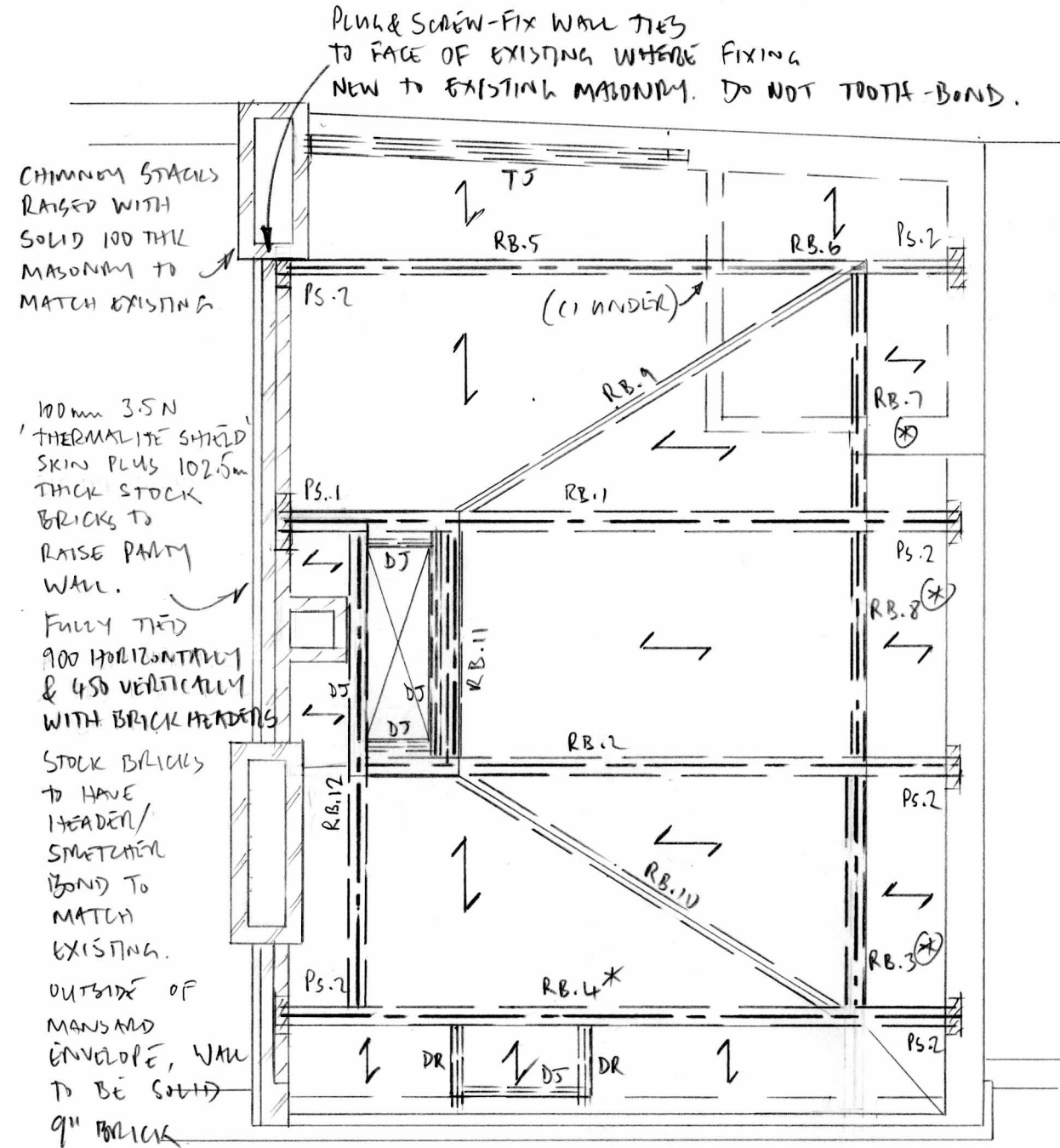

ROOF PLAN

SCHEDULE OF ELEMENTS

RAFTERS	
RB.1	152x152x30 UC [CRANKED]
RB.2	152x152x30 UC [CRANKED]
RB.3	152x89x16 UB
RB.4	152x152x30 UC [CRANKED] *
RB.5	152x89x16 UB
RB.6	"
RB.7	"
RB.8	"
RB.9	"
RB.10	"
RB.11	"
RB.12	152x152x30 UC [CRANKED]
PURLINS	
Ps.1	450L x 100W x 215 H
Ps.2	SINGLE CLASS B ENG BRICK
JOISTS & RAFTERS	
TJ	50x150 C24 @ 400 c/c
DJ	DOUBLED 50x150 C24
TJ	TRIPLED 50x150 C24

\* ALTERNATIVE SECTION:  
140x140x12.5 SHS

(\*) ALTERNATIVE SECTION:  
120x120x10 SHS

FOR TENDER