

TYPICAL PROPOSED TIMBER SASH
Elevation

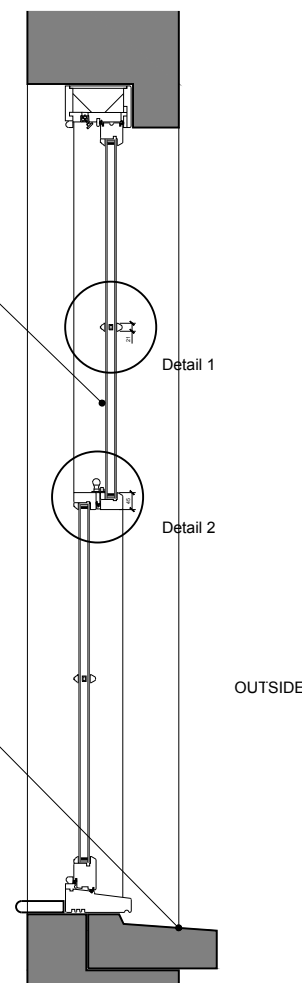

TYPICAL PROPOSED TIMBER SASH
Section

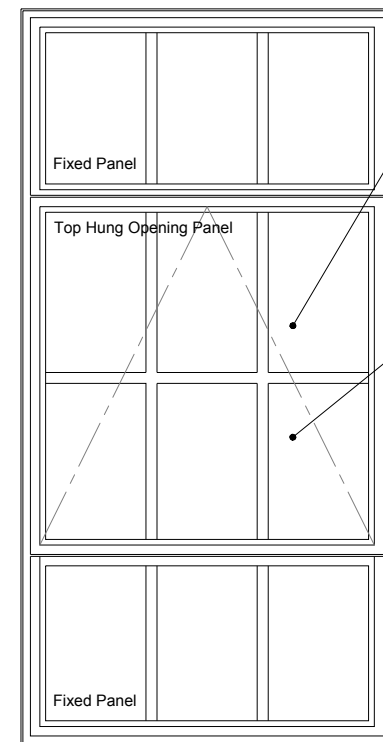

TYPICAL PROPOSED METAL WINDOW
Elevation

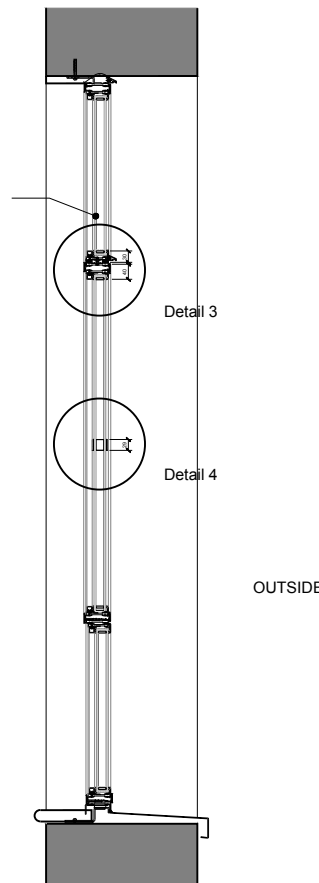

TYPICAL PROPOSED METAL WINDOW
Section

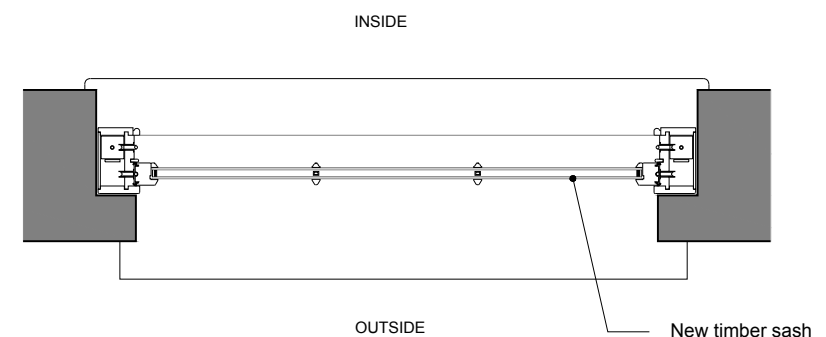

TYPICAL PROPOSED TIMBER SASH
Plan

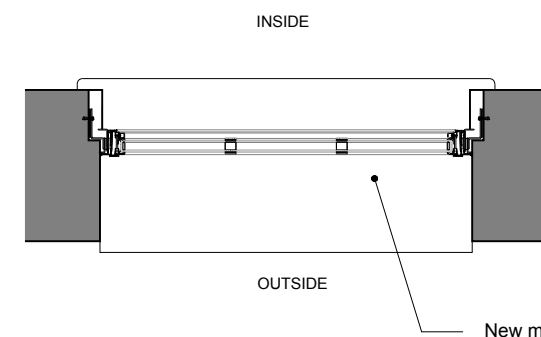
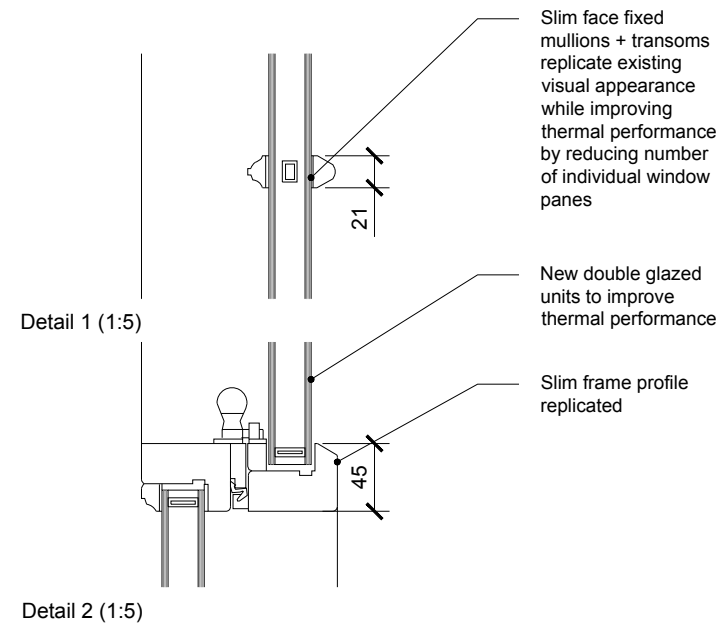

TYPICAL PROPOSED METAL WINDOW
Plan

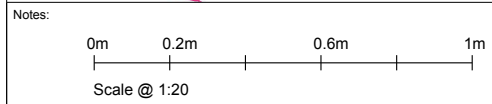
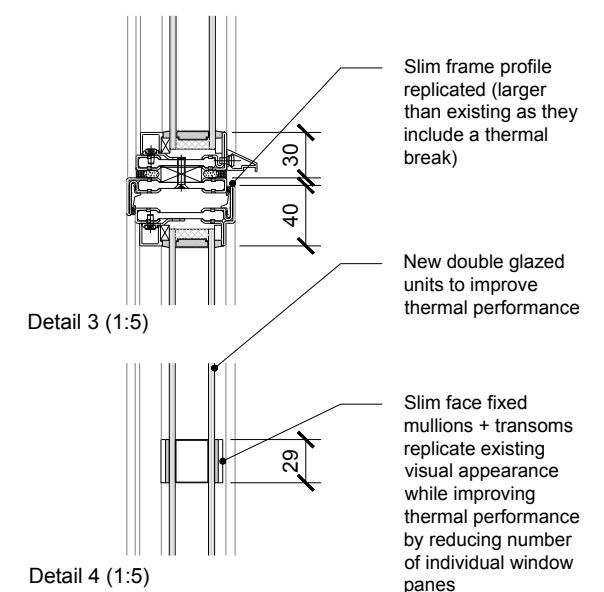

Existing single glazed timber sash REPLACED with double glazed timber sash.

Existing single glazed metal framed windows REPLACED with double glazed, thermally broken double glazed metal framed windows.

Both types of windows replace the multi-paned units with single paned units with new face fixed mullions to replicate the original. This is done to ensure current U-Values are met.

General: 1. Do not scale drawings. Dimensions govern. 2. All dimensions are in millimeters unless noted otherwise. 3. All dimensions shall be verified on site before proceeding with the work. 4. Architect shall be notified in writing of any discrepancies.

/	23.12.22	Planning - Draft	Drawing Title	Caitriona Casey - Architect caitriona@caitrionacasey.com +44 (0)7843958169		
A	09.01.23	Planning	PROPOSED TYPICAL WINDOW DETAILS	Issue Date	Scale @ A3	Scale @ A1
			Client	09.01.23	1:20 + 1:5	/
			Job Title	Drawing No	Rev	Status
			2210 65 Clerkenwell Road, EC1R 5BL	2210 04.01	A	Planning