

Section

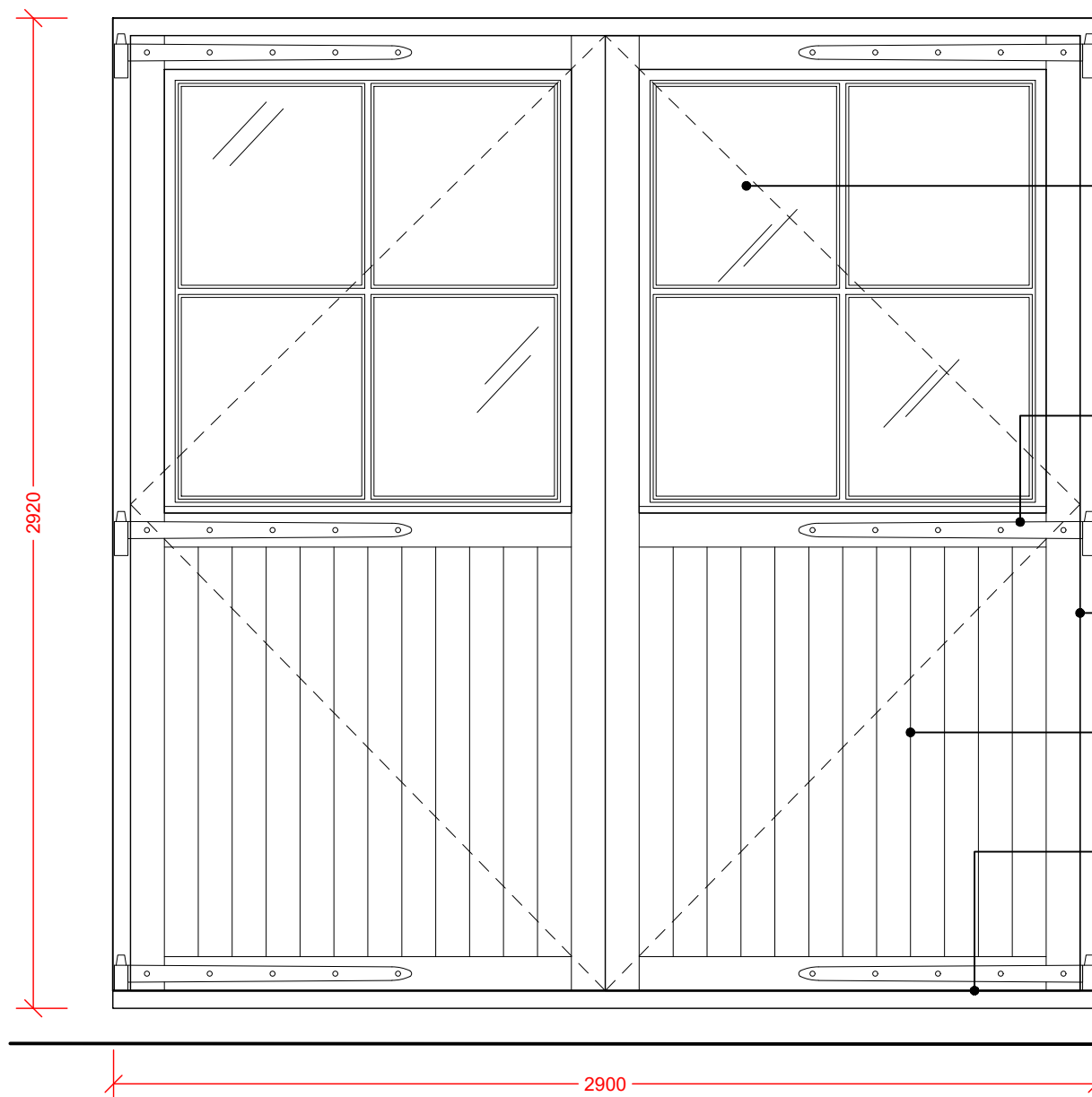
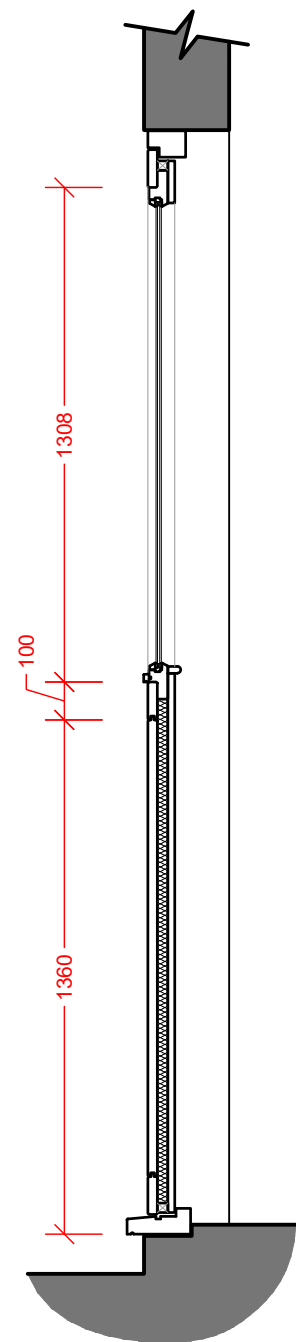

New slimlite DG fixed glazing to max 50% of existing doors

Existing hinges to be reconditioned and re-used.

New frame with weather stripping

Door style to be retained

Additional timber sill to be used

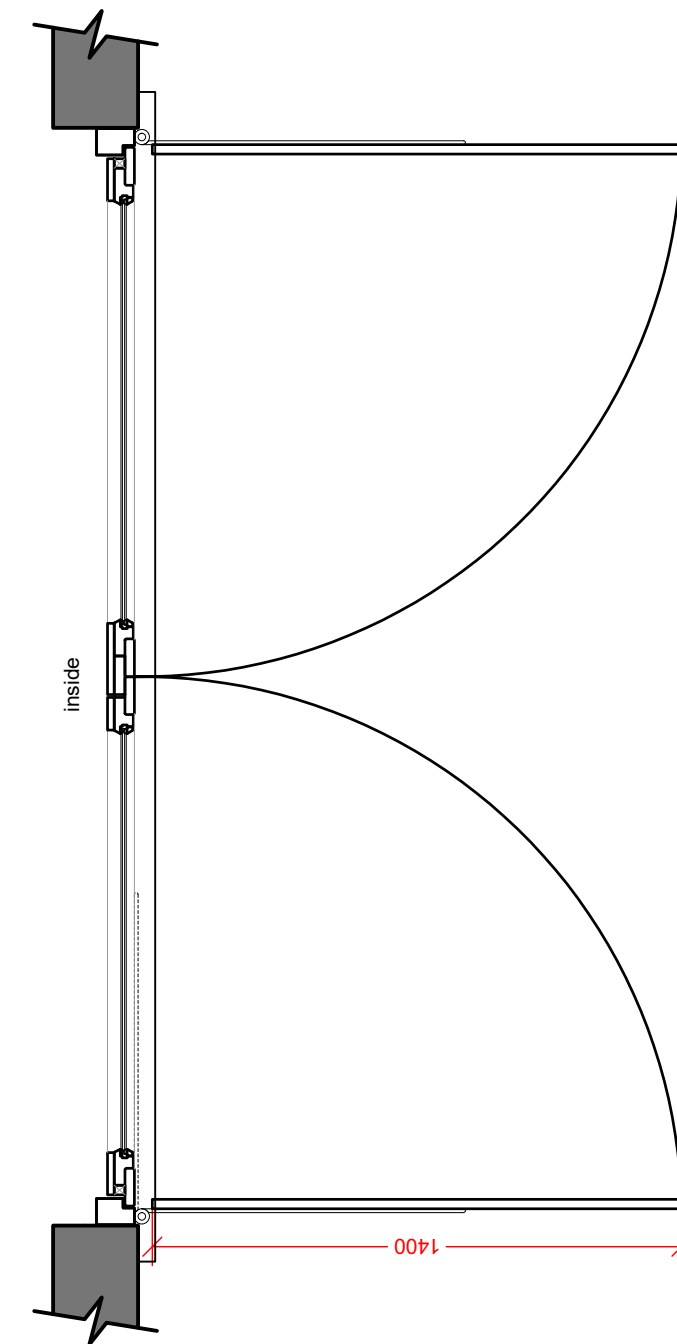

Plan

Elevation

**PLANNING**

LATIMER ARCHITECTURE  
ARCHITECT  
INTERIOR DESIGNERS  
PLANNING &  
CONSTRUCTION  
CONSULTANT

34 Plover way, Rotherhithe  
LONDON - SE16 7TT  
United Kingdom  
t: 07792315978  
www.latimerarchitecture.com  
  
The Old Dispensary  
Prioryland - Duleek  
Co. Meath - A92 WD96  
Republic of Ireland  
t: 041 9880073  
e: design@latimerarchitecture.com

REVISION:	DESCRIPTION:	DATE:
P1	Issued to local planning authority	06.01.2023

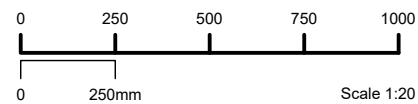

All dimensions to be checked on site prior to construction or manufacture. Do not scale from this drawing. Refer also to written specification of works where applicable. Any discrepancies to be verified with consultant prior to commencement of works.

This drawing is the property of William Latimer. They reserve copyright, and the drawing issued on the condition that it is not retained by any unauthorized person. It may not be reproduced or disclosed, either wholly or in part without written consent from William Latimer.

Architect ARB 090775H - RIAI 18238

PROJECT: Renovation & Extension  
12 Millfield Ln, London N6 6JD  
CLIENT: Charles Bear & Helen Niland  
DRAWING: Coach house doors  
PROPOSED  
DATE: November 2022 SCALE: 1:20@ A3  
DWG. NO: 1044-011 REVISION: P1