

Appendix D – Site investigation

For

28, Charlotte Street

Fitzrovia

London W1T

rodriguesassociates

1 Amwell Street

London

EC1R 1UL

Telephone 020 7837 1133

www.rodriguesassociates.com

October 2022

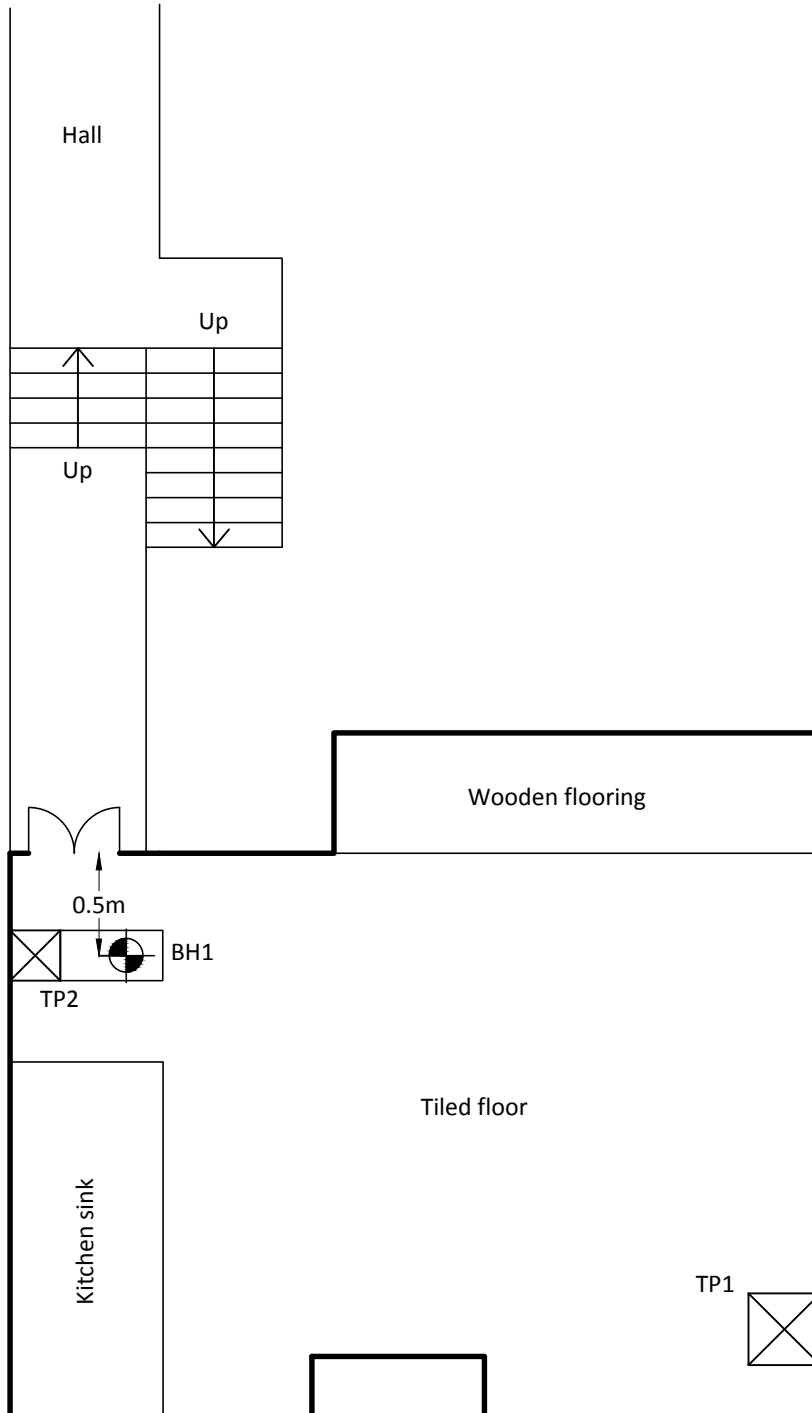

Client: Hammond & Hammond Ltd	Scale: NTS	Sheet: 1 of 1	Date: 04.01.16	
Location: 28 Charlotte Street, London W1T 2NA	Job No: 6262	Weather: Internal	Drawn by: JP	Checked by: JH



Notes:

Key:

Borehole	Trial Pit

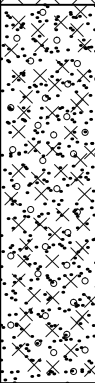
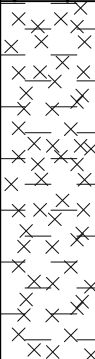
Client: Hammond & Hammond Ltd		Scale: N.T.S.		Sheet No: 1 of 1		Weather: Internal		Date: 11.01.16	
Site: 28 Charlotte Street, London W1T 2NA		Job No: 6262		Borehole No: 1		Boring method: CFA 100mmØ Secondman			
Depth Mtrs	Description of Strata	Thick-ness	Legend	Sample	Test Type	Result	Root Information	Depth to Water	Depth Mtrs
GL	TERRACOTTA TILES OVER CONCRETE	0.25		D			No roots observed.		0.25
0.25	MADE GROUND: medium compact dark brown silty gravelly sand sand with numerous brick concrete and slate pieces and fragments whole and half brick pieces. Becoming slightly moist from 1.8m.	2.55		D				0.5	
				D	M	12 18 15 16		1.0	
1.8				D	M	8 12 17 15		2.0	
				D		15		2.5	
2.8	MADE GROUND: medium compact moist dark brown sandy gravelly silt with occasional brick fragments.	2.5		D	M	13 15 15 15		3.0	
				D		15		3.5	
				D	M	12 15 17 17		4.0	
				D		17		4.5	
5.3	SUSPECT NATURAL: wet medium dense mid grey silty gravelly SAND.	2.4		D	M	13 11 18 12		5.3	5.0
				D		12	5.5		
				D	M	21 18 28 28	6.0		
				D		26	7.0		
7.7	Very stiff mid grey silty CLAY with partings of grey and brown silt and fine sand.	2.3		D	V	130+ 130+	8.0		
				D	V	130+ 130+	9.0		
10.0	BOREHOLE ENDS AT 10.0m.			D	V	130+ 130+			10.0

Drawn by: DB

Approved by: JH

Key:

- D Small disturbed sample
- V Pilcon Vane (KPa)
- M Mackintosh Probe

Remarks: Groundwater strike at 5.3m.
Borehole wet and collapsed at 4.7m on completion.
Metal standpipe installed to 9.0m.

Client: Hammond & Hammond Ltd	Scale: NTS	Sheet No: 1 of 1	Date: 04.01.16
Location: 28 Charlotte Street, London W1T 2NA	Job No: 6262	Trial Pit No: 1	Weather: Internal
Excavation Method: Hand tools		Drawn by: JD	Checked by: JH

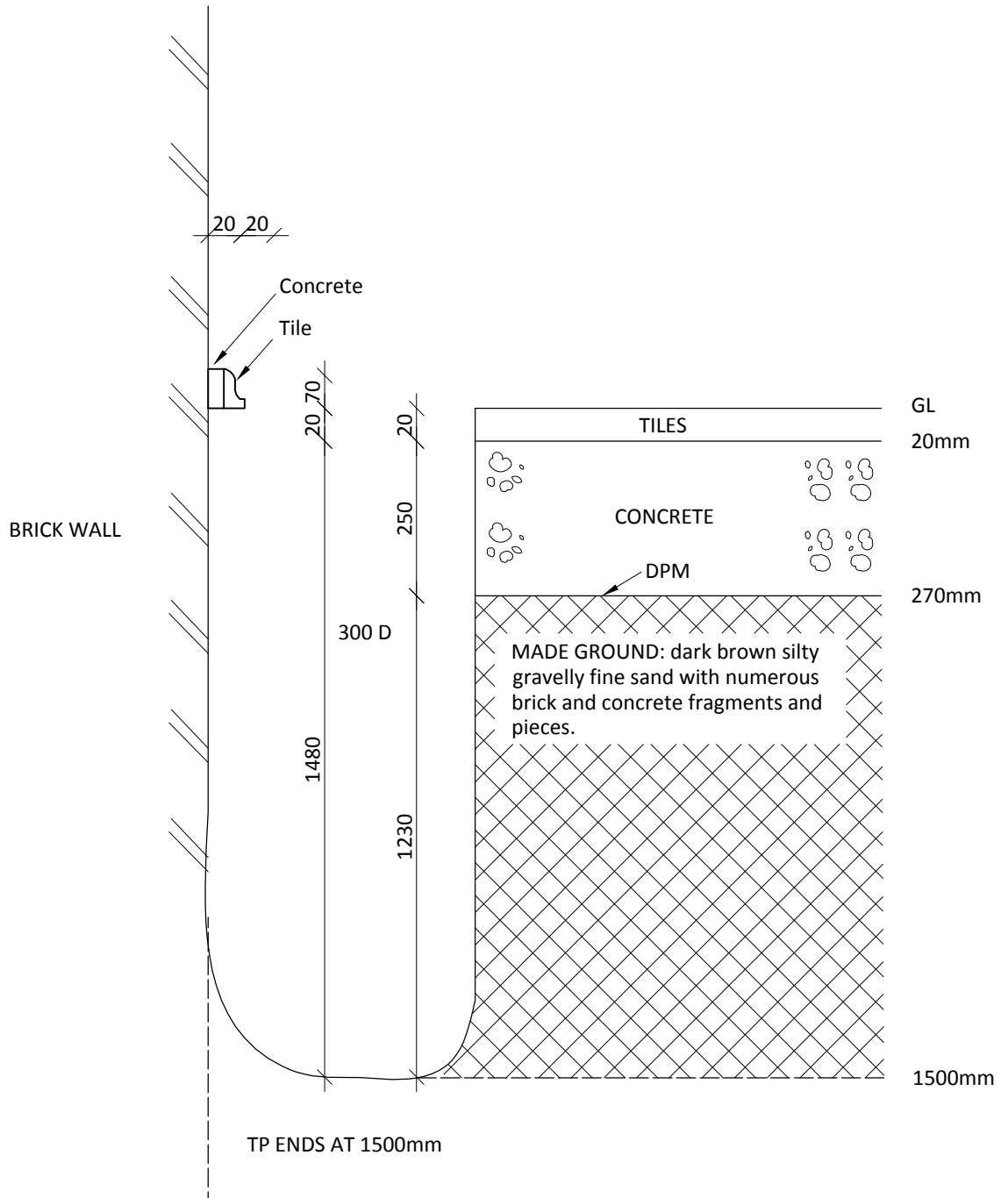

Remarks:	Key: D Small disturbed sample
-----------------	---

Client: Hammond & Hammond Ltd	Scale: NTS	Sheet No: 1 of 1	Date: 04.01.16
Location: 28 Charlotte Street, London W1T 2NA	Job No: 6262	Trial Pit No: 2	Weather: Internal
Excavation Method: Hand tools		Drawn by: JD	Checked by: JH

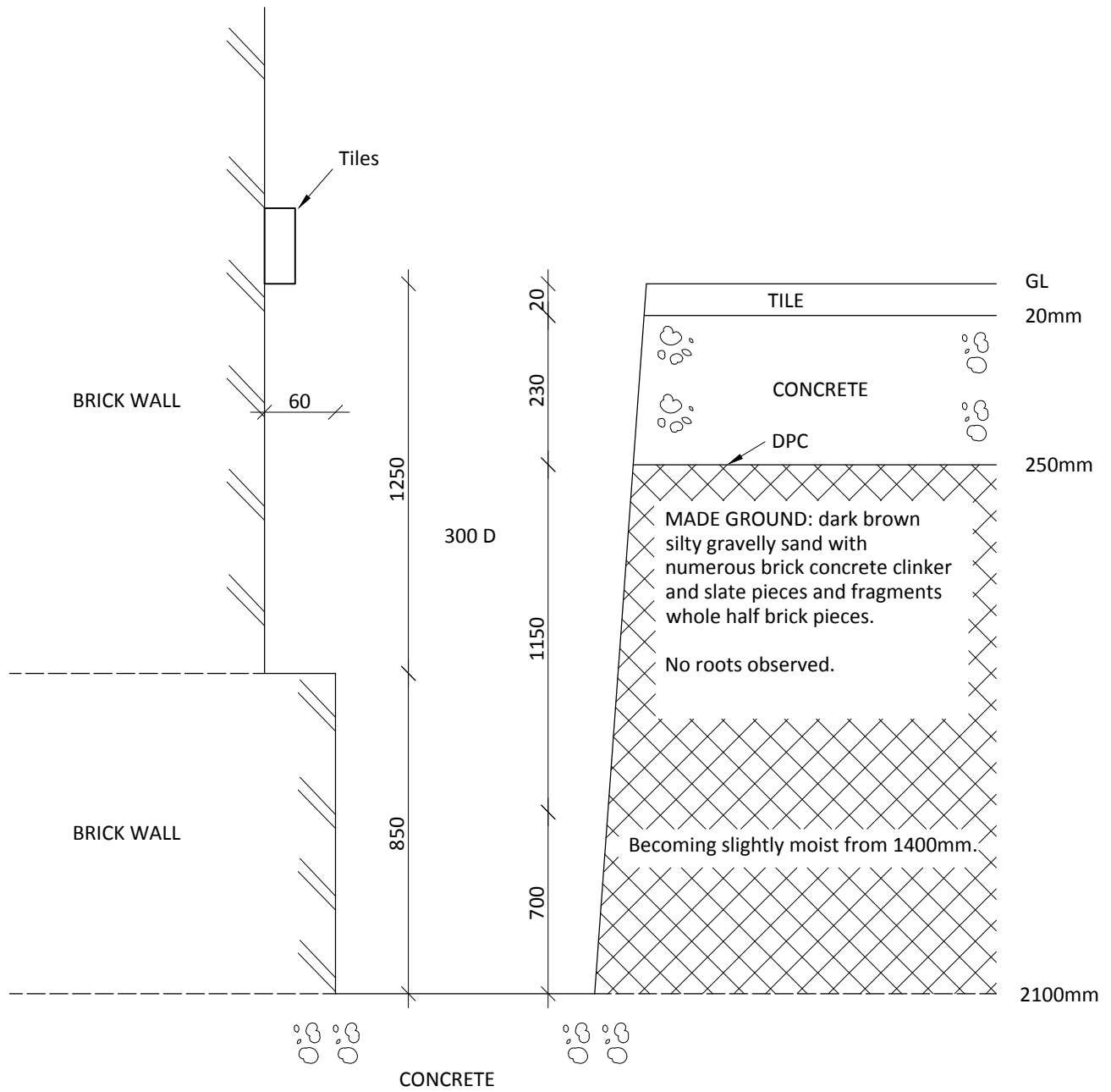

TRIAL PIT ENDS AT 2100mm
UNABLE TO LOCATE U/S.

Remarks:	Key:
-----------------	-------------