

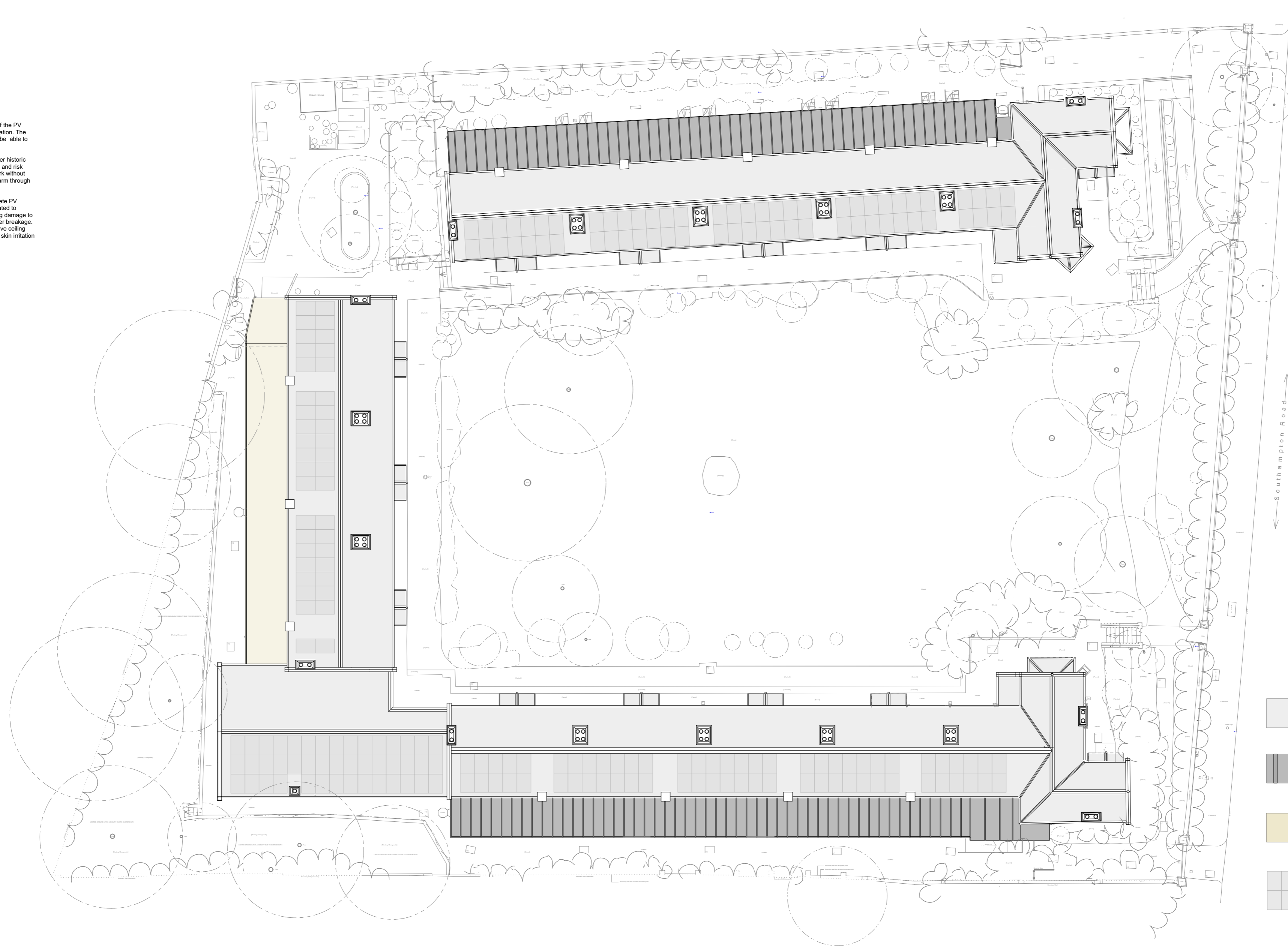





Check the structural loadability of the PV system before starting the installation. The roof and loadbearing walls must be able to support the additional weight.

No rooflights are present, however historic slates require specific evaluation and risk assessment for operatives to work without causing damage to the roof or harm through slate breakage.

Access to the attic void to complete PV electrical installation to be evaluated to prevent risk to operatives causing damage to the ceiling or harm through plaster breakage. Existing glassfibre insulation above ceiling level likely to create breathing or skin irritation



-  existing Welsh slate roof tiles with lead flashings and terracotta ridge tiles
-  existing zinc standing seam flat roofing, zinc flashings
-  existing bituminous asphalt roofing
-  Black framed 330W solar panels nominal size 1680 x 990mm mounted on RenuSol single rail PV support system retaining existing slate roof covering in-situ with minimal notching to slates adjacent to each fixing point