

NOTES
 These plans and specifications prepared by FIMA Architecture and Planning as instruments of professional service shall remain the property of FIMA Architecture and Planning.
 These plans may not be copied or re-used without the express written consent of FIMA Architecture and Planning. The use of these plans for construction is permitted only when specifically released for construction reference by a dated authorial signature.
 These plans are project and site specific and shall only be used for their intended purpose unless otherwise permitted by written consent of FIMA Architecture and Planning.
 All dimensions shown are indicative and must be double checked on site by the contractor. All work must comply with relevant British Standards and Building Regulations requirements. Any inconsistencies found must be reported to FIMA Architecture and Planning.
 DO NOT SCALE FROM THE DRAWING

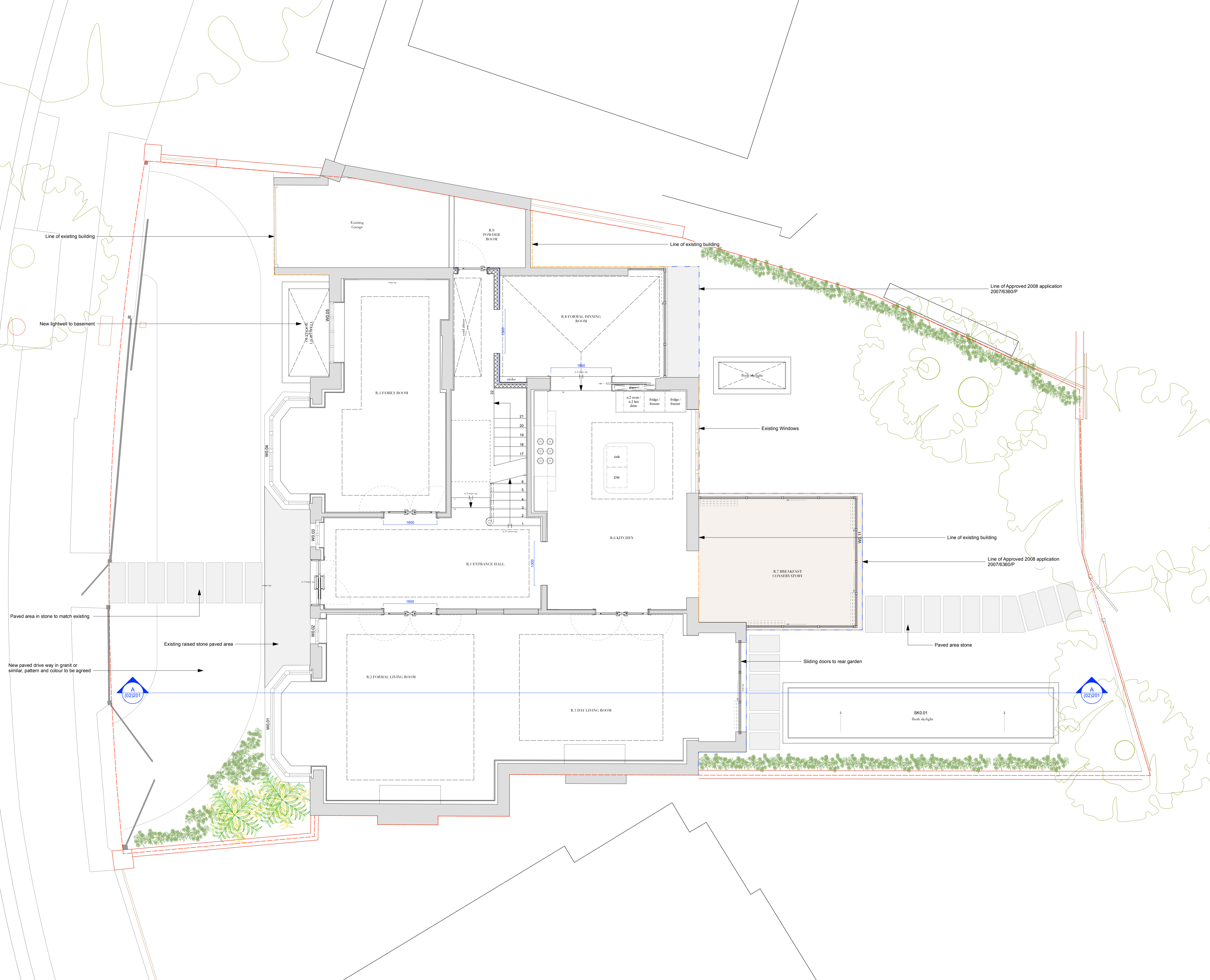
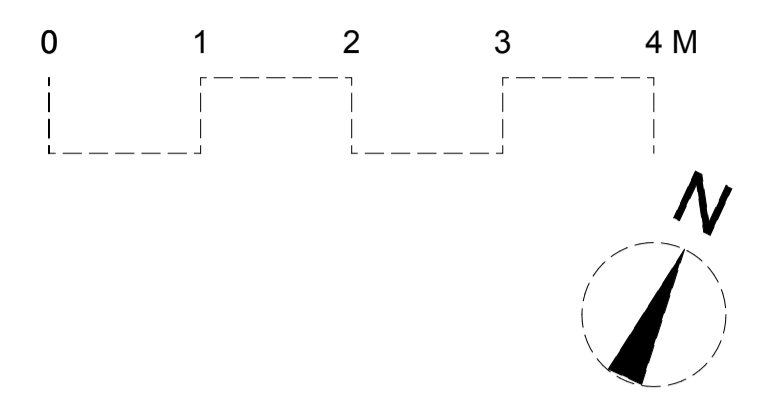

Key:

	Site Boundary		Existing Structure
	Approved Planning outline 2008		New structure
	Existing Outline		Demolition

F I M A
 FIMA Architecture and Planning Ltd | Flat 4, 30 Sutherland Avenue, W9 2HG, London
 +44 (0) 20 3172 5331 | +44 (0) 777 529 5818 | www.fimaarchitects.com | info@fimaarchitects.com

project:	2 Wadham Gardens, NW3 3DP, London	project no:	2105
drawing:	Proposed Ground Floor	scale:	1:50 @ A1
drawing no.:	2105(02)000	drawn by:	Giuseppa M.
rev:	A	date:	December 21
		dwg status:	information

Rev	Date	Notes
-	19.12.22	Issue to Camden Council
A	04.01.22	Issue to Camden Council, removed underground parking and car lift