

Eton Place

Haverstock Hill

Eton College Road

Chalk Farm Station

Adelaide Road

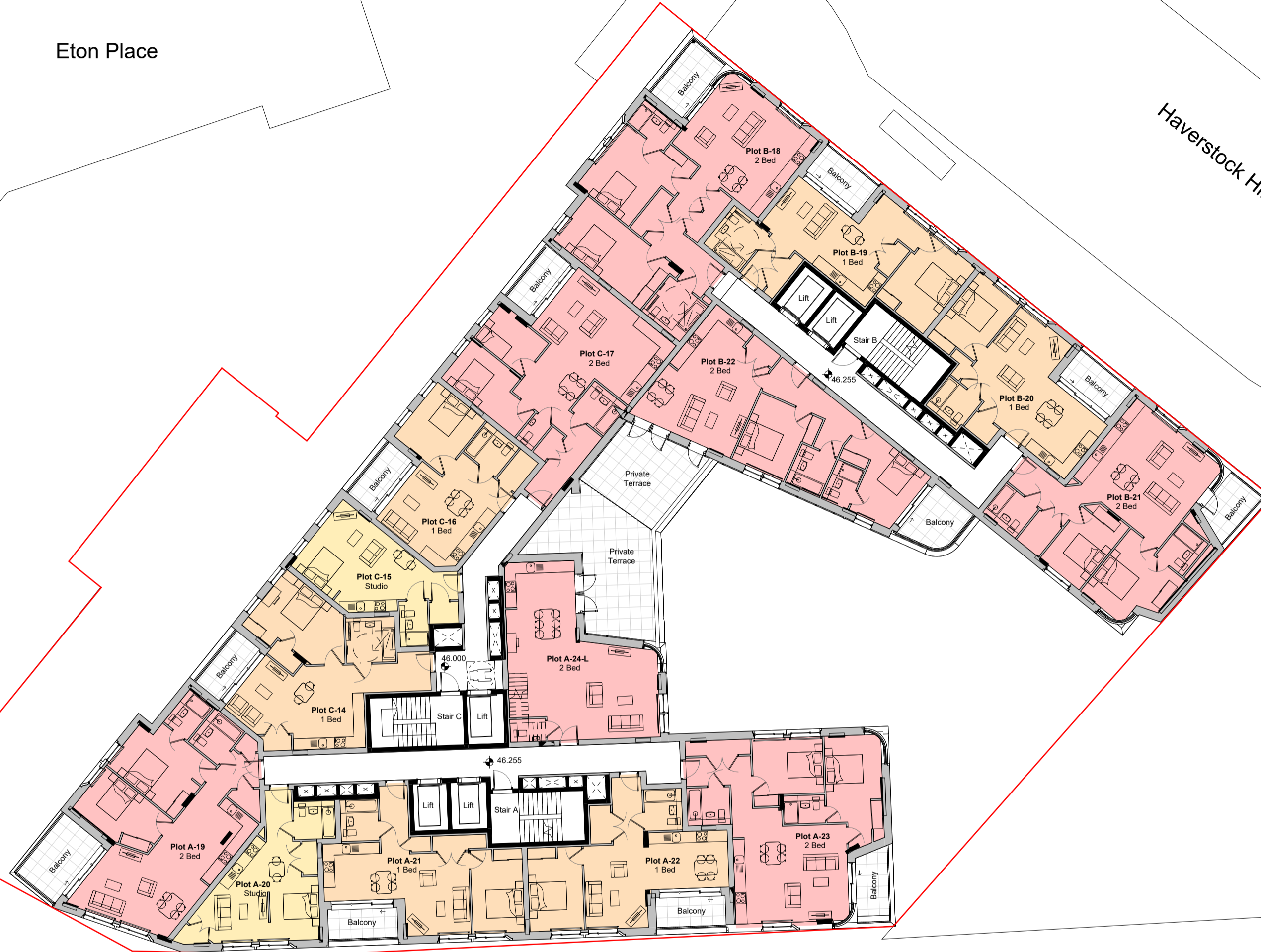

Rev	Comments	Date	Dr	Ch
G1	Planning Issue	06-12-2022	SP	PD

NOTE: This drawing is generated from a federated Revit model, as such the Structural and M&E elements shown were not modelled by Piper Whitlock Architecture (PWA). PWA do not take any responsibility for the design of the other consultant information referenced into PWA's drawing and all such information should be sourced/interrogated from drawings/ models provided by the companies responsible for their creation.



PWA Code: 22014
 Notes: Use annotated dimensions only. All dimensions in millimeters unless otherwise stated. This drawing is to be read in conjunction with all other related material. Any discrepancies, conflicts or errors must be reported to Piper Whitlock Architecture before commencing work.

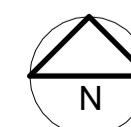

0 5m 10m

Drawing Title:
**Proposed
 4th Floor Plan**

Client:
OD Camden Hotel Ltd

Project Ref: Orig: Zone: Lev: Type: Role: Num: Rev:
 HHCAM-PWA-00-04-DR-A-0214-G1

Status: PRELIMINARY Stage: 3 Scale @ A2: 1:200

Project:
**Haverstock Hill
 Camden**



© Piper Whitlock Architecture Ltd.
 2nd Floor, Anglo St. James House, 31a Southgate Street, Winchester, Hampshire SO23 9EH
 Tel: 01962 843686, Email: enquiries@piperwhitlock.co.uk, www.piperwhitlock.co.uk