

GENERAL NOTE

1. Drawing to be read with Structural Engineer's specifications and details.
2. All details to be read with manufacturer's installation manuals, guide and guidelines.
3. All structural details to be checked by structural engineer prior to fabrication.
4. All fixings to be specified by Structural Engineer or following manufacturer's system guidelines.
5. Any specified system should include all spare parts as per manufacturer's guidance.
6. Contractor to notify Beckmann Architecture Ltd on any specification change or alternative product to be used in the external building envelope build-ups: walls, roofs, floors, doors & windows. Contractor to provide the U-value of the updated build-up for EPC consultant checking and Beckmann Architecture Ltd's approval.
7. Contractor / Manufacturer / Supplier to confirm all fire ratings of the components and their suitability in regard to the current Fire Regulations and BS 9999.
8. All components and materials to be CE marked and compliant with the current British Standards.
9. Any change to specifications and details contained in this drawing should be notified to Beckmann Architecture Ltd/client for approval prior to construction. Approval will be based on physical samples provided by contractor.
10. This is a design intent for pricing only. Contractor to allow for templating on site and shop drawings to be signed off by architect prior to construction.
11. All finishes, fixtures, fittings and associated accessories TBC with interior designer.
12. Designs and details contained in this drawing are subject to full coordination with all the relevant Consultants' design schemes. Confirm with Beckmann Architecture Ltd the status of coordination before any pricing or work is commenced.
13. This drawing to be read in conjunction with full drawings set.
14. All works are subject to Listed Building Consent and not to be commenced without approval in writing.

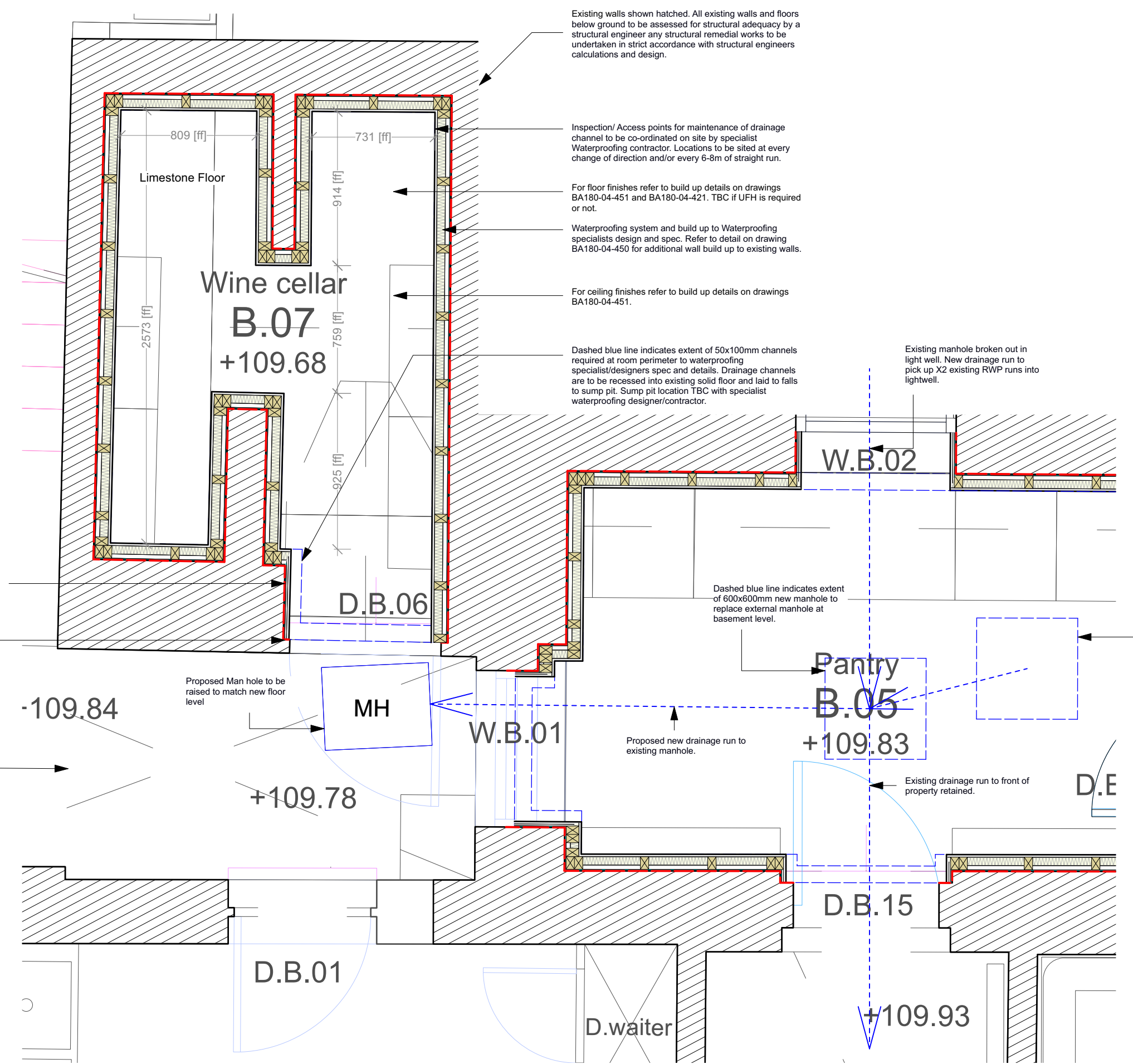

NOTES:

All products to be installed in strict accordance with specialist waterproofing contractor/suppliers details, specification and installation guidance.

All works are subject to Listed Building Consent and not to be commenced without approval of works in writing.

C	13/10/22	Amendments for LBC	MSH
A	20/10/22	Contractor Amend	MSH
P	20/10/22	Contractor Amend	MSH
CO	04/11/22	FINAL GA PLAN	MSH
REV	DATE	DESCRIPTION	DESIGNED

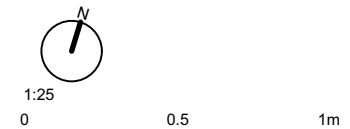

Dashed blue line indicates extent of 600x600mm x 650mm deep sump pit to be excavated for Delta Dual Sump pump V3. Exact location and size TBC with waterproofing specialist/designer. Sump pit to be excavated from existing solid floor build up and TBC with Structural Engineer.

DRAWING TITLE		PROPOSED WINE CELLAR WATERPROOFING GA PLAN AND DRAINAGE PLAN	
DRAWING NUMBER	REV	BA180 - 04 - 452	C
SCALE	STAGE	1:50 @ A3 // 1:25 @ A1	FOR INFORMATION
DATE	DRAWN	CHECKED	SIZE
NOV 2022	MSH	CB	A3

SITE ADDRESS		2 HOLLY HILL TERRACE, LONDON, N6 6LX	
PROJECT		LISTED BUILDING CONSENT APPLICATION	
CLIENT		MR AND MRS BANKS	
<ol style="list-style-type: none"> 1. Do not scale this drawing except for planning purposes. 2. All dimensions are in mm. 3. Beckmann Architecture to be notified immediately if any discrepancy is found. 4. All dimensions to be verified by contractor and/or subcontractors before work commences. 5. All shop drawings to be approved by Beckmann Architecture before work commences. 6. All details to be in accordance with relevant British Standards, manufacturer's recommendations and specifications. 7. This drawing is property of Beckmann Architecture Limited. Copyright reserved. 			

BE // AR
BECKMANN ARCHITECTURE
07845698006 - OFFICE@BE-AR.CO.UK - BE-AR.CO.UK

OgdenPitt
AND COMPANY
CONSTRUCTION AND PROPERTY DEVELOPMENT

1 Proposed Wine Cellar GA Plan and Drainage Plan
1:25 @ A3