

- Read all drawings in conjunction with associated specification, schedules and documents.
- Read all the notes on this drawing.
- Based on survey information by others.
- Drawing's level of detail not suitable for construction.
- Contractor to check and confirm dimensions on site.
- All fire ratings and new works subject to Building Control approval.

Proposed alterations.

Recessed lights in bathroom to be — rearranged to suit new layout, exact position to be determined on site.

Install new built-in cabinets consented under Planning Permission (Ref. 2021/3925/P) and Listed Building Consents (Ref. 2021/4813/L and Ref. 2022/2786/L).

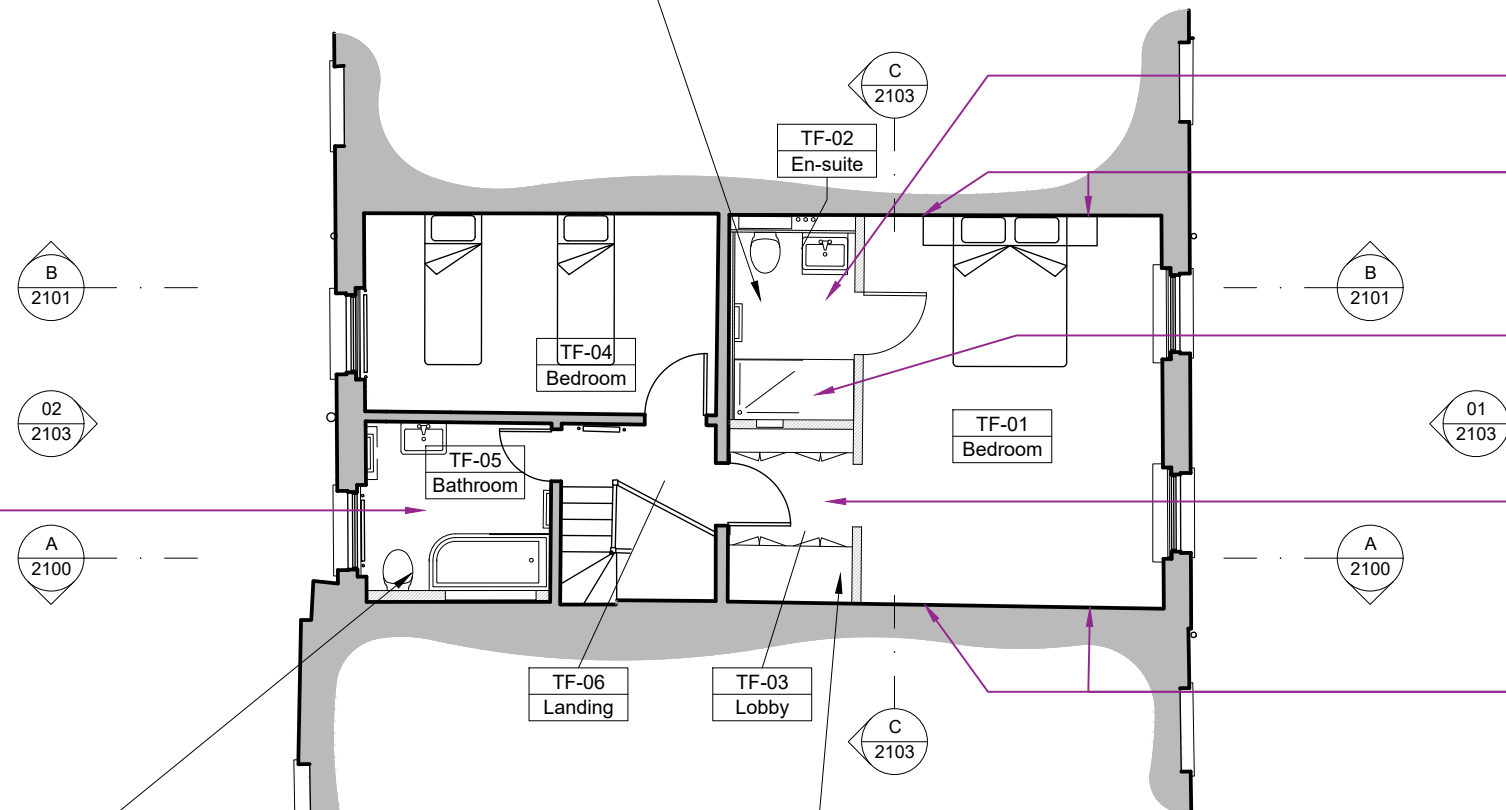

- Install 2no.double sockets, and associated cabling.

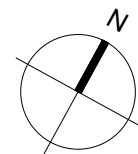
[illegible]