

Unit Model Number	Required Airflow m³/s	A/C Noise Level @ 1m dB	A/C Dimensions			Enclosure required	Overall Enclosure dimensions			Overall Enclosure Weight
			Length	Width	Height		Length	Width	Height	
PUHZ – ZRP125/140	2.0	52	1050	330	1338	Panther Box	2000	1100	1550	263KG

NSL PANTHER BOX ACOUSTIC ENCLOSURE
WITH DRIP TRAY

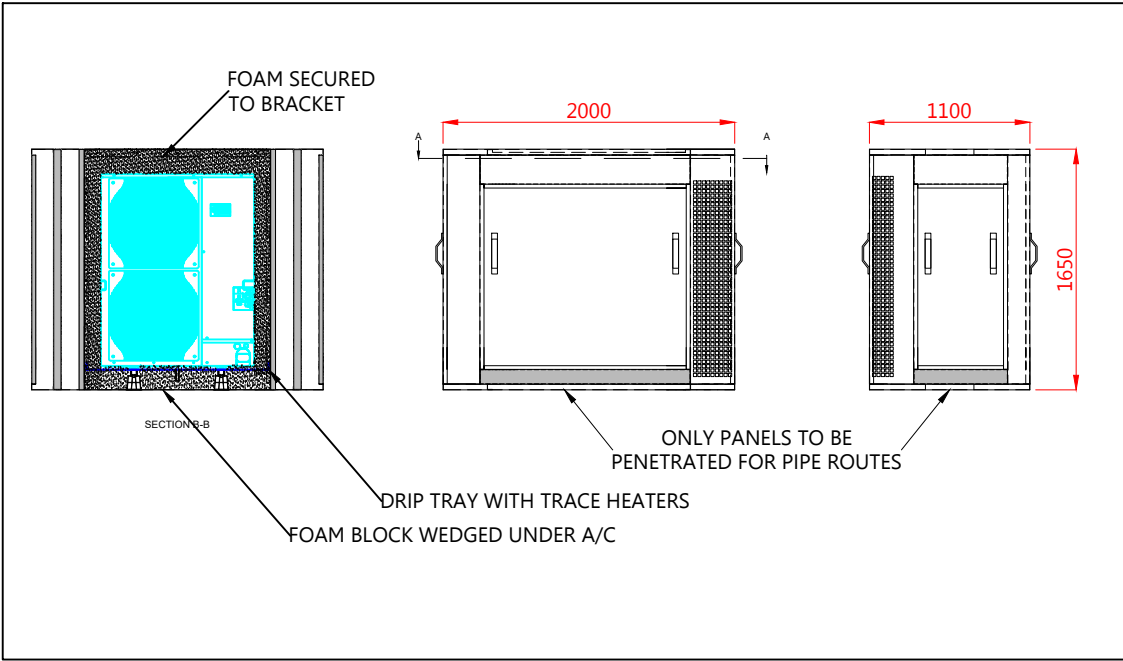
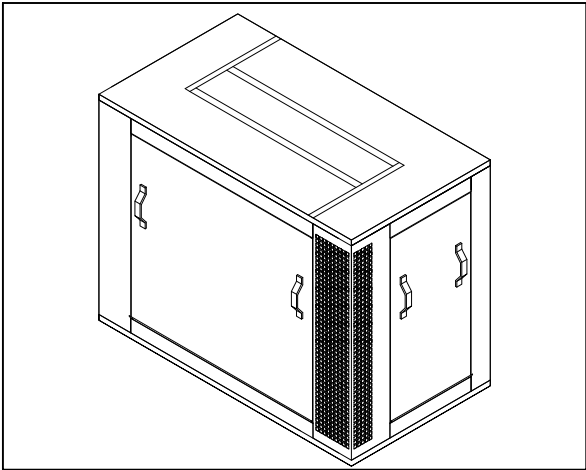
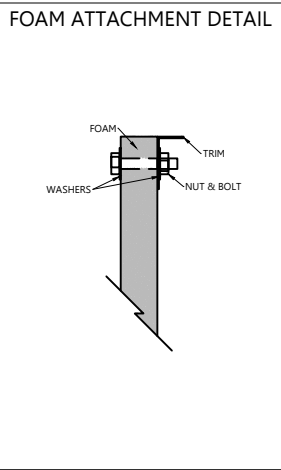
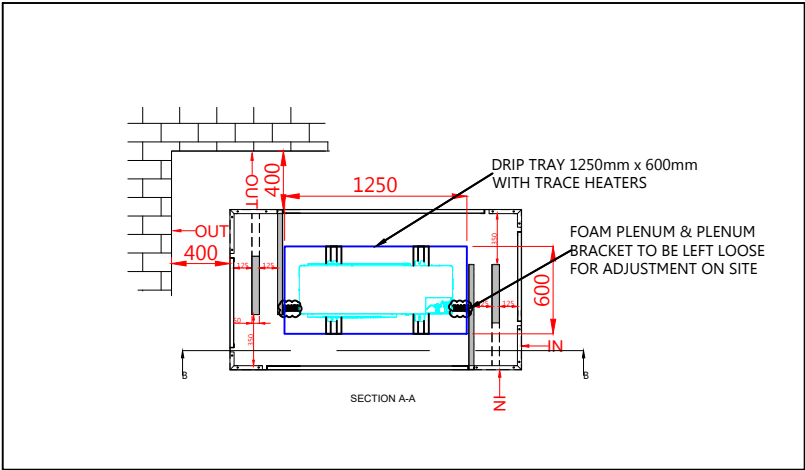

NOTE:

ALL A/Cs TO BE POSITIONED ON SUITABLE FEET BY OTHERS.

ALL PIPEWORK POSITIONS TO BE AGREED PRIOR TO INSTALL OF ACOUSTIC ENCLOSURES.

SUITABLE CONDENSATE PIPE / DRAINAGE TO BE SUPPLIED BY OTHERS.

DUE TO A/C BEING POSITIONED EXTERNALLY, WATER INGRESS MAY OCCUR AND FREEZE DURING COLD WEATHER.

IF A/Cs ARE ON HEAT PUMP MODE, TRACE HEATERS AND DRIP TRAYS WILL BE REQUIRED, ITEMS CAN BE SUPPLIED BY NSL HOWEVER INSTALLATION TO BE COMPLETED BY OTHERS.

IF A/C ENCLOSURES ARE TO BE POSITIONED ON A ROOF, PROTECTION UNDER AC ENCLOSURE TO PROTECT ROOF MEMBRANE BY OTHERS.

ROOF STRUCTURAL INTEGRITY TBC BY OTHERS.

Project: Acoustic Enclosure

Title: NSL Panther Box Acoustic Enclosure with Drip Tray & Trace Heaters

Drawing No: RF80600

Scale: N/A

Projection:

Notes:

All dimensions in millimetres.

NSL
Noise Solutions Ltd

Unit 5
Oriel Court
Omega Park
Alton
GU34 2YT
Tel. 01252 519881
www.noisesolutions.co.uk

This drawing is the sole property of Noise Solutions Ltd.
It must not be copied or lent without their prior knowledge and consent.