

**COPYRIGHT & INTELLECTUAL PROPERTY.**  
All documents remain the property of GWA in perpetuity. The contents of all documents produced whether drawn, written or in pictures or produced by computer as programme or file, are our intellectual property and shall only be used in connection with this project.

**GENERAL NOTES:**  
- The drawing is intended for the stated purpose of issue only.  
- All dimensions and distances are subject site conditions/ tolerance.  
- Do NOT scale from the drawings  
- If in doubt - ask GWA.

**General Note:**  
**Rear Courtyard G.05**  
Specialist damp proofing works to building as necessary.  
Making good as required

No. 6

All existing glazing and support structure, forming glazed roof to be removed. Localised making good as required.

Proposed floor finish to be laid min. 150mm below datum existing floor level. Proposed floor finish to be limestone flag paving. New concrete sub-base min.150mm & laid to falls to new drainage gully  
DG.06 to be retained as existing

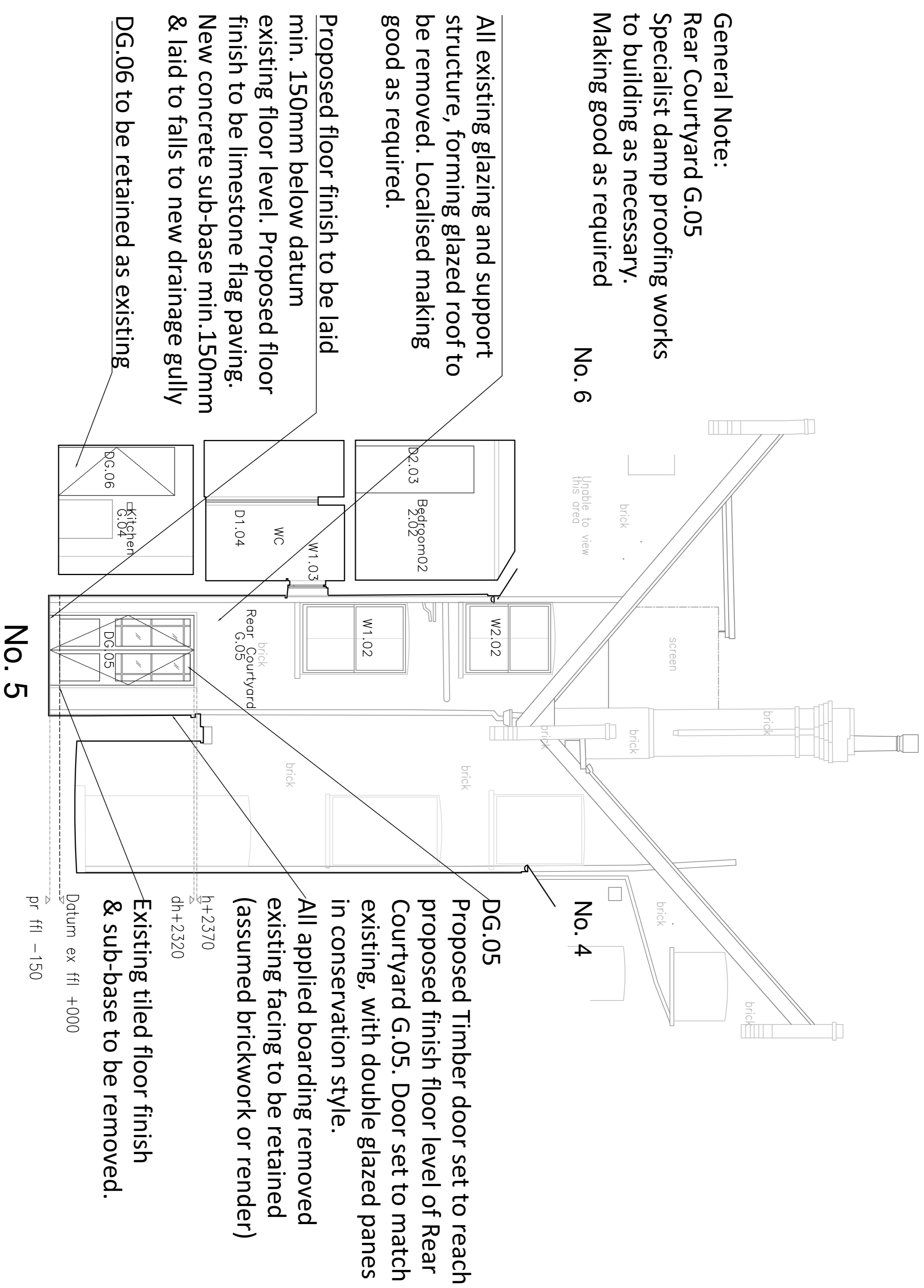

**PROPOSED SECTION A-A' 1:50**

**REVISION NOTES:**

**Grant Wright Associates LLP**

Project Reference  
5 Villas on the Heath

Address  
5 Villas on the Heath,  
Vale of Health,  
London, NW3 1BA

Client  
Ms Delara Shakib

Drawing Title  
Proposed Section a-a'

Drawing number  
SVH/22/23/005

Revision:  
/

Issued for:  
For Information

Scale(s) at A1/A3  
1:50/1:100

Checked by  
GW

Date  
21.10.22

scale in metres 1:50 @ A1

scale in metres 1:100 @ A3

