

# 5 Parliament Court – Existing and Proposed Floorplan

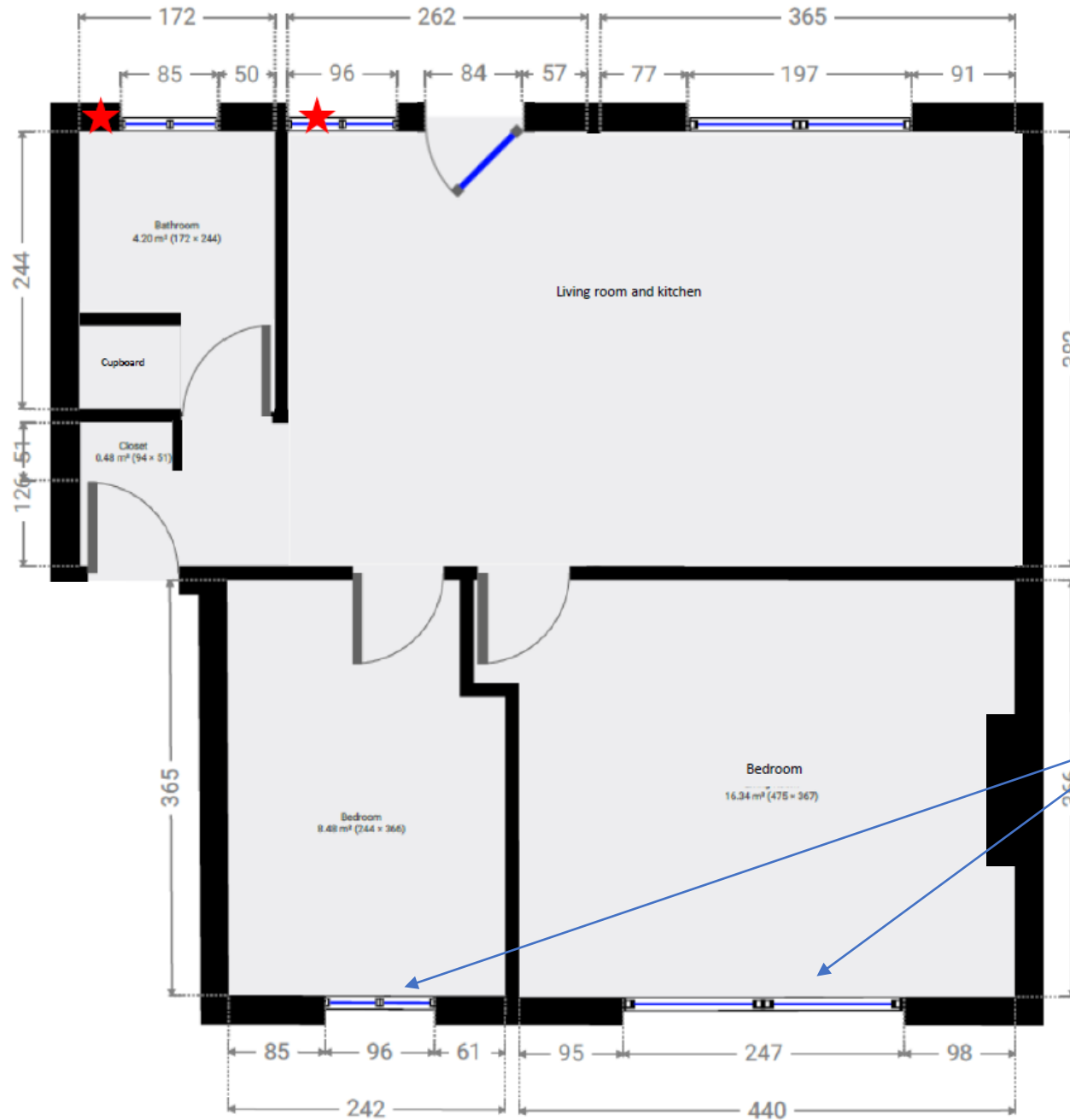

Windows to be replaced

## 5 Parliament Court – Existing and Proposed Elevation



# 5 Parliament Court – Existing and Proposed Elevation detailing windows to be replaced



Windows to be replaced



# 5 Parliament Court – Section through existing windows

SMW	
Glass	Up to 10 mm single
Min.Glass U (U <sub>g</sub> )	5.8 W/m <sup>2</sup> K (single glazed)
Min.Window U (U <sub>w</sub> )	
<small>Commercial Reference Window</small>	
Min.Window U (U <sub>w</sub> )	
<small>Domestic Reference Window</small>	
Energy rating (e <sub>ERC</sub> )	
Glazing	Putty glazing
Glazed	Externally only
Grade	Domestic

