

1 Elevations Green wall - Section AA location  
1/75

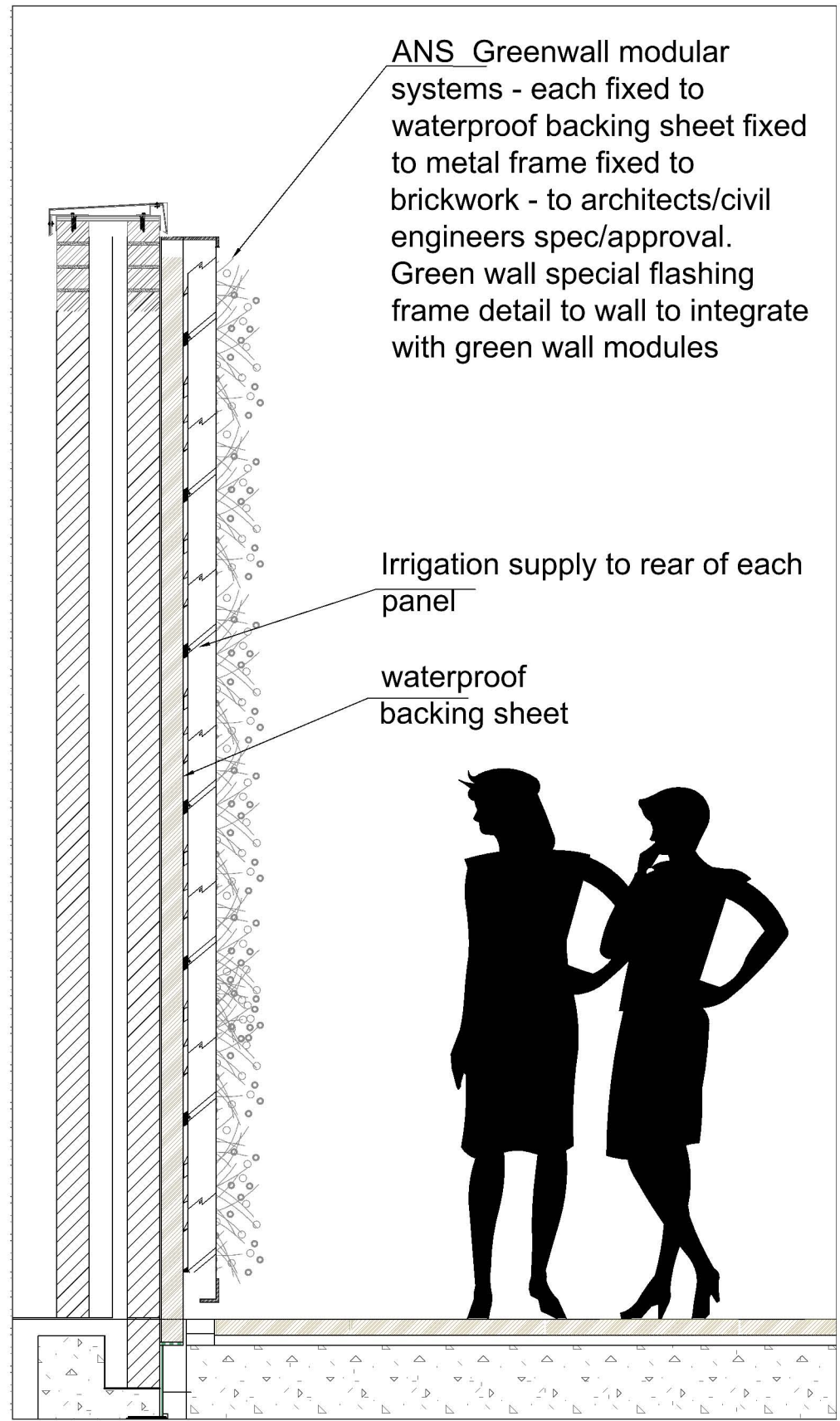

System - Installation - Steel Frame

Steel Frame

- Existing steel frame - maximum 600mm horizontal centres
- Waterproof membrane
- 48x12mm ANS Fixing Rail
- Oasma Squareline Gutter or client specified
- ANS Living Wall Module 500x250x100mm
- 16mm vertical irrigation pipe
- Planting
- 16mm inline emitter pressure regulated irrigation pipe

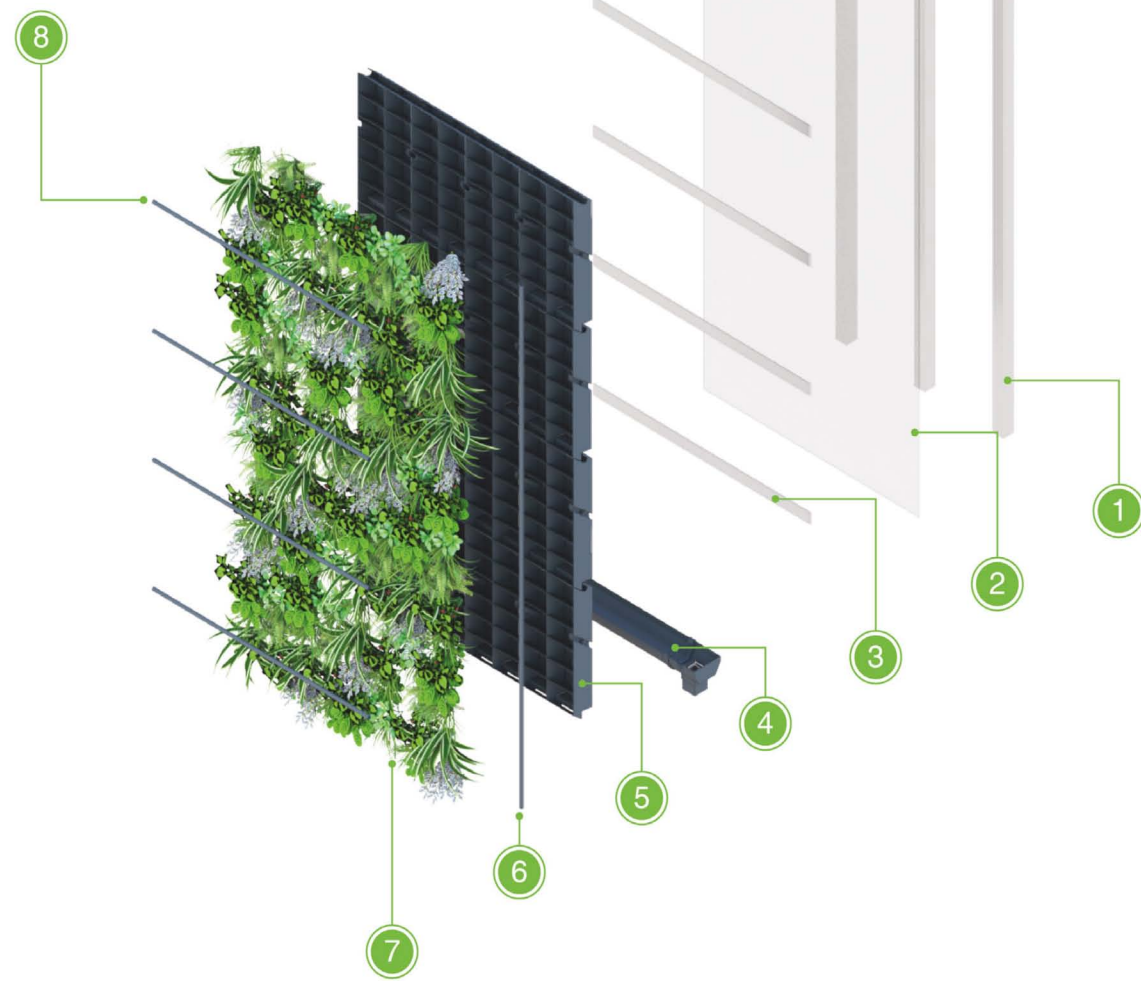

3 ANS Green wall manufacturers build-ups visual - to show construction and materials proposed

Greenwall system based on steel galvanised frame installed to wall and concrete slab to take waterproofing membrane and ANS horizontals rails . Wall approximate 65kg /m2

System - Module

Manufactured in the UK from 100% recycled material

No visual exposure of the module on the frontage

No man-made growing mediums, mineral wools or other fibres are used

72kg per m<sup>2</sup>

Modules are planted and established prior to installation

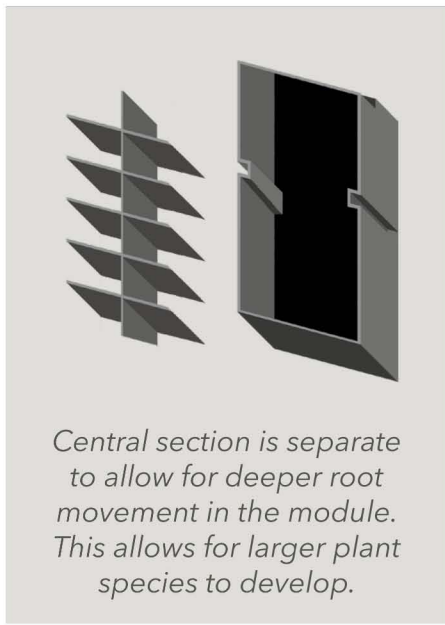
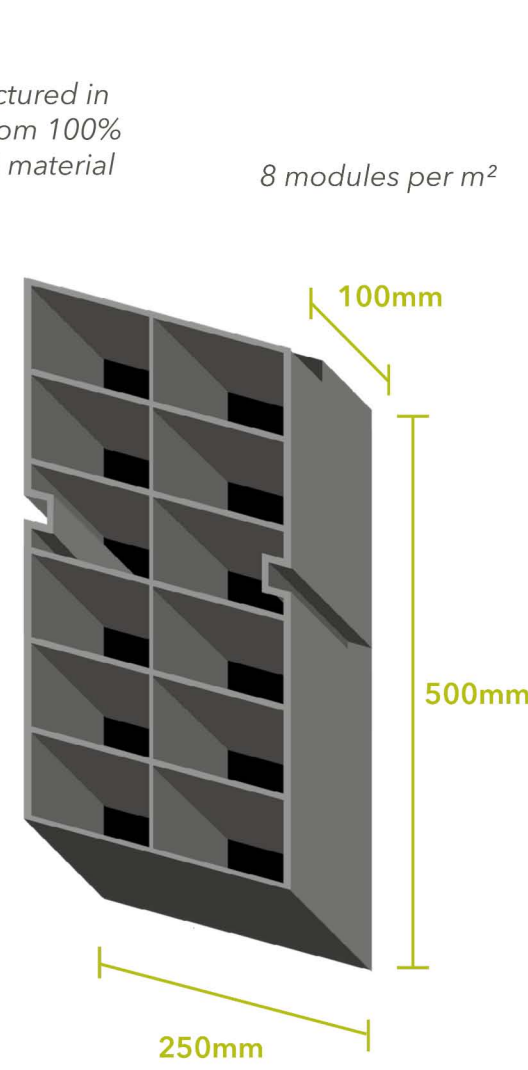

In extreme weather the module is designed to expand externally

36 plants per m<sup>2</sup>

Wind resistant to 140 mph

4 ANS Green wall manufacturers interlocking Modules visual - to show construction and materials proposed

System soil filled and planted up with 9cm plants to min.36 plants per square metre.

2 Section A A - Green wall @ 1/20 as section detail requested ii.

Maintenance Schedule	Shown below is a maintenance schedule for the Lincoln House Green Walls. The maintenance package is to be organized via the managmeent company/ The schedule will be subject to specific seasonal fluctuations to respond to weather conditions at that time - so higher frequency visits/increased operatives may be required.											
	Jan	Feb	Mar	Apr	May	Jun	Jul	Aug	Sep	Oct	Nov	Dec
	Visually inspect the living wall	✓	✓	✓	✓	✓	✓	✓	✓	✓	✓	✓
	Check the moisture levels			✓	✓	✓	✓	✓	✓	✓	✓	✓
	Recalibrate irrigation zones		✓	✓	✓	✓	✓	✓	✓	✓	✓	✓
	Check the health of plants		✓	✓	✓	✓	✓	✓	✓	✓	✓	✓
	Carry out remedial work if necessary		✓	✓	✓	✓	✓	✓	✓	✓	✓	✓
	Remove weeds		✓	✓	✓	✓	✓	✓	✓	✓	✓	✓
	Prune in accordance with season			✓						✓		
	Dead head seasonal plants			✓	✓	✓						
	Treat for pest and disease					✓	✓		✓			
	Apply feed and nutrient as necessary			✓			✓					
	Service irrigation system	✓	✓	✓	✓	✓	✓	✓	✓	✓	✓	✓
	Check run off outlets for blockage	✓	✓	✓	✓	✓	✓	✓	✓	✓	✓	✓

4 Typical ANS Green wall Maintenance Programme for Lincoln House

Maintenance refer to schedule calendar for specific visits

This will require regular visits to ensure the computer controlled irrigation system is distributing the correct amount of water throughout the wall. The system will be tailored to suit the plant selction, north facing aspect, and will include a nutrient dosing system the system will be connected to a remote computer monitoring system which will alert the contractor and onsite management team if any interruptions.

Visits are to be monthly. At the same time visual inspection to the plants checking for any early signs of pest and disease. Should there be any concerns then the technicians will apply a bio- logical treatment which is safe for the environment through the irrigation system. Plant growth will be monitored and any localised trimming / pruning will be carried out. This visit ensures on a monthly basis the walls are kept well.

Twice yearly a full plant husbandry visit will be arranged. This will require full access to whole of the wall. The plants will be pruned back in accordance with standard good horticultural practice and any aged plants or failed plants will be replaced in their module. Once the wall has had its overall prune an organic phosphate / potassium feed application through the dosatron to encourage root development over the coming year will be applied.

Collect all dying and diseased/dead plant material on each monthly visit. ensure that maximum coverage is maintained to keep up well balanced growth across wall panels. Ensure all drainge systems are kept free of debris and check are working on each visit.

All materials, workmanship, quality and operations to be in accordance with current British Standards, Codes of Practice and legislation. Planting shall comply to BS: 4428 Code of practice for general landscaping operations, BS: 3996 Nursery stock specification, BS: 7370 Recommendations for establishing and managing grounds maintenance organizations and for design considerations related to maintenance.

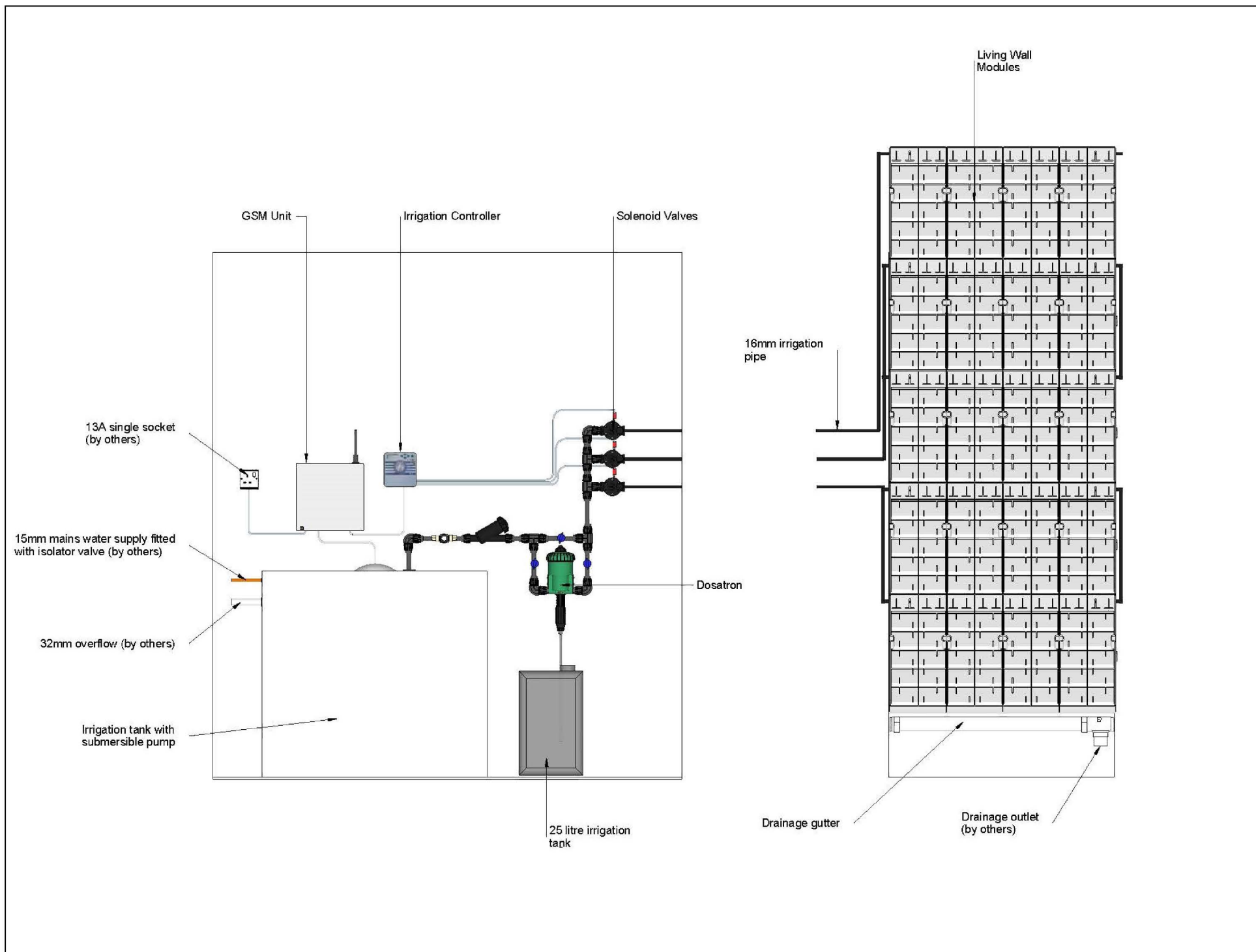

4 ANS Green wall manufacturers Irrigation System with Tank and Dosing unit- to show construction and materials

C	minor amends	CN	24.11.22
B	minor amend	CN	18.11.22
A	first issue	CN	17.11.22
REV	DESCRIPTION	APP	DATE

London  
T 020 70171786



Lincoln House  
296-302 High Holborn

Landscape Green Wall Proposed works  
2 of 2

DATE	Nov 2022	DRAWN	CN
SCALE	var@A1	CHECKED	NT
STATUS	Planning	APPROVED	
DWG. NO	D0479_002	C	