

**NOTES:**

- An allowance of 20mm should be given in respect of point-cloud data to drawing detail.

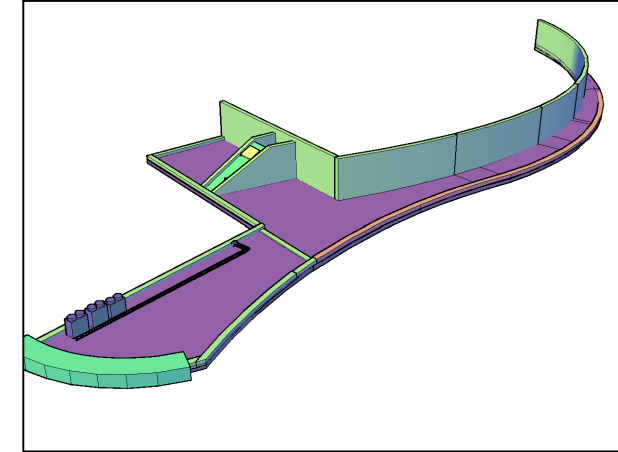

**3D Conceptual view**  
(Scale - nts)

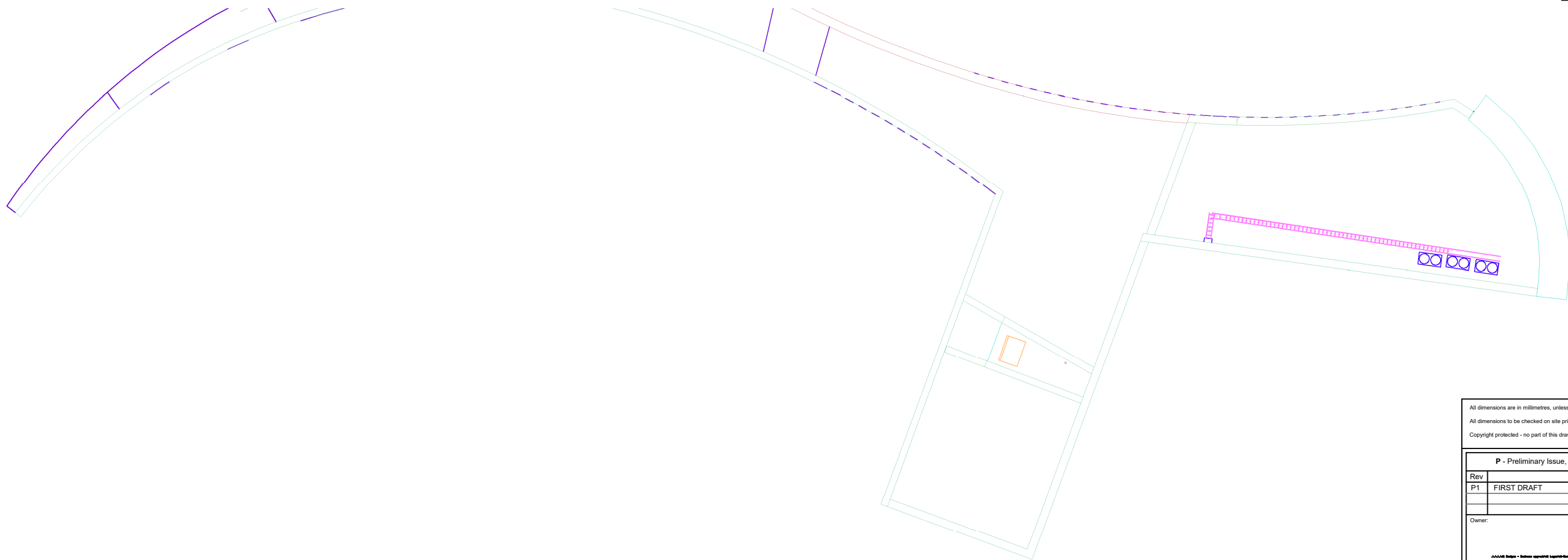

**ROOF LEVEL**  
(Scale - 1:100)

All dimensions are in millimetres, unless otherwise stated.  
All dimensions to be checked on site prior to commencement of any work.  
Copyright protected - no part of this drawing may be reproduced without prior consent of A1 Designs and Drafting Ltd.

P - Preliminary Issue, T - Tender Issue, C - Construction Issue, R - Record Issue			
Rev	Description	Drawn	Date
P1	FIRST DRAFT	PC	26.07.22

Owner:  5 Pauling Close, Aston Clinton, Bucks, HP22 5PH  w: www.a1-designs.co.uk e: pcampbell@a1-designs.co.uk t: 0800 0582499 m: 07544982702	Client:  ..\\..\\Inc\\LABS LOGO.jpg
---	---

Project Name: **287 Camden High Street**

Title: **First Floor Level - Roof Level (Existing)**

Site: **287 Camden High St NW1 7BX** Discipline: **Survey**

Drawn: PC Checked: -- Approved: -- ISO A3  
Highway Authority: N/A OS Reference: N/A 420x297mm

Drawing Number: **LAB-287CHS-2021-000-RL-01** Rev: **P1**

