



Existing railings to be retained, stripped and re-painted.

New steelwork to support failing stone balcony. Refer to Structural Engineers sketches. New GRC cornice to match no.49 to run full length of balcony to hide steel work. Underside and top of balcony to be made good following structural strengthening.

GENERAL NOTES.

All dimensions to be checked on site prior to commencement of any works, and/or preparation of any shop drawings.

Sizes of and dimensions to any structural elements are indicative only. See structural engineers drawings for actual sizes / dimensions.

Sizes of and dimensions to any service elements are indicative only. See service engineers drawings for actual sizes and dimensions.

This drawing to be read in conjunction with all other Architect's drawings, specifications and other Consultants' information.

All proprietary systems shown on this drawing are to be installed strictly in accordance with the Manufacturers/Suppliers recommended details.

Any discrepancies between information shown on this drawing and any other contract information or manufacturers/suppliers recommendations is to be brought to the attention of the Architect

DO NOT SCALE FROM THIS DRAWING.

NOTES.

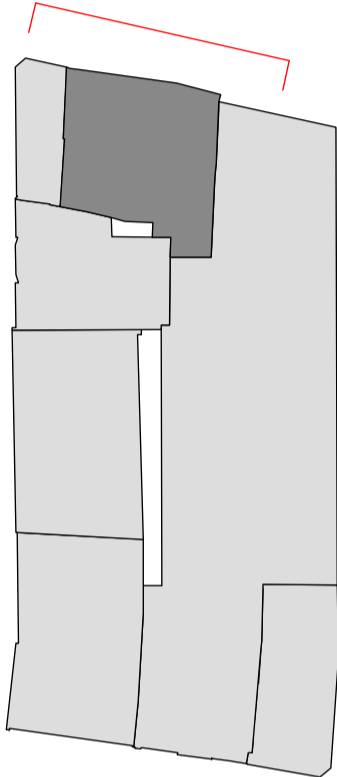

Key Plan

P1 PLANNING ISSUE 09/11/2022
REVISION DATE

Buckley Gray Yeoman

Studio 4.04 The Tea Building 56 Shoreditch High Street
London E1 6JJ T: 020 7033 9913 F: 020 7033 9914

CLIENT
SRG Holborn Limited

PROJECT
46-48 Bedford Row

DRAWING
Proposed North Elevations to 48 Bedford Row

SCALE
1:50 @ A1 1:100 @ A3
DATE
Nov. 2022
DWG No.
1092_GE-01
DRAWN BY
CvD
REVISION
P1

DRAWING STATUS
PLANNING