

LEGEND

- NEW MACHINE
- AREA OF REQUIRED ADJUSTMENT
- EXISTING STRUCTURE

SCOPE OF WORKS

- 3NO EXISTING EXTERNAL MACHINES REMOVED FROM SITE
- 2NO NEW EXTERNAL MACHINE INSTALLED THROUGH EXISTING APERTURES
- ALL FINISHES TO BE MADE GOOD INTERNALLY AND EXTERNALLY AND TO MATCH EXISTING
- NEW EXTERNAL BUTTON SIGNAGE ABOVE NEW MACHINES
- NEW CCTV CAMERA INSTALLED

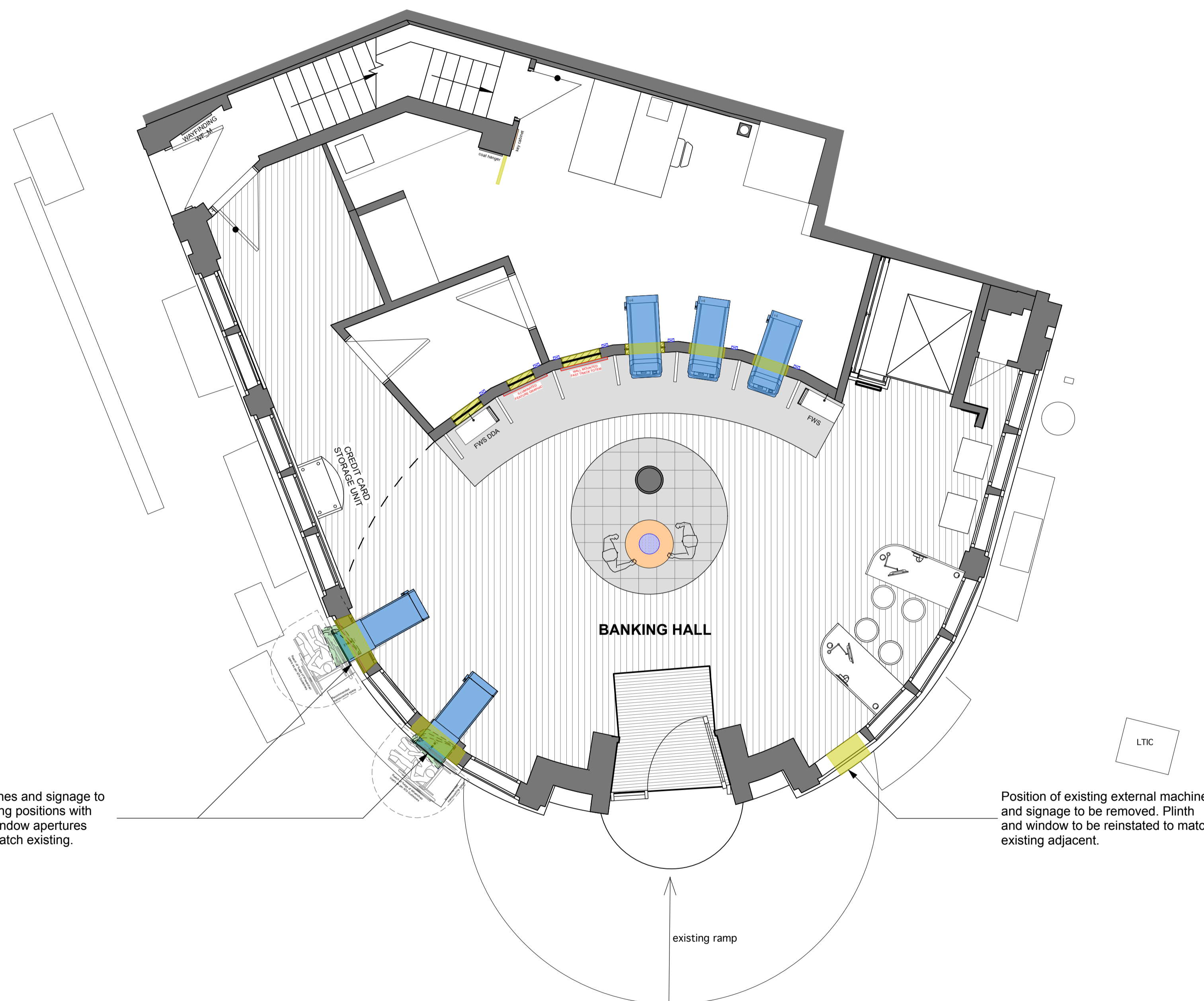

New external machines and signage to be replaced in existing positions with modified wall and window apertures using materials to match existing.

Position of existing external machine and signage to be removed. Plinth and window to be reinstated to match existing adjacent.



UNITED KINGDOM • HONG KONG
www.aqp.co.uk
architecture | design | masterplanning | interiors

REVISION	BY	DATE	REVISION	BY	DATE
A	AT	02/12/2022			
Drawing updated following comments received from LPA					

CONTRACTORS MUST CHECK ALL DIMENSIONS ON SITE. ONLY FIGURED DIMENSIONS ARE TO BE WORKED FROM. DISCREPANCIES MUST BE REPORTED TO THE ARCHITECT BEFORE PROCEEDING.
© THIS DRAWING IS COPYRIGHT

PLANNING

CLIENT: **CORPORATE REAL ESTATE**
PROJECT: **2021 EMERALD CAMDEN TOWN PIN GB1022**

PUBLIC	
DRAWING: Proposed Ground	SCALE: 1:100 @ A3 1:50 @ A1
DRAWING No: 21035 017 PA 21	REVISION: A
DRAWN BY / OFFICE: SS - Dorchester	