

Drop kerbs required for rubbish collection - final location in abeyance

Drop kerbs required for rubbish collection - final location in abeyance

Fitness equipment installation undertaken as part of separate contract

LINKED MODEL SCHEDULE:

1. Drawing to be read in conjunction with MPR-TMA-ZZ-GF-SH-L-100002 - Materials Schedule.

STATUS	REV	DATE	DESCRIPTION	DSG	DRW	CHK	APP
S4	C02	20/06/2022	Incorporating SE information	AC	T	TS	
S4	C01	10/06/2022	Stage 5 Issue	AC	T	TS	
S3	P09	07/04/2022	Boundary Amendments	AC	T	TS	
S3	P08	20/12/2021	Fitness Trail info added for Planning	AC	T	TS	
S3	P07	26/10/2021	Issued for Planning	AC	T	TS	
S3	P06	20/10/2021	Minor amendments to layout	AC	T	TS	
S3	P05	18/11/2020	Amendments to tree positions	AC	T	TS	
S3	P04	25/06/2020	Amendments to full updated topo survey	AC	T	TS	
S3	P03	22/05/2020	Stage 4 Issue	AC	T	TS	
S1	P02	01/05/2020	Minor amendments to edges and furniture	AC	T	TS	
S1	P01	09/04/2020	First Issue	AC	T	TS	

MAIN CONTRACTOR



Bouygues UK
Becken House
1 Lambeth Palace Rd
London, SE1 7EU
Tel: 020 7401 0020

CLIENT LOGO



KEY PLAN

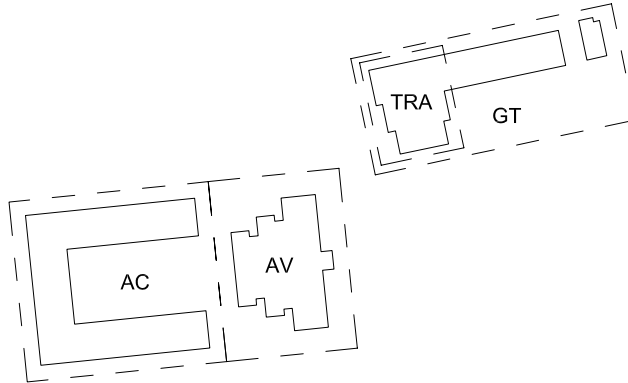

ORIGINATOR

turkington martin

Studio 3.04 Chester House, Kensington Park
3-5 Grosvenor Road, London, SW1W 0EX
T: +44 (0)20 7467 1050
E: studio@turkingtonmartin.com

PROJECT NAME

Maitland Park Redevelopment

DRAWING TITLE

Materials General Arrangement Plan

SCALE @ A0

1 : 200
Not Applicable

FIRST ISSUE DATE

09/04/2020

PROJECT STAGE

Stage 5

STATUS CODE

S4 - For Stage Approval

PROJECT ORIGINATOR

MPR TMA ZZ GF GA L 100001 C02