

EXISTING PAVEMENT AND KERBS TO BE REMOVED

STAIR'S STONE STEPS AND RAILING TO BE REMOVED BRICKWORK BELOW STEPS TO BE RETAINED

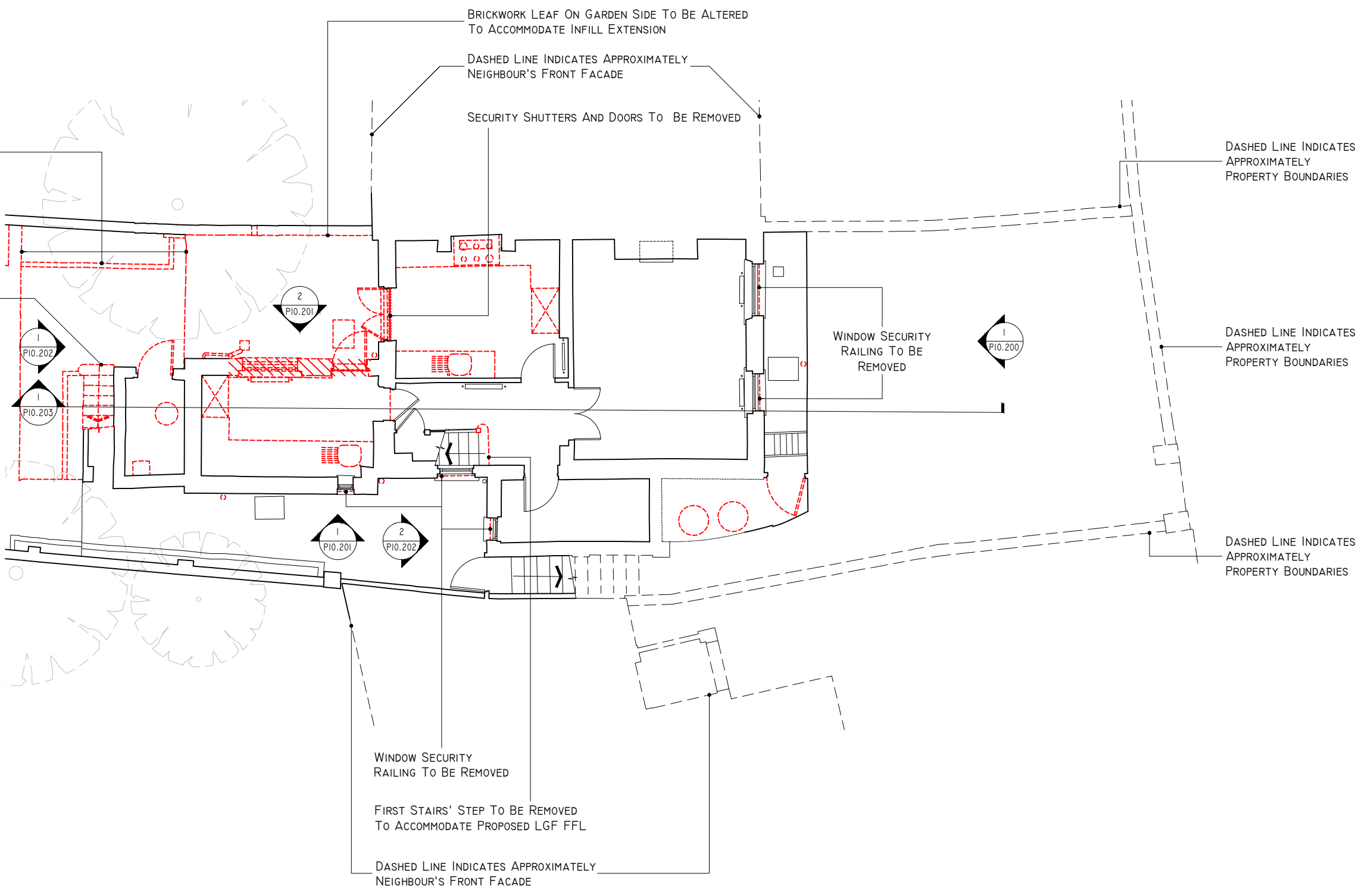

BRICKWORK LEAF ON GARDEN SIDE TO BE ALTERED TO ACCOMMODATE INFILL EXTENSION

DASHED LINE INDICATES APPROXIMATELY NEIGHBOUR'S FRONT FACADE

SECURITY SHUTTERS AND DOORS TO BE REMOVED

DASHED LINE INDICATES APPROXIMATELY PROPERTY BOUNDARIES

DASHED LINE INDICATES APPROXIMATELY PROPERTY BOUNDARIES

DASHED LINE INDICATES APPROXIMATELY PROPERTY BOUNDARIES

WINDOW SECURITY RAILING TO BE REMOVED

WINDOW SECURITY RAILING TO BE REMOVED

FIRST STAIRS' STEP TO BE REMOVED TO ACCOMMODATE PROPOSED LGF FFL

DASHED LINE INDICATES APPROXIMATELY NEIGHBOUR'S FRONT FACADE

REV	DATE	DESCRIPTION

NOTES

1. ALL EXISTING INTERNAL FLOORS TO BE REMOVED TO ACCOMMODATE PROPOSED FINISH FLOOR LEVEL.
2. ALL INTERNAL DOORS TO BE RETAINED AND DROPPED.

KEY:

--- PROPOSED ALTERATIONS

PROPOSED ALTERATIONS TO THE FABRIC

ECHLIN THIRD FLOOR
91 WIMPOLE STREET,
LONDON, W1G 0EF
+44 (0) 20 7349 9610
ECHLINLONDON.COM

DO NOT SCALE FROM THIS DRAWING. ALL DIMENSIONS TO BE CHECKED ON SITE PRIOR TO COMMENCEMENT OF ANY WORK OR PREPARATION OF SHOP DRAWINGS. THE SIZES AND DIMENSIONS OF ALL STRUCTURAL AND SERVICE ELEMENTS MUST ALWAYS BE CHECKED AGAINST THE RELEVANT ENGINEERING DRAWINGS. THIS DRAWING IS TO BE READ IN CONJUNCTION WITH ALL OTHER CONSULTANTS INFORMATION. IF THIS DRAWING HAS BEEN TRANSMITTED ELECTRONICALLY, THE ABOVE STATEMENTS ALSO APPLY. © ECHLIN 2018

PROJECT
35 GLOUCESTER CRESCENT, LONDON, NW1 7DL

DRAWING TITLE
EXISTING LOWER GROUND FLOOR PLAN + ALTERATIONS

STATUS
ISSUED FOR PLANNING APPLICATION

SCALE	JOB NUMBER	DRAWN BY	CHECKED
1:100 @A3	2124	FP	SC
DRAWING No	DATE	REVISION	
2124_A_P10.099	28.09.2022	-	

1 EXISTING LOWER GROUND FLOOR PLAN + ALTERATIONS
SCALE: 1:100 @A3

