

NIA: 70.91sq.m

Basement

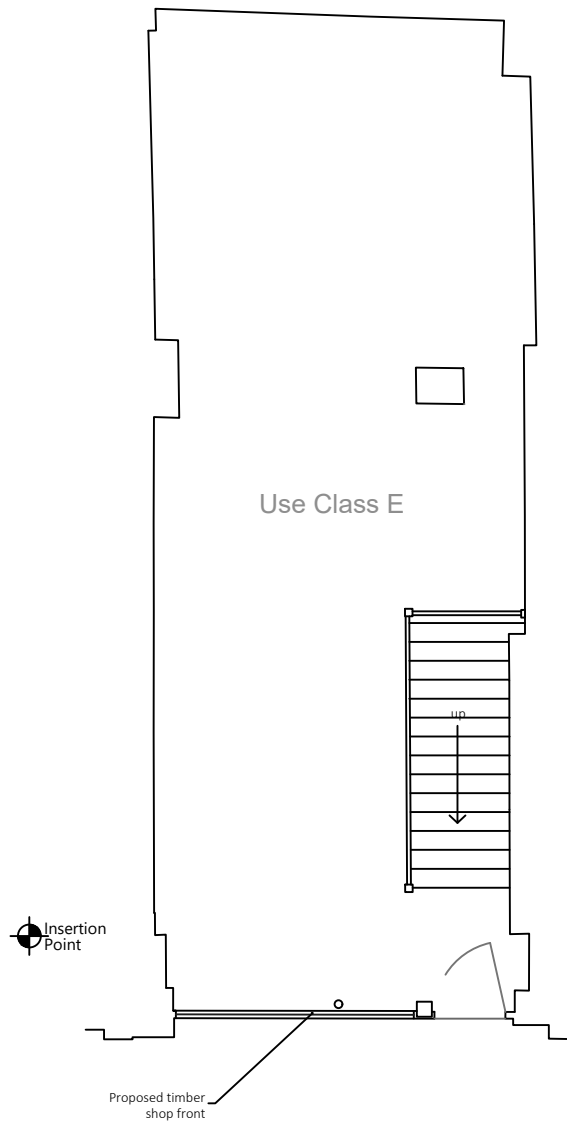

NIA: 58.06sq.m

Existing disused ground to first floor staircase removed to increase shop frontage

Alter existing ground floor structure to allow the basement stair to be turned.

Proposed timber shop front

Ground Floor
Basement stair turned around



P2	CM	Planning Issue	08.08.2022
P1	CM	Draft Issue	08.07.2022
Rev	Iss.	Description	Date

DRAWING TITLE
Basement & Ground Floor Levels As Proposed
PROJECT NAME
New Shop Front

ADDRESS
47 Goodge Street
London
W1T 2LD
CLIENT
Shaftesbury CL Ltd

DRAWN BY
CM
CHECKED BY



Disclaimer and Notes
Do not scale this drawing. All dimensions should be checked on site. Any discrepancy found between this drawing, site and any other document should be referred immediately to Fresson and Tee. All drawings should be read in conjunction with all other contract documents and specifications and all other consultants drawings.

Copying or reproduction of this drawing without the written permission of Fresson and Tee is not permitted. Copyright is Reserved

The PDF hard copy accompanying the CAD data is legal transmission of information. The electronic copies are issued only for convenience of use and record of original file. No liability for the accuracy or for any consequence resulting from the use, additions or alteration of information is accepted by Fresson and Tee.

Title plan at 1:1250 and North point is up

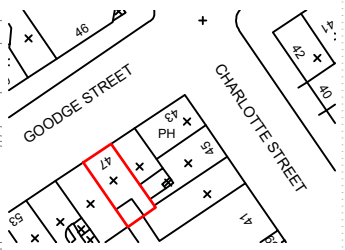

P3	CM	Glazing bars added, projecting sign altered	18.10.2022
P2	CM	Planning Issue	08.08.2022
P1	CM	Draft Issue	08.07.2022
Rev	Iss.	Description	Date

DRAWING TITLE

Front Elevation
As Proposed

PROJECT NAME
New Shop Front

ADDRESS
47 Goodge Street
London
W1T 2LD
CLIENT
Shaftesbury CL Ltd

DRAWN BY
CM

CHECKED BY

JOB NO.
25528

SCALE
1:100@A3
1:50@A3

DATE
Jul 2022

DRAWING NO.
A-202-P3



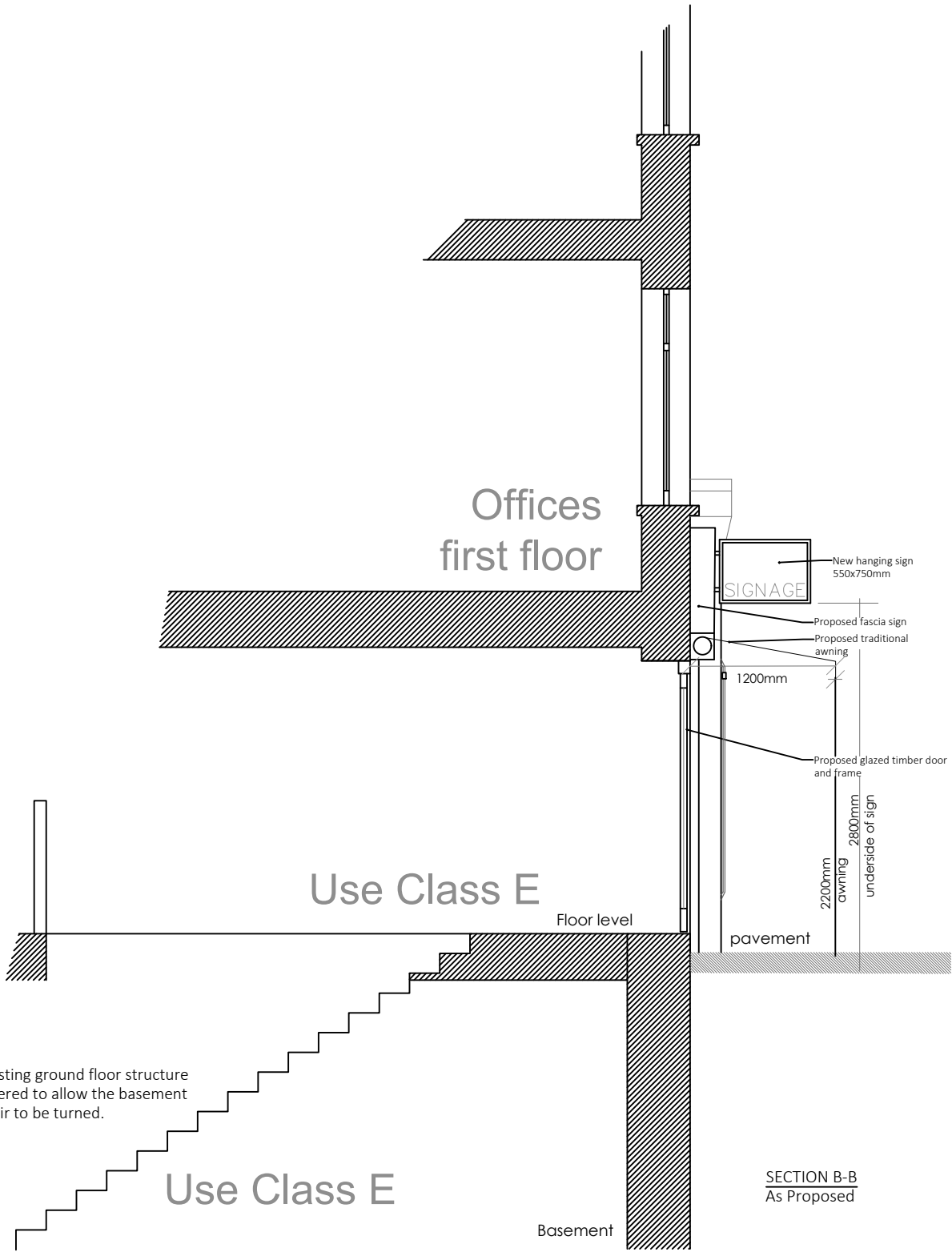
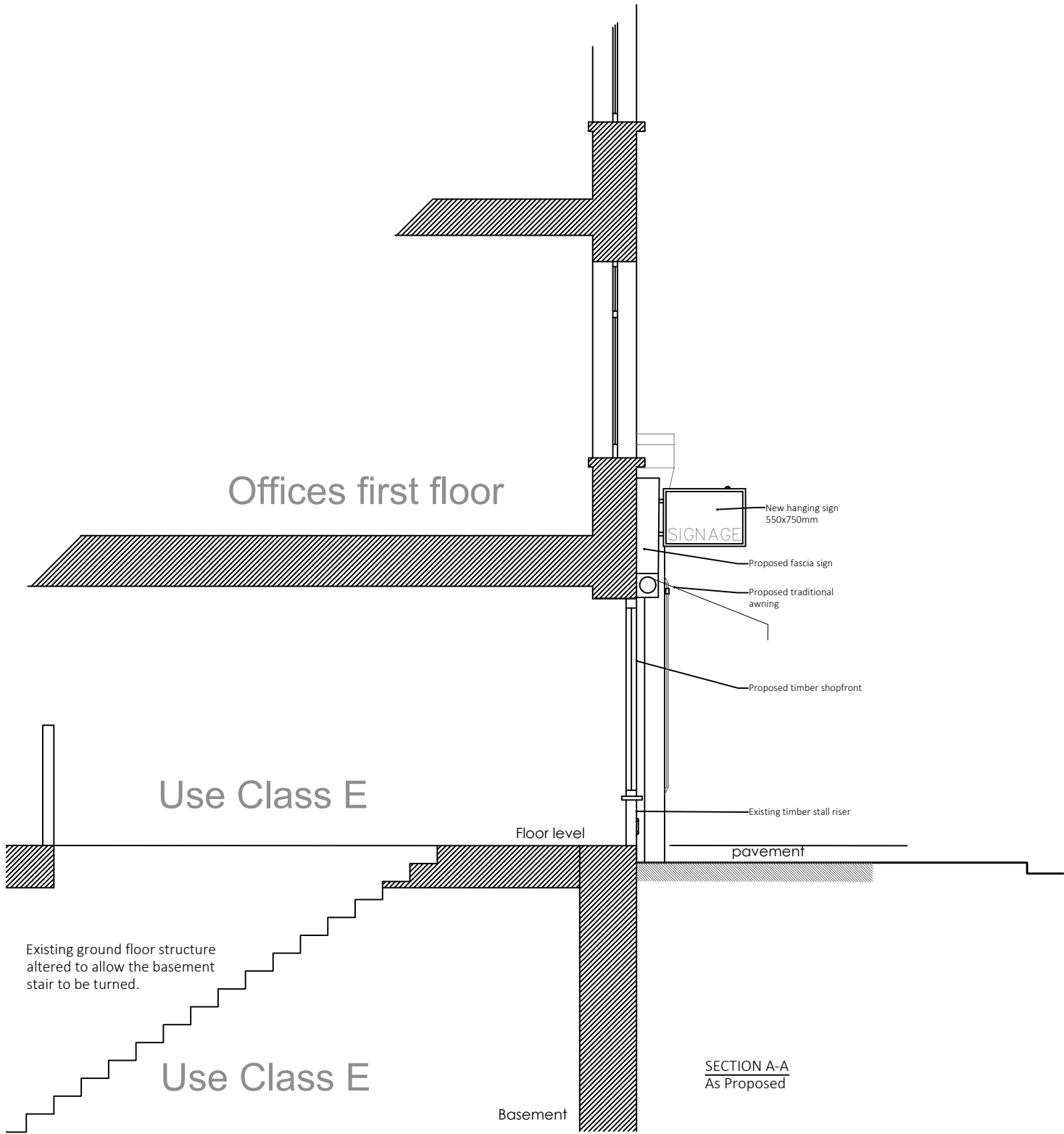

Disclaimer and Notes
Do not scale this drawing. All dimensions should be checked on site. Any discrepancy found between this drawing, site and any other document should be referred immediately to Frieson and Tee. All drawings should be read in conjunction with all other contract documents and specifications and all other consultants drawings.
Copying or reproduction of this drawing without the written permission of Frieson and Tee is not permitted. Copyright is Reserved.
The PDF hard copy accompanying the CAD data is light transmission of information. The electronic copies are issued only for convenience of use and record of original file. No liability for the accuracy or for any consequence resulting from the use, addition or alteration of information is accepted by Frieson and Tee.
Title plan at 1:1250 and North point is up.



P4	CM	Scale bar altered	25.11.2022
P3	CM	Projecting sign altered	18.10.2022
P2	CM	Planning Issue	08.08.2022
P1	CM	Draft Issue	08.07.2022

Rev	Iss.	Description	Date
-----	------	-------------	------

Sections As Proposed

PROJECT NAME
New Shop Front

ADDRESS
47 Goodge Street
London
W1T 2LD
CLIENT
Shaftesbury CL Ltd

DRAWN BY
CM

CHECKED BY

JOB NO.
25528

SCALE
1:50@A3

DATE
Jul 2022

DRAWING NO.
A-203-P4

ft



1 25mm steel barrel welded to wrought iron fixing bracket at one end. Matt black paint finish.

2 25mm block board with 2mm steel lip to give finished overall size of 750x450mm. Decorated by incoming tenants. Steel steel barrels fixed to top edge to fix to decorative (false) bracket.

3 Steel frame 15x15mm profile welded between steel barrel and brackets.

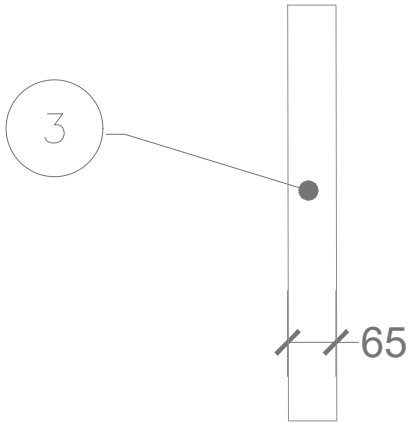

END VIEW

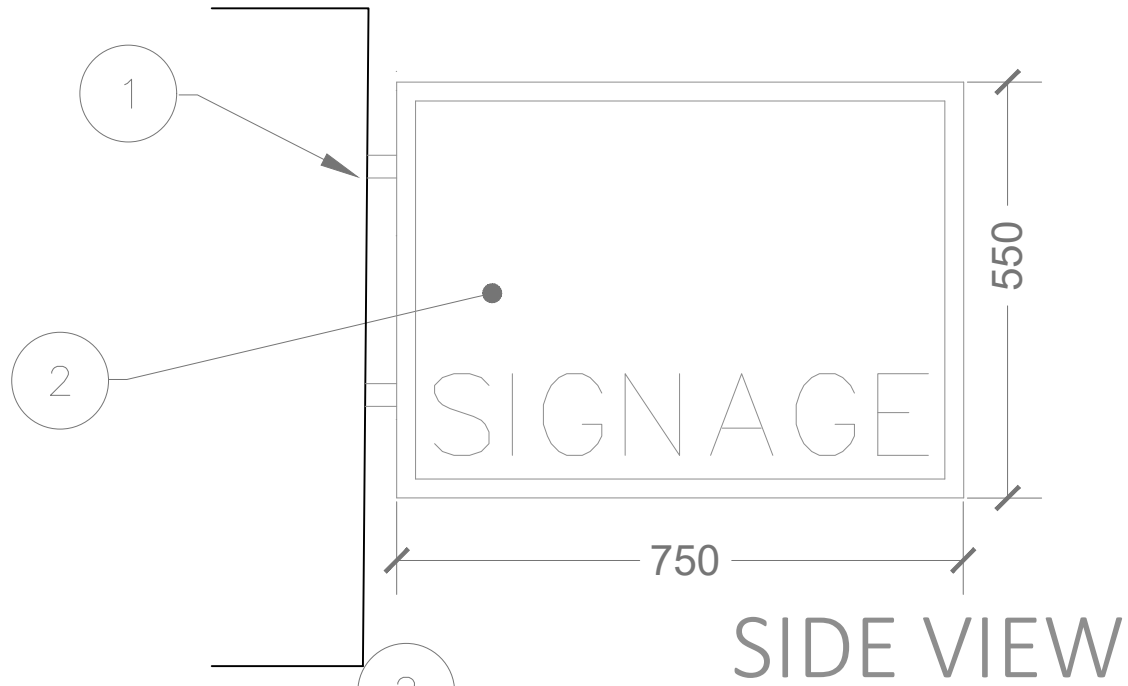

SIDE VIEW

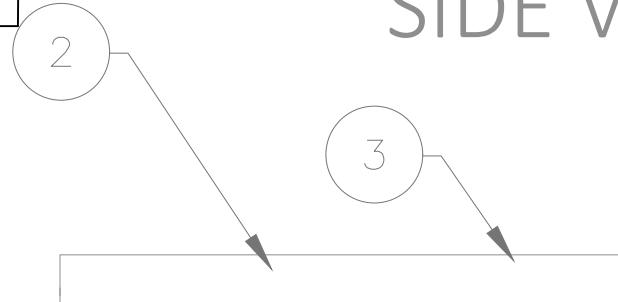

PLAN

P3	CM	Projecting sign altered	18.10.2022
P2	CM	Planning Issue	08.08.2022
P1	CM	Draft Issue	08.07.2022
Rev	Iss.	Description	Date

DRAWING TITLE

Hanging Sign Detail
As Proposed

PROJECT NAME
New Shop Front

ADDRESS
47 Goodge Street
London
W1T 2LD
CLIENT
Shaftesbury CL Ltd

DRAWN BY
CM

CHECKED BY
--

JOB NO.
25528

Queens House / 55-56 Lincoln's Inn Fields / LONDON WC2A 3JF
020 7391 7100 / www.fandt.com

SCALE
1:10@A3

DATE
Jul 2022

DRAWING NO.
A-204-P3

