



KEY/LEGEND:

-  EXISTING BUILDING
-  NEW CONSTRUCTION
-  BOUNDARY LINE

NOTE:

ALL GLAZING TO BE REPLACED WITH DARK GREY, DOUBLE GLAZED, CASEMENT GLAZING

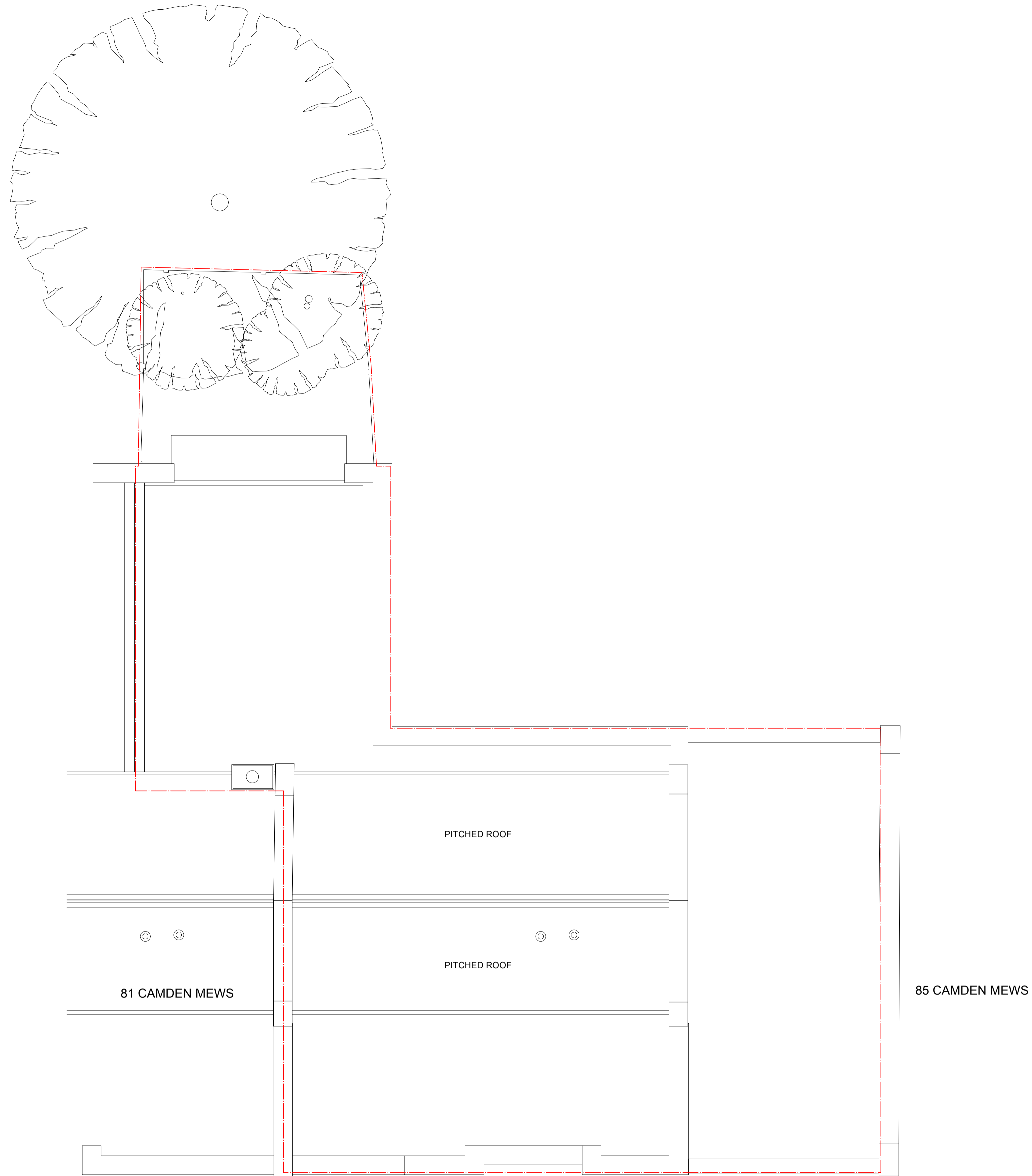

REV	DATE	ISSUER	COMMENTS
-	23/08/2022	MM	FIRST ISSUE

CLIENT:  
**CELINE ASSIMON**  
 PROJECT ADDRESS:  
**83 CAMDEN MEWS, NW1 9UB**  
 PROJECT CODE:  
**A101**  
 DRAWING NAME:  
**EXISTING ROOF PLAN**

DRAWING NO.: **PA1-A2-013**    REVISION: -    DATE: **AUG 2022**    DRAWN: **MM**    CHECKED: **JBB**

SCALE:  
**1:50 @ A1**

**StateStudio**

statestudiold.com  
 0203 637 2922  
 architecture@statestudiold.com  
 12 Crown Works  
 Temple Street  
 London E2 6QQ

DIMENSIONS:  
 Do not scale from these drawings. For accuracy, all dimensions and specifications must be confirmed at the site and with all relevant technical & manufacturer information.  
 Any discrepancy between drawings and dimensions on site are to be brought to the attention of StateStudio Ltd prior to any works being undertaken.  
 © STATESTUDIO LIMITED 2022  
 The design and drawings remain the property of StateStudio Ltd. The client for the project will be licensed to use this design and documents on this site only upon full payment of architectural fees. This license is non-transferable. The design and drawings shall not be reproduced, upgraded to the internet or traced without the permission of StateStudio Ltd.

**1** EXISTING ROOF PLAN  
 Scale: 1:50



CAMDEN MEWS