

SECTION BB

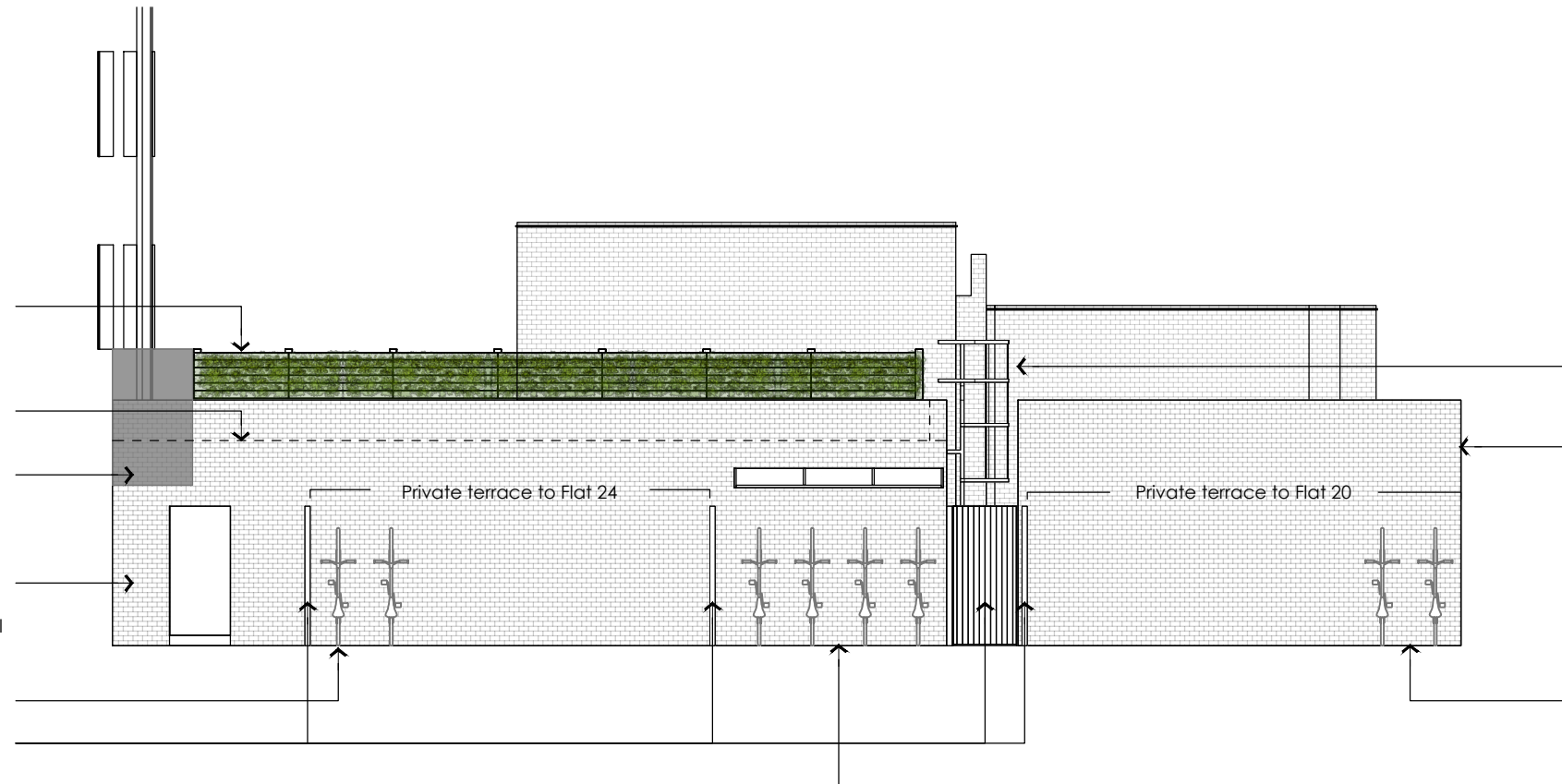

ELEVATION AA

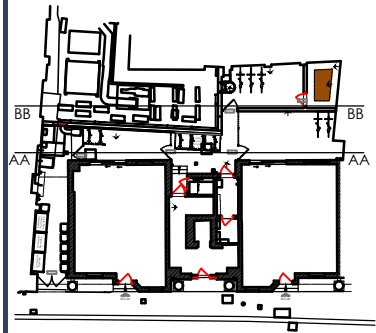
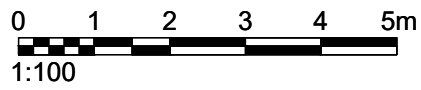

PL2 PLANNING ISSUE	21.10.22	TE
T1 TENDER ISSUE	02.09.22	TE
PL1 RE-ISSUE - PLANNING	14.07.22	TE
P2 PRELIMINARY ISSUE	05.07.22	TE
P1 PRELIMINARY ISSUE	24.06.22	TE

Rev	Revision	Date	By
NOTES			
All setting out dimensions and points will be found on the construction issue drawings			
All dimensions to be checked on site prior to commencement of works. Do not scale this drawing			

## PLANNING

PROJECT	
RUSPINI	
HOUSE	
TITLE	
PROPOSED REAR TERRACE	
ELEVATION AA & SECTION BB	
SCALE	1:100 @ A3
DATE	24.06.22
DRAWING NO	601/E/212
REVISION	PL2



**GRAVITY DESIGN**

Old Bank Court, Morocco Street, London SE1 3HB  
+44(0)20 7089 9134 studio@gravitydesign.uk.com