

Notes:

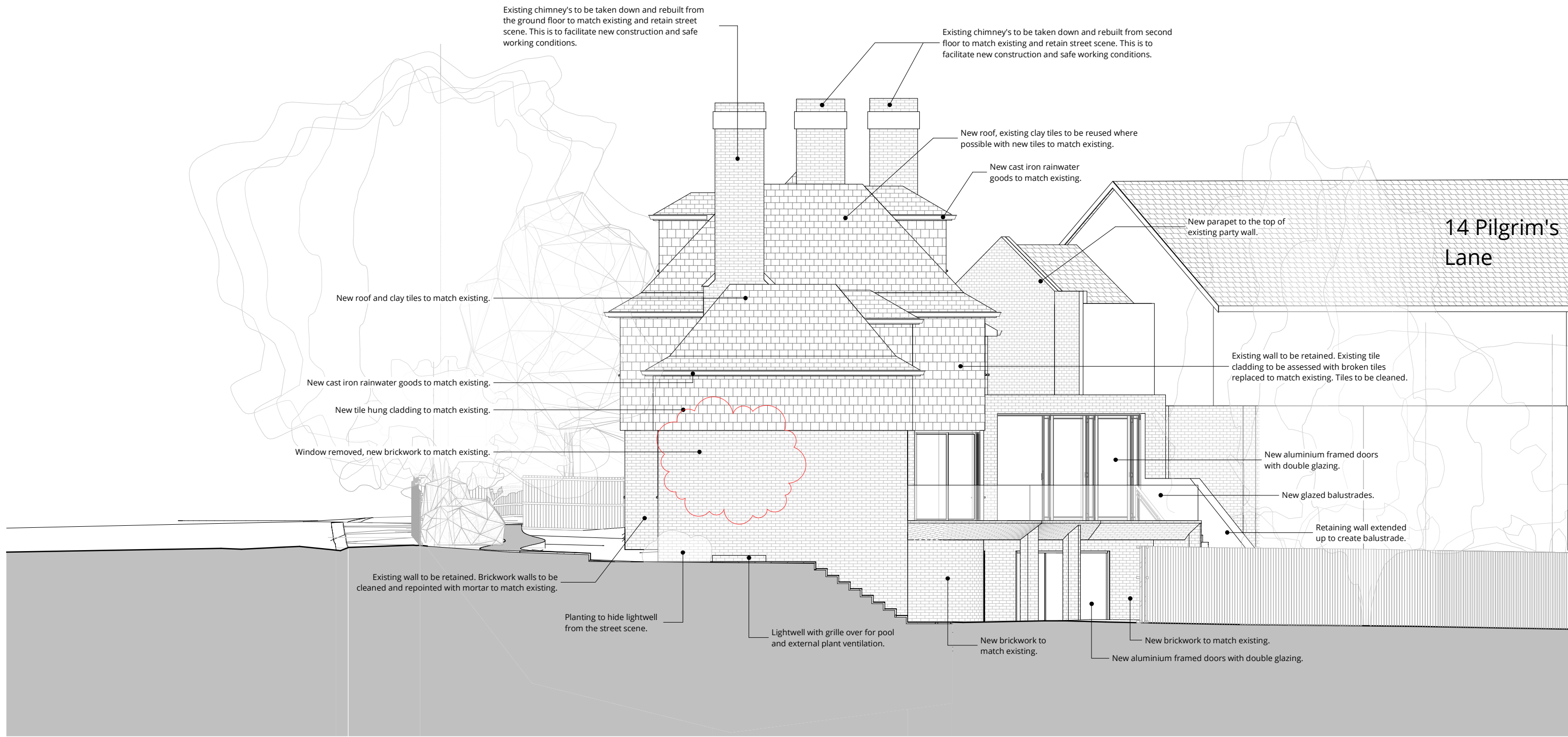

1 0 1 2 3 4 5
SCALE 1:100 m



East Elevation - Proposed
1 : 100



West Elevation - Proposed
1 : 100

| | | | | |
|-----|---|----------|-------|-----|
| C | Soft/Hard Landscaping & Window Updated | 07.11.22 | | |
| B | Obscure glazing added, Plant area & No.10 building updated. | 02.08.22 | | |
| A | Chimney notes updated | 13.07.22 | | |
| 0 | First Issue | 25.05.22 | | |
| Rev | Description | Date | Drawn | Ckd |



16 lambton place
notting hill
london w112sh
t 02072293125
f 02072293257
e info@wolffarchitects.co.uk

status:

PLANNING

project:
12 Pilgrim's Lane
Hampstead, London

drawing title:

Proposed Side Elevations

date: **01/25/22** scale: **1 : 100**

dwg no: **2160-PL-301** rev no: **C**