

# Camley Street S.à.r.l., 101 Camley Street, Camden

Planning Application: Life Safety Generator

28<sup>th</sup> October 2022



CAMLEY STREET SÀRL

HUTCHINSON & PARTNERS



Client

Architect / Public Realm Design /  
Landscape Design

Planning Consultant

Camley Street S.à.r.l.  
20 Rue de la Poste  
L-2346  
Luxembourg

Hutchinson & Partners Limited  
3.12 The Record Hall  
16-16A Baldwin's Gardens  
London  
EC1N 7RJ

hgh Consulting  
45 Welbeck Street,  
London  
W1G 8DZ

Document Control:

Revision	Date	Notes	Initial
-	02.09.2022	Issued for Information	LOG
01	15.09.2022	Issued for Planning	TW
02	18.10.2022	Issued for Planning	TW
03	28.10.2022	Issued for Planning	TW

# Content

01.00 Introduction	04
02.00 Design Development	06
03.00 Appendix	11

01.00

# Introduction

01.01 Overview

05



# 01.01 Overview



Existing Street View of Commercial Space frontage, North Block



Existing Street View of Commercial Space frontage, South Block

This document has been prepared by Hutchinson & Partners Limited to provide the London Borough of Camden with an overview of the proposed change to the 101 Camley Street development on behalf of Camley Street S.à.r.l.. The 101 Camley Street development was completed in 2021. Camley Street S.à.r.l. require the addition of a Life Safety

Emergency Generator at Roof Level on the North Block of the development to support the installation of sprinklers in the commercial spaces.



02.00

Design Development

02.01 Existing & Proposed Roof	07
02.02 Existing & Proposed Elevation	08
02.03 Verified View Comparison - View 01	09
02.04 Verified View Comparison - View 11	10

# 02.01 Existing & Proposed Roof

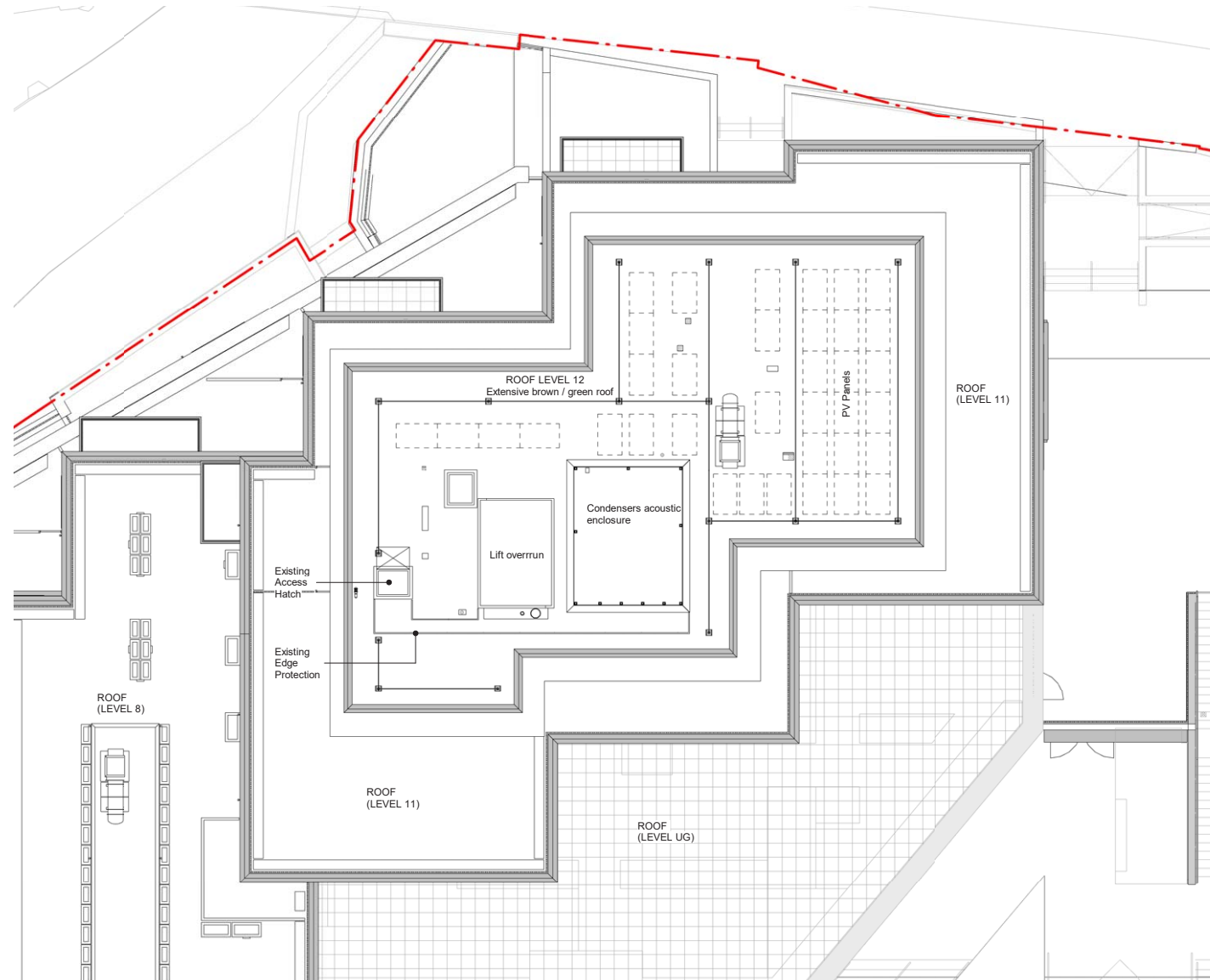

Existing Roof Plan

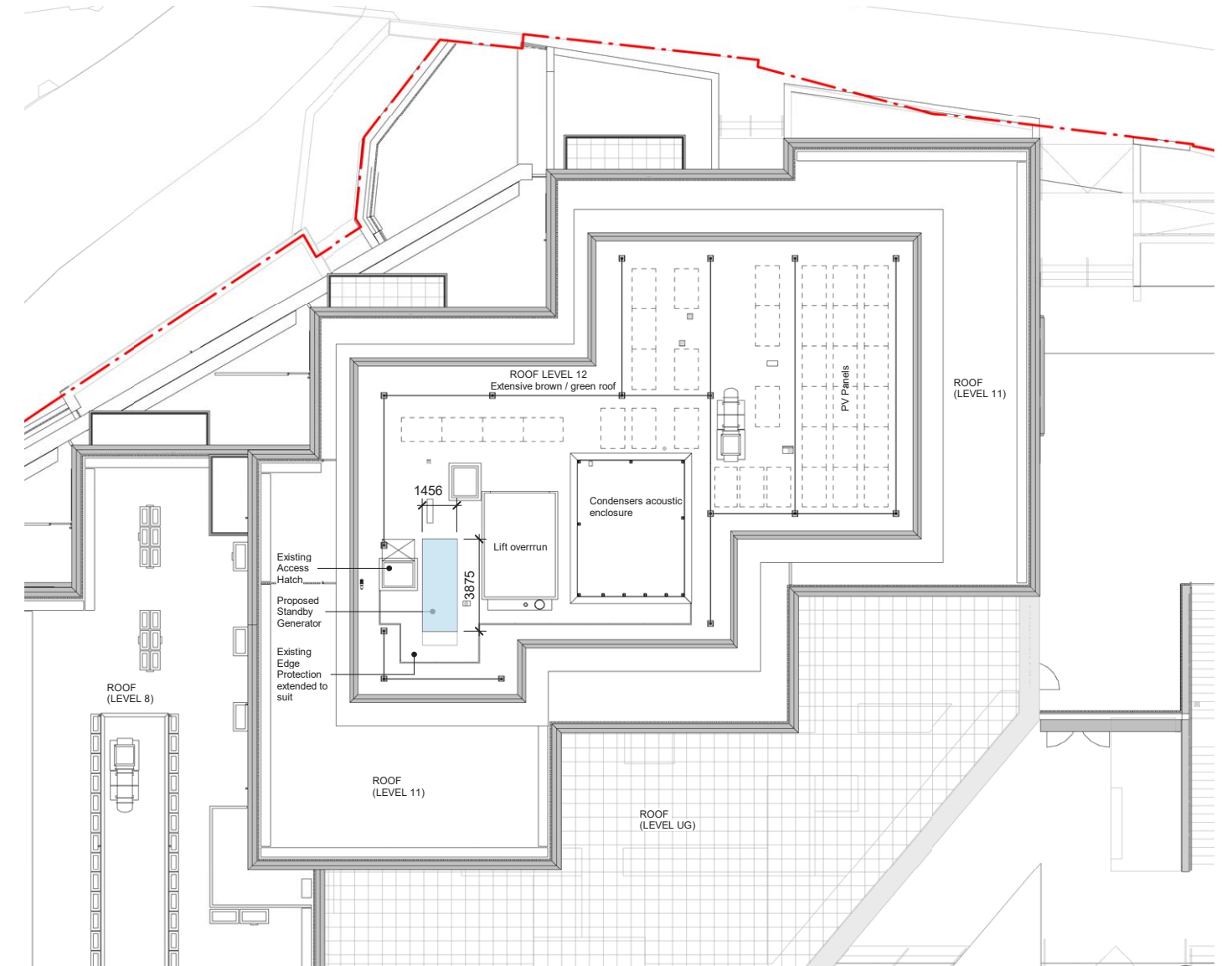

Proposed Roof Plan

The proposal is to install an additional Life Safety Emergency Generator at Roof Level on the North Block to support the installation of sprinklers within the commercial spaces at Basement, Lower Ground Floor and Upper Ground Floor. The proposed generator will be located between the existing lift overrun and roof access hatch, away from the perimeter of

the roof to minimise its visibility. Please refer to the plan above for the proposed location.

--- Site Boundary  
 Scope of Proposal

# 02.02 Existing & Proposed Elevation



Existing South West Elevation 1:250

The above drawings illustrate the addition of the generator on the South West Elevation of the North Block.



Proposed South West Elevation 1:250

■ Scope of Proposal



# 02.03 Verified View Comparison - View 01



01 Hutchinson & Partners S78 Application Amended view showing rooftop plant enclosures



02 Hutchinson & Partners Current Application Amended view showing rooftop plant enclosures & Generator

A selection of the verified views identified in the original consented application and previous S78 applications have been used to illustrate that the impact the generator will have from street level around the site will be minimal. The same view types have been used to illustrate this change as in the consented application. From long distance views

the generator will merge with the existing plant enclosures already located on the roof and will not materially alter the appearance of this element of the building.



# 02.04 Verified View Comparison - View 11



01 Hutchinson & Partners S78 Application Amended view showing rooftop plant enclosures



02 Hutchinson & Partners Current Application Amended view showing rooftop plant enclosures & Generator

As with the rooftop plant enclosures, from close in street views these are not visible due to the overhang of the penthouse eaves. The same is true for the proposed generator.

03.00

## Appendix



Amended Drawings

Drawing Number	Drawing Title	Scale @ A1	Revision	Issued Date
21061 01 AP 0000 001	Site Location Plan	1:500	P01	20/04/2022
21061 01 AP 0000 002	Block Plan	1:200	P01	20/04/2022
21061 01 AP 0010 017	Proposed GA Roof Level	1:200	P03	28/10/2022
21061 01 AP 0010 117	Existing GA Roof Level	1:200	P01	18/10/2022
21061 01 AP 0020 001	Existing GA NE Elevation	1:100	P01	02/09/2022
21061 01 AP 0020 002	Proposed GA NE Elevation	1:100	P03	28/10/2022
21061 N AP 0020 001	Existing North Block Envelope - SW Elevation	1:100	P02	02/09/2022
21061 N AP 0020 002	Proposed North Block Envelope - SW Elevation	1:100	P04	28/10/2022
21061 N AP 0020 003	Existing North Block Envelope - NW Elevation	1:100	P02	02/09/2022
21061 N AP 0020 004	Proposed North Block Envelope - NW Elevation	1:100	P04	28/10/2022
21061 N AP 0020 005	Existing North Block Envelope - SE Elevation	1:100	P02	02/09/2022
21061 N AP 0020 006	Proposed North Block Envelope - SE Elevation	1:100	P04	28/10/2022