

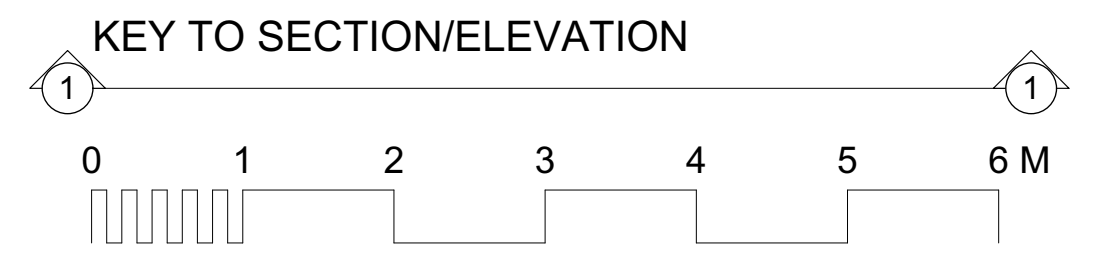

This drawing is the copyright of Axiom Architects. It is for planning application purposes only and may not be reproduced in whole or in part without permission. Drawings lodged for planning approval may be reproduced by the Planning Authority in accordance with the Copyright (Material Open to Public Inspection) (Marking of Copies of Plans and Drawings) Order 1990 and must carry the relevant copyright restriction note. Scaling from this drawing should only be carried out from a print at the scale and size specified within the title block. Responsibility for ensuring correct size reproduction remains with the reader.

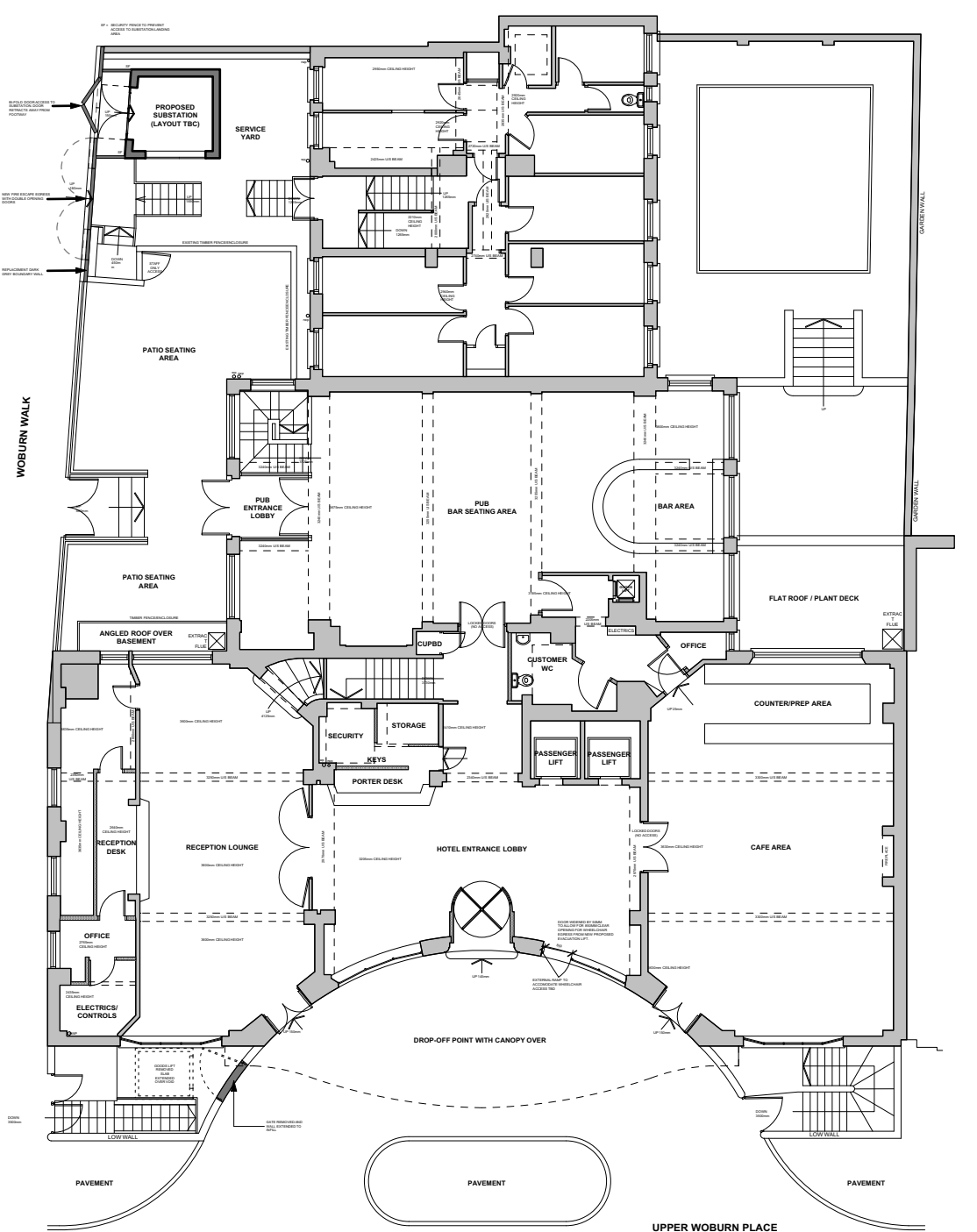

PROPOSED MATERIALS KEY:

- 1 BRICK
- 2 RC SLAB
- 3 RC ROOF WITH ASPHALT CLADDING
- 4 DARK GREY POWDER COATED METAL
- 5 DARK GREY POWDER-COATED LOUVRED VENT

A	22/07/22	Alterations to existing door intent removed	ad
Rev	Date	Description	By Chk



**AXIOM
ARCHITECTS**

1 Brooklands Yard Southover High Street Lewes East Sussex BN7 1HU
Tel. 01273 479434 www.axiomarchitects.co.uk

Client
Splendid Hospitality Group
Project
County Hotel 8-11 Upper Woburn Place London, WC1H 0JW
Drawing
Proposed GA SW Elevation Upper Woburn Place Elevation

Scale	Status	Date	Drawn	Checked
1:50	PLANNING	28/01/2022D	AB	AB
Drawing No.	Revision			

5235-PL-110 **A**