

Window Type	W-T01
Window Description	Triple glazed inward opening hardwood timber casement windows
Window Numbers	W-GF-01, W-GF-02, W-GF-03, W-GF-04, W-GF-05, W-GF-10, W-GF-11, W-1F-02, W-1F-04, W-1F-11, W-1F-12
Structural Opening	See drawing
Leaf Size	N/A
Finish	Hardwood timber painted black, clear lacquer seal
Ironmongery Set	Recessed Espagnolette Bolt and hidden stays
Glass Specification	1.6 W/(msq.K)

**Important note**

All dimensions in millimetres. Where dimensions are not given, drawings must not be scaled and the matter referred back to Charlton Brown Architects.

All dimensions and conditions are to be checked on site by the contractor prior to preparing drawings or commencing any work. The contractor is responsible for checking that there is no conflict between site dimensions and drawn dimensions.

In the event of any detail or dimensional conflict between Charlton Brown Architects drawings, the matter must be referred back to Charlton Brown Architects for clarification

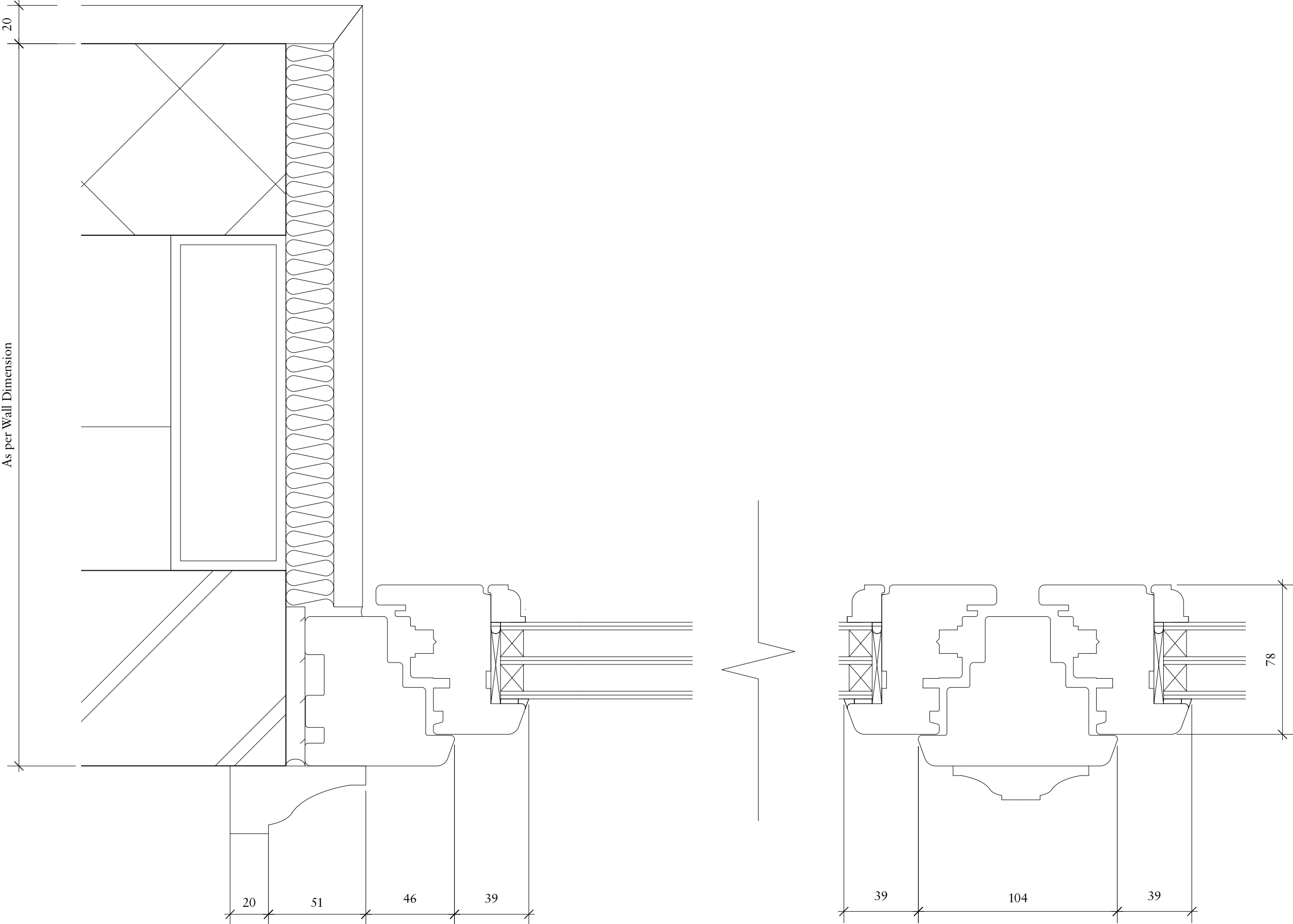

1 Detail 01 - Plan  
Scale: Half Actual Size

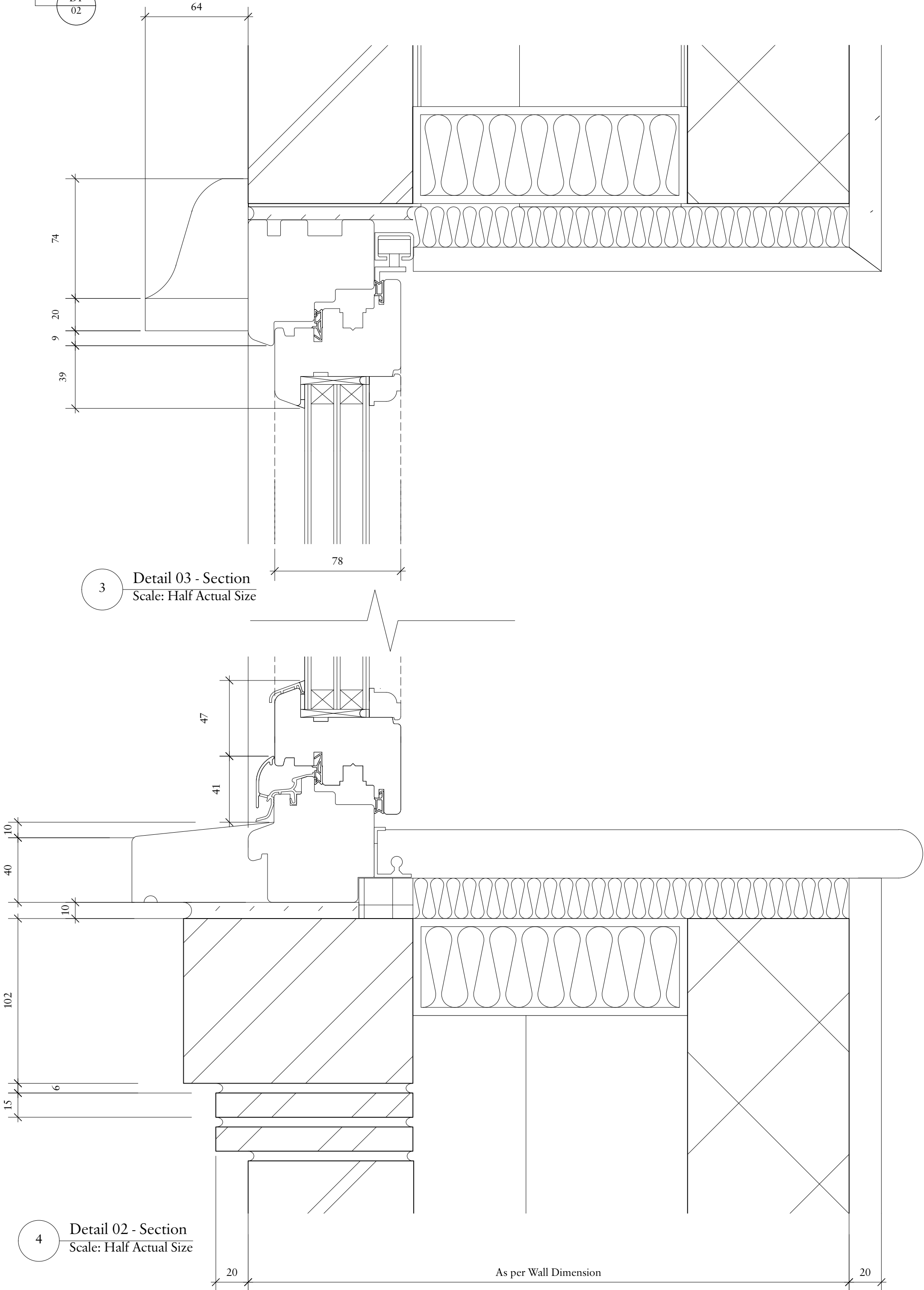

4 Detail 02 - Section  
Scale: Half Actual Size

Rev Date Details By

## Charlton Brown Architecture & Interiors

The Belvedere, 2 Back Lane, Hampstead, London, NW3 1HL  
Telephone +44(0)20 7794 1234  
Email office@charltonbrown.com  
Website www.charltonbrown.com

Client  
Mr Alex Begun

Project  
38 Froggnal Lane

Drawing Title  
Window Type 01 - Details 1:2

Date	Drawn	Checked
07/09/2022	AN	SC

Scale  
1:2, 1:20

Issue Status

**For Planning**

Project Number	Drawing Number	Revision
20022	T-31-110	