

EXISTING PHOTOS

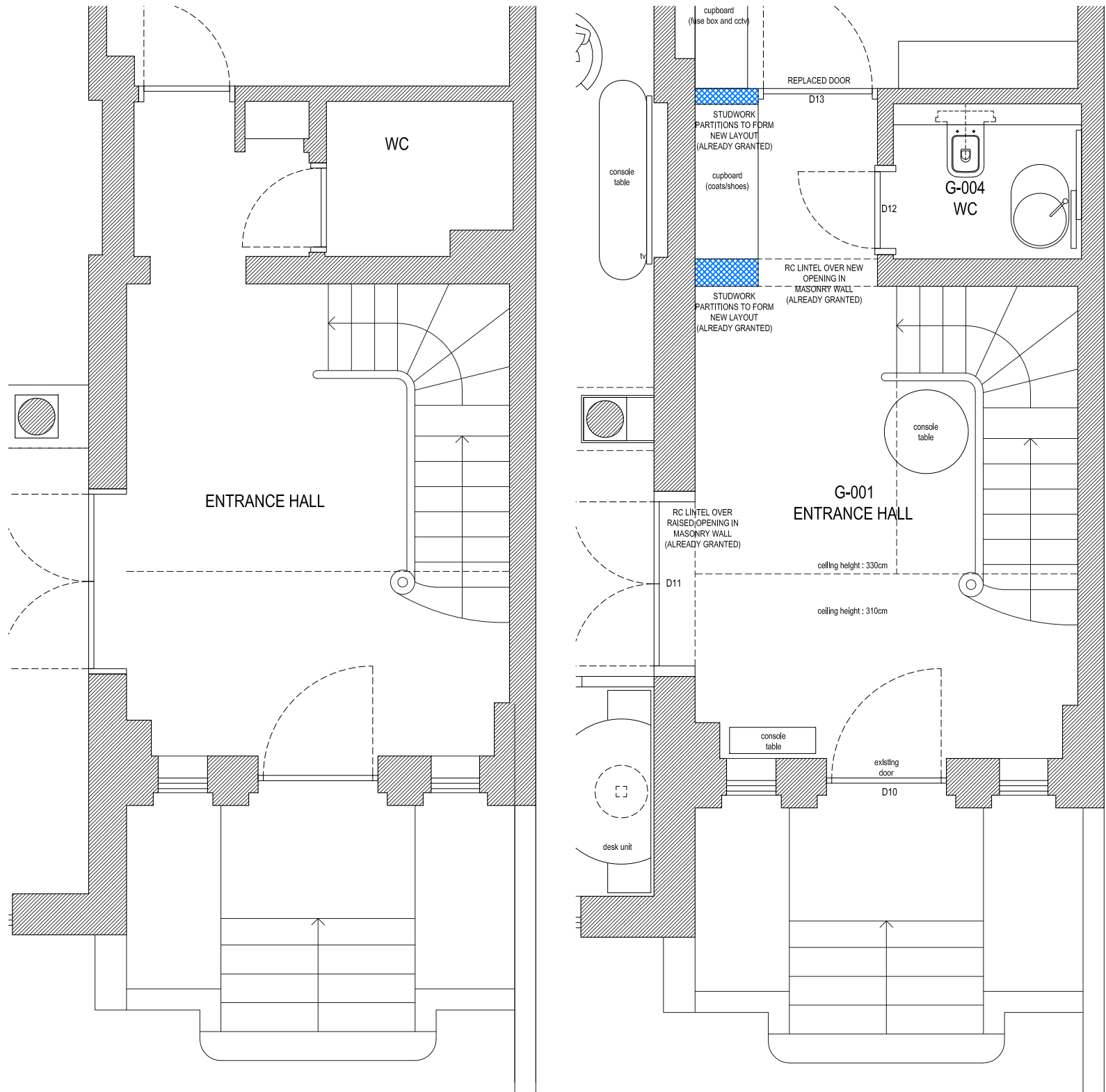

GROUND FLOOR
ENTRANCE HALL - EXISTING LAYOUT

GROUND FLOOR
ENTRANCE HALL - PROPOSED LAYOUT

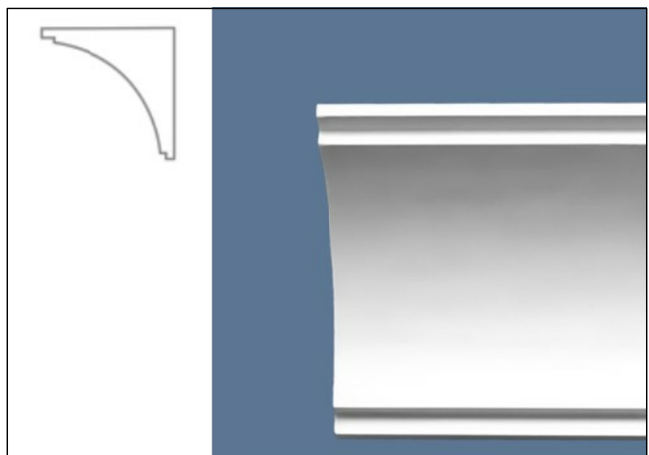

CORNICE TYPE B
London Fine Art Plaster CN2
Depth:150mm Projection:150mm



SKIRTING TYPE A
Height:300mm Depth:25mm

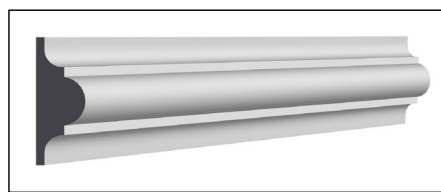

Moulding detail

marble flooring detail



PROPOSED DESIGN



NO.17 Door

PROPOSED ALTERATIONS

- New marble flooring
- Decorative moulding on the walls
- Repaint the entrance door exterior-interior sides as existing colours

GRANTED ALTERATIONS

- Underfloor heating
- Reform opening through the wc/cloak and Gym with arched opening and plasterwork
- New cupboard for coats
- Replace joinery skirtings
- Replace painted plaster cornices
- New painted, glazed timber door, painted frame and architraves to the Gym

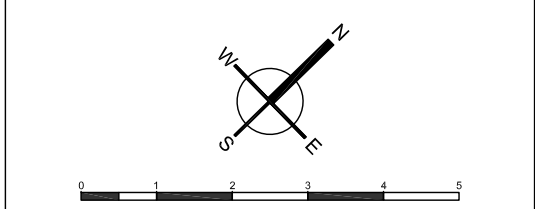

FILIZ CAPUR DESIGN LTD

Flat 1, Clarendon House,
23 Kew Gardens Road TW9 3HD
info@filizcapur.co.uk

JOB TITLE

17 Greville Place
London NW6 5JE

DRAWING TITLE

PROPOSED DESIGN
GF-ENTRANCE HALL

Scale	1/50 - A2
Date	10.10.2022
Issue	Listed Building Con.

Drawing No	GP-PL-010
------------	-----------